



## 12 Old Forest, Bunclody, Co Wexford

**Y21AT89**

Asking Price: €285,000



3



3



Sq m  
113.0

**BER C1**

DOUGLAS NEWMAN GOOD  
**DNG**  
O'CONNOR & O'CONNOR

## DESCRIPTION

Elegantly presented and in pristine, turn-key condition, 12 Old Forest is a beautifully maintained residence set within a highly sought-after private development.

This exquisite home impresses from the moment you step inside, with tasteful décor and a thoughtfully designed layout. Accommodation includes a welcoming entrance hallway, spacious living room, stylish kitchen and dining area, utility room, guest WC, three generously proportioned bedrooms, a luxurious ensuite, and a contemporary family bathroom.

Outside, the property is approached via a tarmacadam driveway offering off-street parking and a manicured front lawn. Gated side access leads to a private rear garden, thoughtfully laid out with a lawn, a charming patio area, raised decking—ideal for outdoor entertaining—and a durable Adman steel shed providing excellent storage solutions.

Crafted to the highest standards, this quality-built home features double-row concrete block construction, a nap plaster and red brick façade with PVC double-glazed windows and doors.

12 Old Forest is the ideal choice for those seeking timeless charm, modern comfort, and everyday convenience in an exclusive and peaceful setting.

## ACCOMMODATION

**Entrance Hallway:** 4.04m x 2.81m (13'3" x 9'3").

The bright and spacious entrance hallway features elegant porcelain cream floor tiles, which continue seamlessly into the kitchen, complemented by decorative coving for a refined finish.

**Living Room:** 6.06m x 3.51m (19'11" x 11'6").

The living room boasts solid wood flooring, an insert stove with a polished marble hearth, and a large bay window that floods the space with natural light. Decorative coving adds a touch of elegance, while double doors provide a seamless flow through to the kitchen and dining area.

**Kitchen/Dining Room** 3.26m x 4.83m (10'8" x 15'10").

The kitchen and dining area continue the elegant porcelain cream floor tiles from the hallway, enhancing the sense of space and flow. Featuring a classic shaker-style kitchen with sleek quartz countertops, the space is fully equipped with a built-in dishwasher, electric hob, oven, and extractor fan. Double doors open out to a raised decking area in the rear garden—perfect for alfresco dining—while a separate door leads to the adjoining utility room for added convenience.







**Utility Room:** 2.62m x 1.48m (8'7" x 4'10").

The utility room continues the porcelain cream floor tiles for a seamless transition from the kitchen. It is fitted with built-in storage units, matching quartz countertops, and is plumbed for a washing machine—offering a practical and well-organised workspace.

**WC:** 1.39m x 1.48m (4'7" x 4'10").

The guest WC continues the elegant porcelain cream floor tiles and is fitted with a WC and wash hand basin, providing a bright and functional space just off the hallway.

**Landing:** 2.55m x 2.81m (8'4" x 9'3").

The landing is bright and airy, finished with soft carpet flooring, creating a warm and comfortable transition to the upstairs accommodation.



**Bedroom 1:** 4.61m x 3.51m (15'1" x 11'6").

Tastefully decorated in neutral tones and features built-in wardrobes, cosy carpet flooring, and venetian blinds for added privacy. A door leads directly to the private ensuite bathroom.

**En-suite:** 1.87m x 1.74m (6'2" x 5'9").

The ensuite features tiled flooring and partially tiled walls, and is fitted with a corner electric shower, WC, and wash hand basin—combining practicality with a clean, modern finish.



**Bedroom 2:** 3.96m x 3.69m (13' x 12'1").

Featuring soft carpet flooring, venetian blinds, and built-in wardrobes. A rear-facing window offers lovely views over the surrounding countryside, creating a peaceful and private retreat.

**Bedroom 3:** 4.11m x 2.64m (13'6" x 8'8").

Bedroom 3 is finished with carpet flooring and features a rear-facing window fitted with a venetian blind, offering a quiet and comfortable space ideal as a bedroom, home office, or nursery.



**Bathroom:** 2.88m x 2.81m (9'5" x 9'3").

The main bathroom is fully tiled in a neutral finish and fitted with a bath, wash hand basin, and WC. A window with a venetian blind provides natural light and ventilation, completing this clean and stylish space.

**BER DETAILS**

BER: C1

BER No:

Energy Performance Indicator: kWh/m2/yr

**ASKING PRICE**

Asking Price: €285,000

## Ground Floor

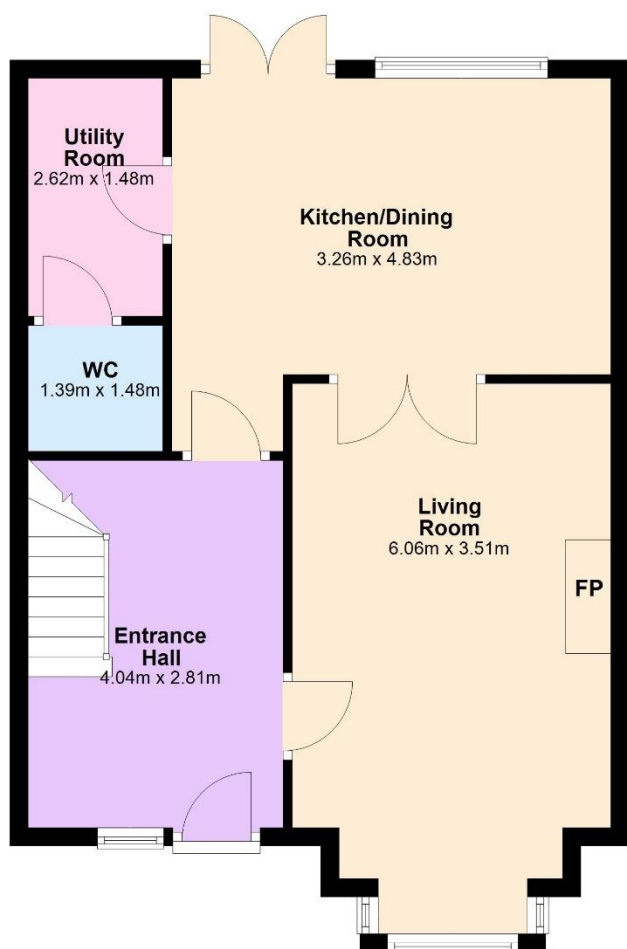

## First Floor

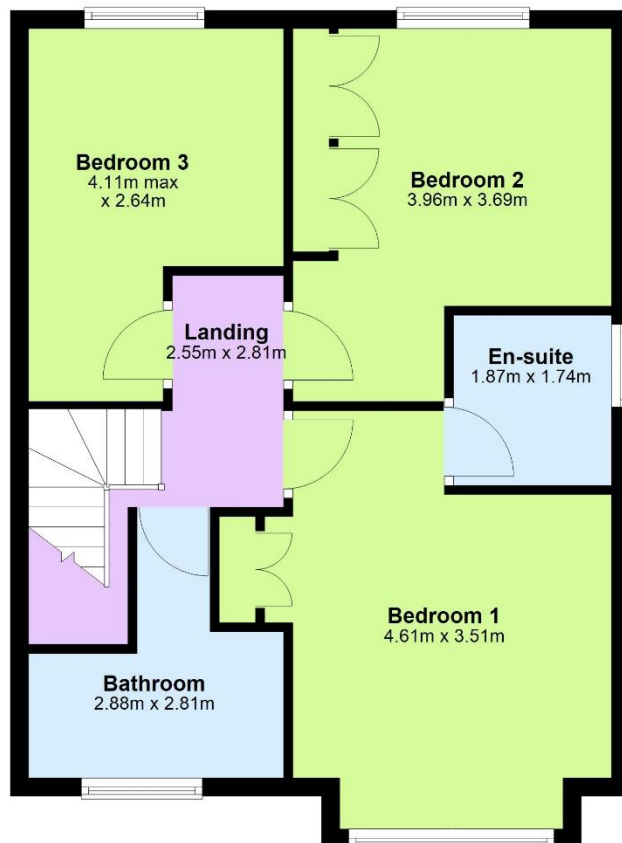

Total area: approx. 109.4 sq. metres

## FURTHER INFORMATION/VIEWING

By appointment with the sole selling agent DNG O'Connor & O'Connor.

For further information please contact:

Michelle Conroy

053 93 77147

info@dngoconnorandococonnor.ie



PSL No. 004577

DNG O'Connor and O'Connor for themselves and for the vendors or lessors of the property whose Agents they are, give notice that: (i) The particulars are set out as a general outline for the guidance of intending purchasers or lessees, and do not constitute part of, an offer or contract. (ii) Any intending purchasers or tenants must not rely the descriptions, dimensions, references to condition nor necessary permissions for use and occupation as statements or representations of fact but must satisfy themselves by inspection or otherwise as to the correctness of each of them. (iii) No person in the employment of DNG O'Connor and O'Connor has any authority to make or give representation or warranty whatsoever in relation to this development. DNG O'Connor and O'Connor accept no liability (including liability to any prospective purchaser or lessee by reason of negligence or negligent misstatement) for loss or damage caused by any statements, opinions, information or other matters (expressed or implied) arising out of, contained in or derived from, or for any omissions from this brochure.