

Land Registry Compliant Map



559471

folio
S1813 F
low by low

MAP SHEETS

1:1000
6380-20 6380-25



Produced by National Map Service,
Unit 7, South Ring Business Park,
Keshale Road,
Co. Cork
On behalf of Ordnance Survey Ireland,
Phoenix Park, Dublin 8.
Sua sonraid a bhfuil na h-ainmneacha a bhfuil
Siad a bhfuil na h-ainmneacha a bhfuil
Rialas na h-Éireann
Úsáid a bhfuil na h-ainmneacha a bhfuil
Survey Report and Government of Ireland
copyright

Each aerial photograph, if available, has been
aerophotogrammetrically corrected, a description in
a brochure is available on request or from the Ordnance
Survey website. No part of this publication may
be copied, reproduced or transmitted in any form
or by any means without the prior written
permission of the copyright owner.

OSI
Ordnance Survey Ireland, 7011

570576

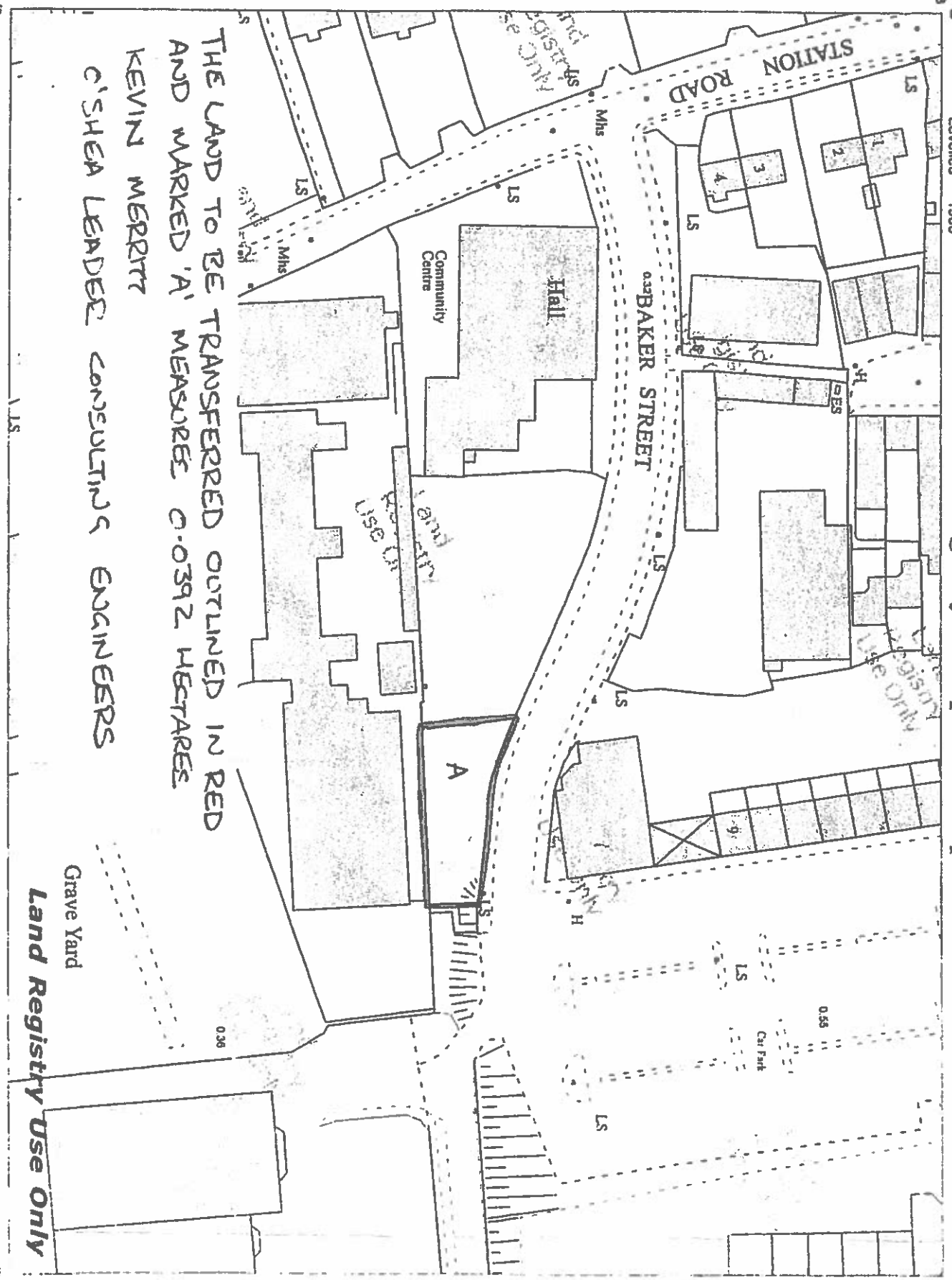

THE LAND TO BE TRANSFERRED OUTLINED IN RED
AND MARKED 'A' MEASURES 0.0392 HECTARES
KEVIN MERRITT
O'SHEA LEADER CONSULTING ENGINEERS

Scale:- 1:1,000
Scale:- 1:1,000

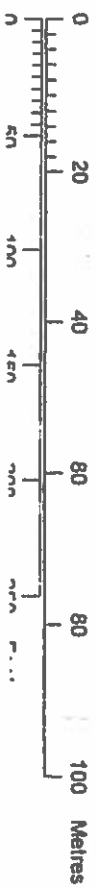

Plot Ref No. 25289561_1_1
Plot Date 21-JUL-2016

Land Registry Use Only