



42 Ryland Wood, Bunclody, Co Wexford

Y21F436

Asking Price: €295,000



DESCRIPTION

Nestled within the prestigious confines of a highly coveted development, this charming 4-bedroom bungalow with integrated garage commands a prime location, within effortless walking distance of a plethora of amenities.

Perched atop an elevated vantage point, it offers unrivalled panoramic views of the surrounding countryside, providing a serene escape amidst the vibrant pulse of community life.

Residents of this idyllic abode enjoy unparalleled convenience, with a championship golf course a mere stroll away, catering to the leisurely pursuits of golf enthusiasts. Sporting aficionados will delight in the proximity to a comprehensive array of sporting facilities in the area, including gyms, tennis courts, soccer and GAA facilities to name but a few.

Approaching the property, one is greeted by meticulously landscaped gardens, adorned with a rich tapestry of mature shrubbery, adding a splash of vibrant colours throughout the seasons. The exterior facade exudes a timeless maintenance free elegance, complemented by its pristine condition, promising a warm welcome to residents and guests alike.

In essence, this exceptional property is the epitome of modern living, offering a rare opportunity to embrace the best of both worlds - the tranquillity of countryside living and the convenience of urban amenities. With its enviable location, exquisite surroundings, and thoughtful design, it stands as a testament to refined living at its finest.

ACCOMMODATION

Entrance Hallway 8.89m x 2.63m (29'2" x 8'8").

Living Room 6.31m x 4m (20'8" x 13'1").

Kitchen/Dining Room 6.96m x 4m (22'10" x 13'1").

Utility Room 2.10m x 3.13m (6'11" x 10'3").

Bedroom 1 4.26m x 3.13m (14' x 10'3").

Ensuite 1.49m x 2.03m (4'11" x 6'8").

Bedroom 2 2.52m x 3.26m (8'3" x 10'8").





Family Bathroom 1.83m x 3.28m (6' x 10'9").

Bedroom 3 2.99m x 3.28m (9'10" x 10'9").

Bedroom 4 3.49m x 2.26m (11'5" x 7'5").

Garage 3.93m x 3.13m (12'11" x 10'3").

Store Room 1.14m x 3.13m (3'9" x 10'3").



KEY FEATURES

- Scenic Location
- Very Popular Area
- Excellent Decorative Order
- Garage & Storage Room
- Walking distance to all amenities

SERVICES

- Mains Water,
- Mains Sewerage
- OFCH



BER DETAILS

BER: C2

BER No: 117301374

Energy Performance Indicator: 189.57 kWh/m²/yr

Take a walk through this beautiful home: <https://vimeo.com/940602650/aec964e460>

Ground Floor

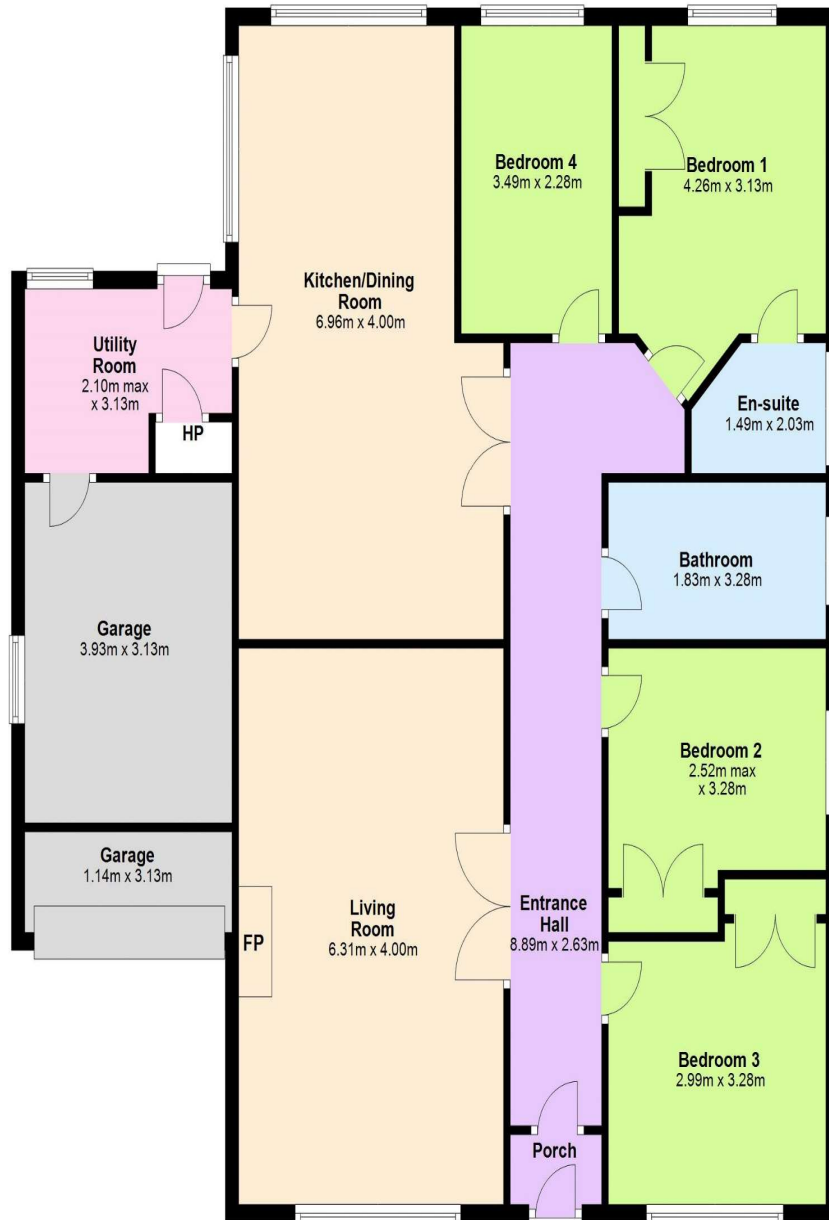

Total area: approx. 125.0 sq. metres

FURTHER INFORMATION/VIEWING

By appointment with the sole selling agent DNG O'Connor & O'Connor. For further information please contact:

Barty O'Connor
053 93 77147
info@dngoconnorandconnor.ie



PSL No. 004577

DNG O'Connor and O'Connor for themselves and for the vendors or lessors of the property whose Agents they are, give notice that: (i) The particulars are set out as a general outline for the guidance of intending purchasers or lessees, and do not constitute part of, an offer or contract. (ii) Any intending purchasers or tenants must not rely the descriptions, dimensions, references to condition nor necessary permissions for use and occupation as statements or representations of fact but must satisfy themselves by inspection or otherwise as to the correctness of each of them. (iii) No person in the employment of DNG O'Connor and O'Connor has any authority to make or give representation or warranty whatsoever in relation to this development. DNG O'Connor and O'Connor accept no liability (including liability to any prospective purchaser or lessee by reason of negligence or negligent misstatement) for loss or damage caused by any statements, opinions, information or other matters (expressed or implied) arising out of, contained in or derived from, or for any omissions from this brochure.