

# For Sale

Asking Price: €75,000

**RAINEY**  
ESTATE AGENTS



0.32 Ha (0.78 Acre) Crevary Lower,  
Rathmullan, Co Donegal

Superb site with stunning water views



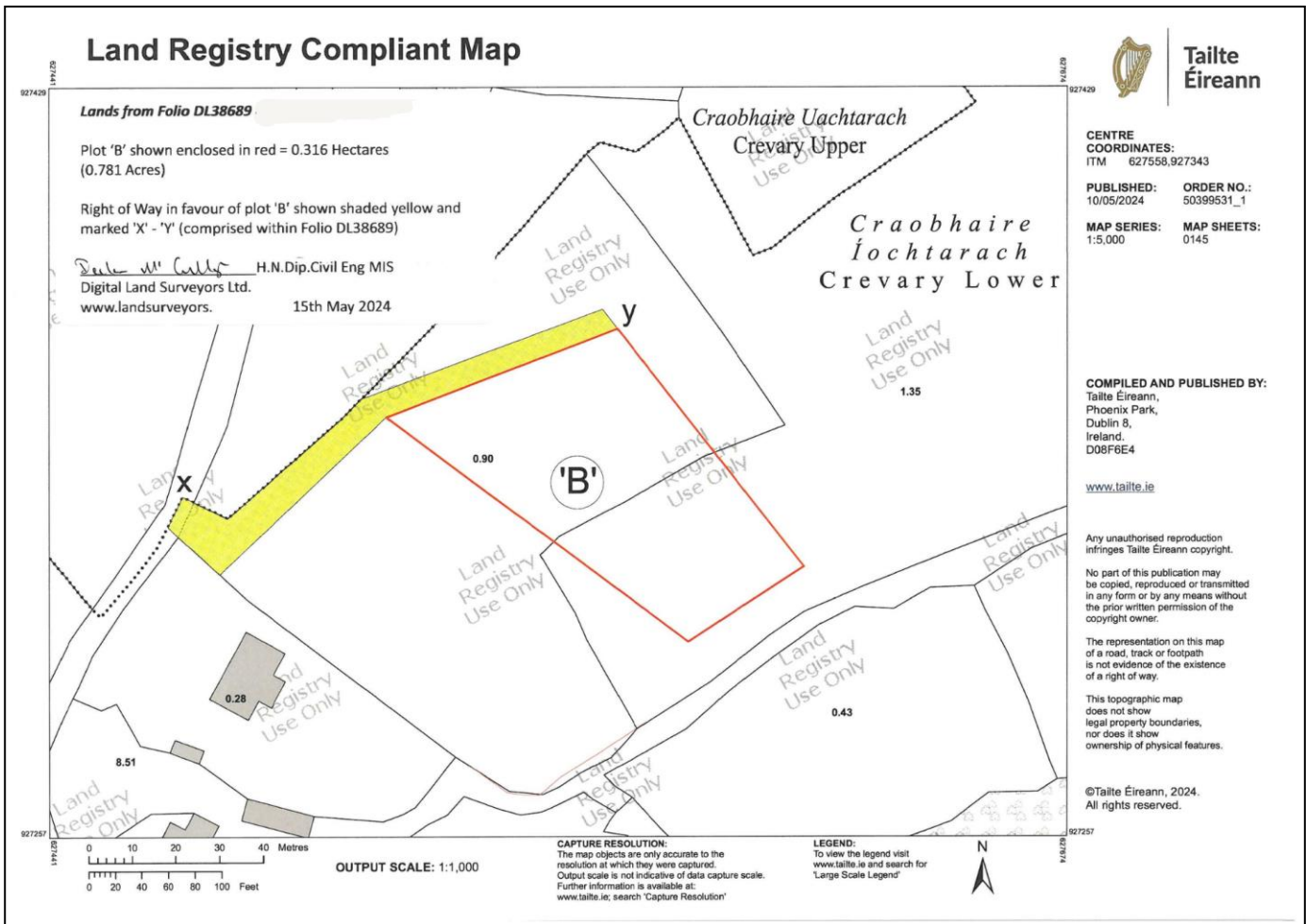

## Description

Opportunity to acquire a prime residential site with exceptional views in Crevary Lower, Rathmullan. This 0.32 Ha (0.78 Acre) site boasts panoramic views of Lough Swilly, stretching towards Bunrana and Rathmullan Village. Situated within a desirable townland, this property offers a tranquil escape while remaining conveniently close to amenities and facilities within Rathmullan.

Subject to planning permission, this site presents a promising opportunity for the development of a stunning residence.

## Key Features:

- 0.32 Hectare (0.78 Acre) site with expansive Lough Swilly views.
- Serene setting in Crevary Lower, County Donegal.
- Convenient location just a five-minute drive from Rathmullan Village.
- Subject to planning permission, offering development potential.

This exceptional residential site provides a rare opportunity to create a dream home amidst stunning surroundings. With its captivating views, tranquil setting, and proximity to amenities, this property is an ideal choice for discerning buyers seeking a haven of tranquillity and convenience.



### NEGOTIATOR

Kiara Rainey  
Rainey Estate Agents  
45 Port Road, Letterkenny,  
Co Donegal, F92 X863  
T: 074 912 2211  
E: [property@raineyproperty.ie](mailto:property@raineyproperty.ie)

### SOLICITOR

Mr Seamus Gunn  
McCloughan Gunn and Co.  
High Road  
Letterkenny  
Co. Donegal  
T: 0749125125  
E: [office@mcglk.ie](mailto:office@mcglk.ie)

### VIEWING DETAILS

Please contact us to make an appointment. Our Office is open Monday to Friday 9am to 5:30 pm. Viewings outside of these hours and Saturdays by appointment.

**CONDITIONS TO BE NOTED:** A full copy of our general brochure conditions can be requested from our office. We recommend that you familiarise yourself with these general conditions. While care has been taken to ensure that information contained in our publications is correct at the time of publication, changes in circumstances after the time of publication may affect on the accuracy of this.

Ordnance Survey Ireland Licence No. CYAL 50293602.

PSRA Registration No. 004598