

Generous two bedroom apartment in
a central location.

52 Hibernia Building, Heuston South Quarter, St John's Road, D08 ED82



Generous two bedroom apartment in
a central location.

52 Hibernia Building, Heuston South Quarter, St John's Road, D08 ED82



Generous two bedroom apartment in a central location.

52 Hibernia Building, Heuston South Quarter, St John's Road, D08 ED82



About this property

Apartment 52 is a generously sized and elegantly designed two-bedroom residence, set within the highly sought-after Heuston South Quarter located on the door step of Dublin city centre. Heuston South Quarter offers the perfect blend of city convenience and modern comfort. Residents enjoy beautifully landscaped communal spaces and a strong sense of community.

The bright and modern open-plan living, dining, and kitchen area seamlessly connects to a private balcony, offering sweeping views of the vibrant urban surroundings. Floor-to-ceiling windows flood the space with natural light, making it perfect for both everyday living and entertaining.

Both double bedrooms are spacious and flooded with light through floor to ceiling windows. The bedrooms offer ample storage with bespoke built in wardrobes. The bedrooms both enjoy ensuite bathrooms.



Generous two bedroom apartment in
a central location.

52 Hibernia Building, Heuston South Quarter, St John's Road, D08 ED82



Generous two bedroom apartment in a central location.

52 Hibernia Building, Heuston South Quarter, St John's Road, D08 ED82



Plans

 76 sqm

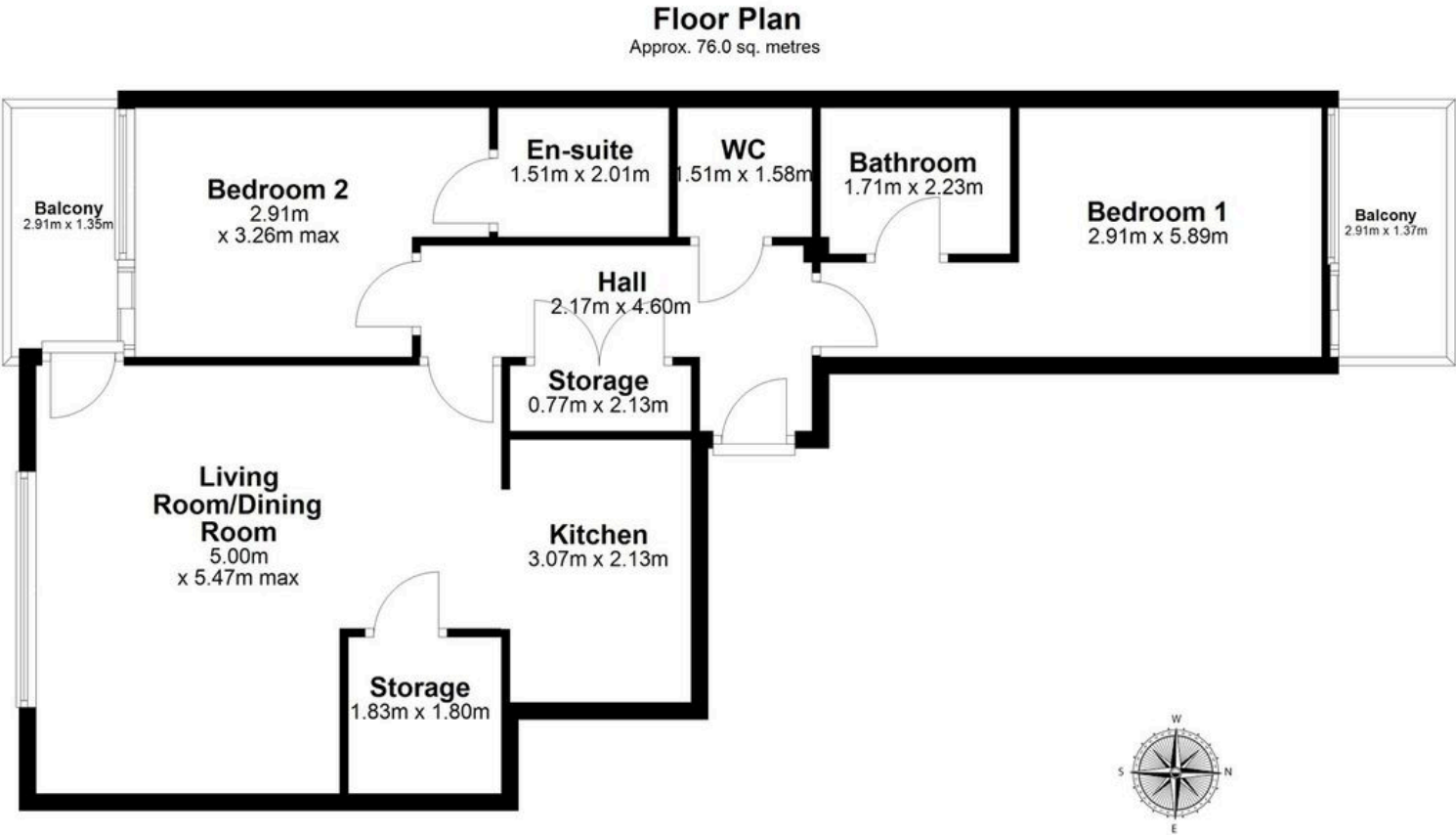

Total area: approx. 76.0 sq. metres
52 The Hibernian HSO Dublin 8

Generous two bedroom apartment in
a central location.

52 Hibernia Building, Heuston South Quarter, St John's Road, D08 ED82

savills



Local Area

Heuston South Quarter, located in Dublin 8, is a historic and culturally rich area just south of the River Liffey and west of Dublin's city centre. The area is well-served by public transport being located minutes away from Heuston Station which is serviced by National Rail, Luas, Dublin Bus and the Dublin Express to Dublin Airport.



Generous two bedroom apartment in a central location.

52 Hibernia Building, Heuston South Quarter, St John's Road, D08 ED82



Property Details

Key Features

Located on the second floor
Walking distance of Phoenix Park
Located minutes away from Heuston Station which is serviced by National Rail, Luas, Dublin Bus and the Dublin Express to Dublin Airport.
A secure underground car parking space is included

Services & Additional Information

HSQ offers a range of onsite amenities and security features, including Supervalu, Insomnia, HQQ cafe, a pharmacy, a 24- hour high-spec gym, Safari childcare, controlled fob access, 24-hour security, lifts, and CCTV surveillance. In addition, there is an on-site concierge which ensures that the development is well-maintained, providing a high level of service to all.

BER

BER Rating = B3

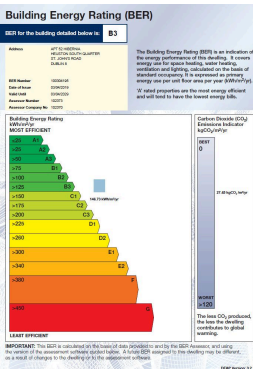

Generous two bedroom apartment in
a central location.

52 Hibernia Building, Heuston South Quarter, St John's Road, D08 ED82



Enquire



Harry Angel

Dublin - Country
+ 353 (0) 1 618 1712
harry.angel@savills.ie



Rose Lyle

Dublin - Country
+ 353 (0) 1 618 1300
harry.angel@savills.ie

More Information



[View on website](#)



[View Digital Brochure](#)



[Property Search](#)

Viewing strictly by appointment

Property Ref: DUY250216

Residential & Country

33 Molesworth Street, D02 CP04
+353 (0) 1 618 1300



Important Notice: Savills, its clients and any joint agents give notice that 1: They are not authorised to make or give any representations or warranties in relation to the property either here or elsewhere, either on their own behalf or on behalf of their client or otherwise. They assume no responsibility for any statement that may be made in these particulars. These particulars do not form part of any offer or contract and must not be relied upon as statements or representations of fact. 2: Any areas, measurements or distances are approximate. The text, photographs and plans are for guidance only and are not necessarily comprehensive. It should not be assumed that the property has all necessary planning, building regulation or other consents and Savills have not tested any services, equipment or facilities. Purchasers must satisfy themselves by inspection or otherwise. *powered by* **FluoPro**