

BEAUTIFUL DETACHED HOME WITH SUNNY WEST FACING REAR GARDEN

11 Manor Close, Thornbury Heights, Rochestown, T12F97C

savills



BEAUTIFUL DETACHED HOME WITH SUNNY WEST FACING REAR GARDEN

11 Manor Close, Thornbury Heights, Rochestown, T12F97C

savills



BEAUTIFUL DETACHED HOME WITH SUNNY WEST FACING REAR GARDEN

11 Manor Close, Thornbury Heights, Rochestown, T12F97C



About this property

Nestled in the highly sought-after and family-friendly development of Thornbury Heights, this impressive four-bedroom detached residence at No. 11 Manor Close offers a rare opportunity to acquire a beautifully upgraded home in one of Rochestown's most desirable locations.

Accommodation extends to approx. 146 sq.m (1,572 sq.ft.) and offers great flexibility to suit modern family living with options for a home office, several reception rooms, four well appointed bedrooms (one en-suite), kitchen, utility room and main bathroom.

Presented in excellent condition throughout, the property has undergone a series of recent enhancements, making it truly walk-in ready. The spacious interior features newly laid wooden floors and stylish tiling that lend a modern and cohesive feel throughout. The bathrooms have been tastefully upgraded with contemporary fittings, including a jacuzzi style bath, offering a sleek and refreshed look.

Energy efficiency has also been a key focus, with significant improvements including upgraded radiators and the addition of attic insulation—enhancing the home's BER rating and overall comfort.

Set on a generous corner site with a large cobblelock driveway offering ample off street parking for several cars, the same cobblelock continues to the rear garden patio where you will also find a lawn and planting area along with mature trees and hedging that offer great privacy to the rear.

Located just minutes from Douglas Village and with easy access to Cork City Centre, this property combines suburban tranquility with urban convenience.

BEAUTIFUL DETACHED HOME WITH SUNNY WEST FACING REAR GARDEN

11 Manor Close, Thornbury Heights, Rochestown, T12F97C



BEAUTIFUL DETACHED HOME WITH SUNNY WEST FACING REAR GARDEN

11 Manor Close, Thornbury Heights, Rochestown, T12F97C



Plans



Approx. 146 sq m /
1,572 sq ft

1ST FLOOR



2ND FLOOR

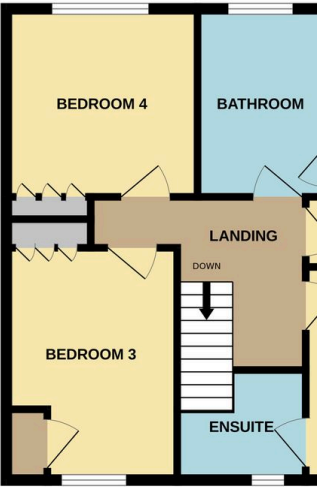

BEAUTIFUL DETACHED HOME WITH SUNNY WEST FACING REAR GARDEN

11 Manor Close, Thornbury Heights, Rochestown, T12F97C

savills

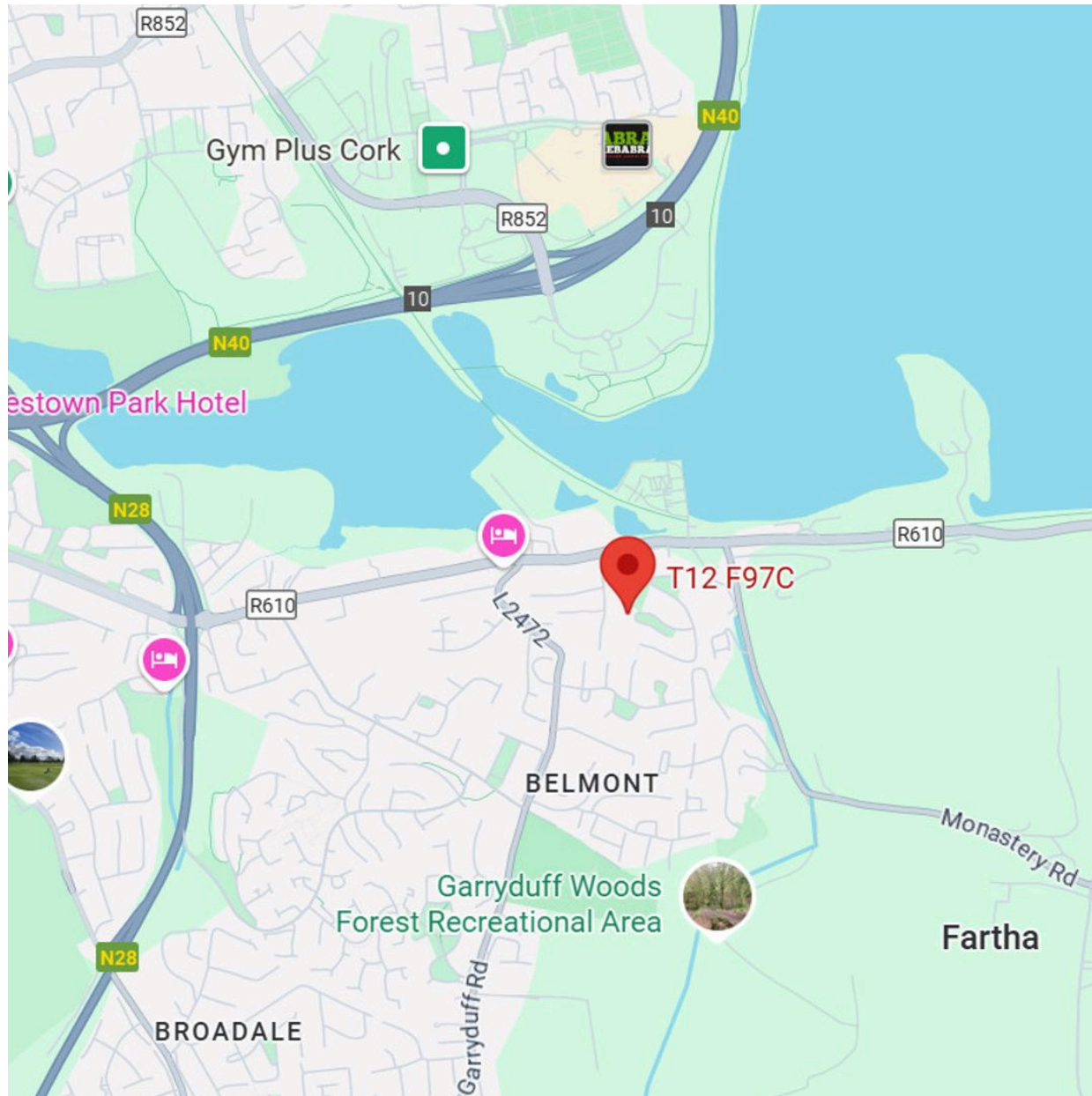

Local Area

Bus Stop - 650m
Rochestown Park Hotel - 2.7km
Fingerpost Roundabout - 3km
Mahon Point Shopping Centre - 4.5km
Cork City - 9km
Ringaskiddy - 9.8km
UCC - 10km
CUH - 10km

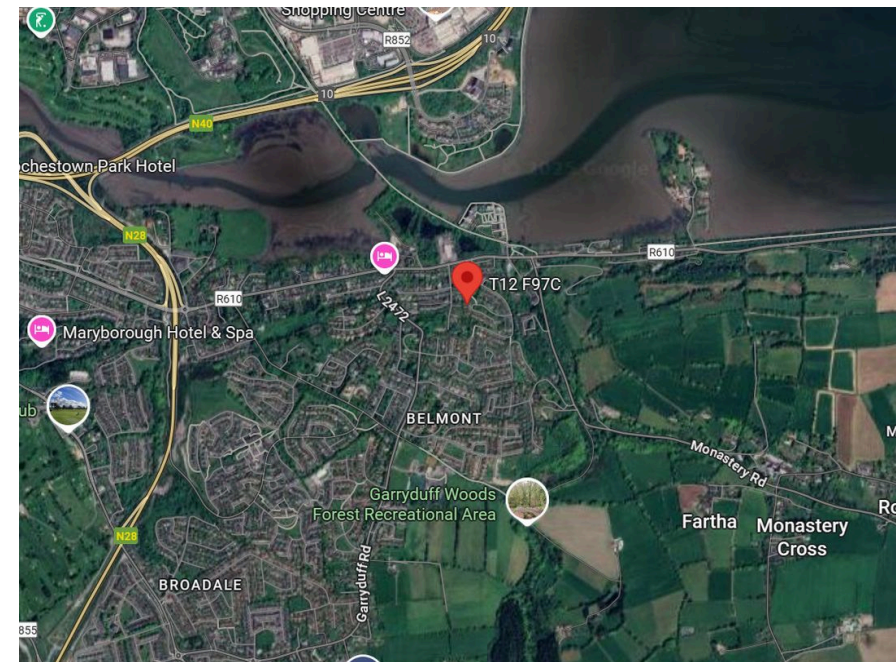

BEAUTIFUL DETACHED HOME WITH SUNNY WEST FACING REAR GARDEN

11 Manor Close, Thornbury Heights, Rochestown, T12F97C



Property Details

Key Features

- Beautifully presented four bedroom detached home
- Approx. 146 sq. m / 1,572 sq. ft.
- Fantastic views overlooking Cork city
- Lovely west facing rear garden
- Cobble block drive with ample parking
- Great selection of appliances
- Close proximity to Douglas Village

Services & Additional Information

- Mains Services
- GFCH
- High Speed Fibre Broadband
- Solid Fuel Stove
- Ample Wardrobe Space
- Timber Shed

BER

BER Rating = C1

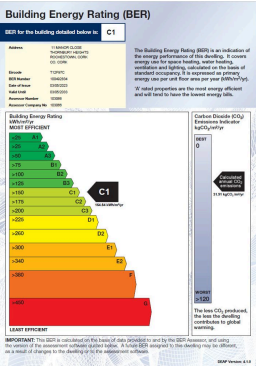

BEAUTIFUL DETACHED HOME WITH SUNNY WEST FACING REAR GARDEN

11 Manor Close, Thornbury Heights, Rochestown, T12F97C



Enquire



Lawrence Sweeney
Cork
+353 (0) 83 116 7163
lawrence.sweeney@savills.ie

More Information



[View on website](#)



[View Digital Brochure](#)



[Property Search](#)

Viewing strictly by appointment

Property Ref: CKK250493

Cork

Penrose House, Penrose Dock, T23 V38E
+353 (0) 21 427 1371



Important Notice: Savills, its clients and any joint agents give notice that 1: They are not authorised to make or give any representations or warranties in relation to the property either here or elsewhere, either on their own behalf or on behalf of their client or otherwise. They assume no responsibility for any statement that may be made in these particulars. These particulars do not form part of any offer or contract and must not be relied upon as statements or representations of fact. 2: Any areas, measurements or distances are approximate. The text, photographs and plans are for guidance only and are not necessarily comprehensive. It should not be assumed that the property has all necessary planning, building regulation or other consents and Savills have not tested any services, equipment or facilities. Purchasers must satisfy themselves by inspection or otherwise. *powered by* **FluoPro**