

RECEIVED 05/05/2025

(1) the construction of a two storey 2 bedroom pitched roof dwelling within the side garden of the existing house with ground floor flat roof front projection

(3) New pedestrian entrance of the public footpath

(2) New vehicular entrance of the public road to provide off road parking and amendments to the existing vehicular access to no 1



outline of as built new dwelling house as per planning ref FW20A/0204 located within the side garden of no 26 Saint Brigids Park, Dublin 15, D15 RKV1

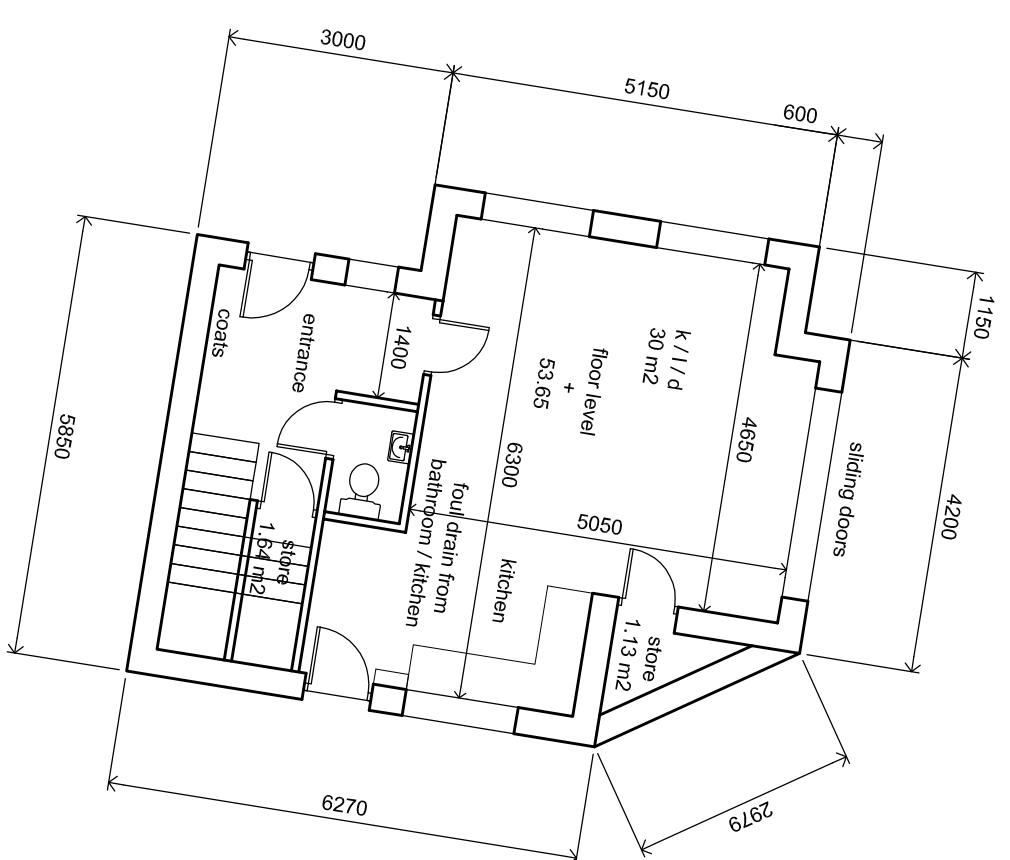

external dimensions of new house

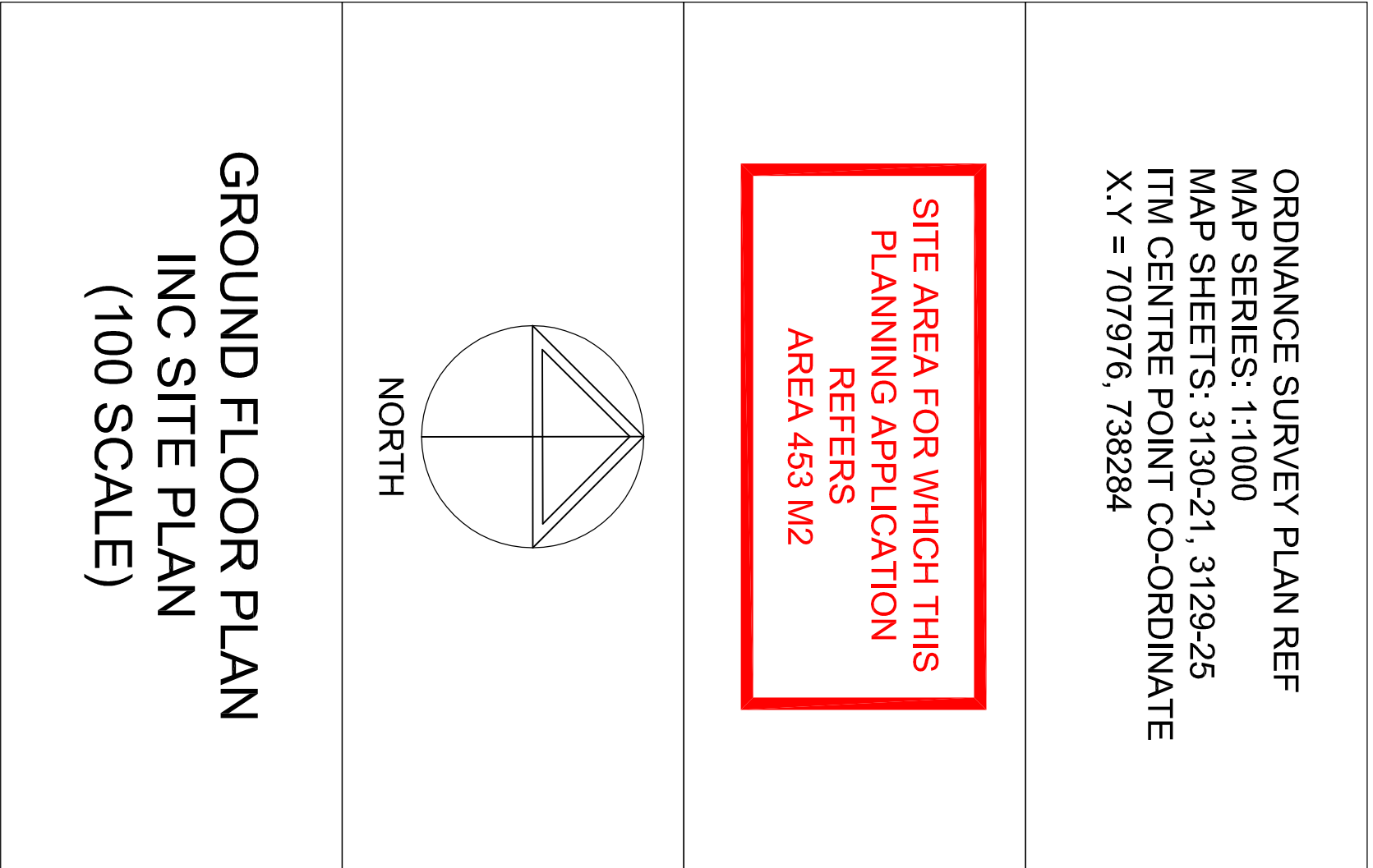

AS PROPOSED

SCALE: DRAWING TO SCALE AT A1 SIZE	ORDNANCE SURVEY PLAN REF MAP SERIES: 1:1000 MAP SHEETS: 3130-21, 3129-25 ITM CENTRE POINT CO-ORDINATE X,Y = 707976, 738284		THE DEVELOPMENT WILL CONSIST OF: (1) THE CONSTRUCTION OF A TWO STOREY 2 BEDROOM PITCHED ROOF DWELLING WITHIN THE SIDE GARDEN OF THE EXISTING HOUSE WITH GROUND FLOOR FLAT ROOF FRONT PROJECTION (2) NEW VEHICULAR ENTRANCE OF THE EXISTING HOUSE WITH GROUND FLOOR FLAT ROOF FRONT PROJECTION (3) NEW VEHICULAR ACCESS TO NO 1 (3) NEW PEDESTRIAN ENTRANCE OF THE PUBLIC FOOTPATH AND (4) CONNECTION TO ALL PUBLIC SERVICES AND ALL NECESSARY ANCILLARY SITE DEVELOPMENT WORKS TO FACILITATE THIS DEVELOPMENT. AT 1 SAINT BRIGIDS PARK, BLANCHARDSTOWN, DUBLIN 15, D15 RTNF FOR		DRAWN
			PLANNING APPLICATION DRAWING		
			SCALE 1 TO 100	DRG NO	
			599 / 02		
			DATE MARCH 2025		