

Period house overlooking Lough Eske

The Rectory, Lough Eske, Barnesmore, Co Donegal, F94 RCY8



Period house overlooking Lough Eske

The Rectory, Lough Eske, Barnesmore, Co Donegal, F94 RCY8



Period house overlooking Lough Eske

The Rectory, Lough Eske, Barnesmore, Co Donegal, F94 RCY8



About this property

The Rectory is a wonderful property, approached via a sweeping driveway through pillared gates, the house occupies an elevated position within a private woodland setting. The property offers flexible accommodation over three storeys and retains period features such as sash windows and also more modern touches including beautiful parquet flooring and Bangor blue slates. The house is presented in exceptional order and has been very well cared for by the current owners.



Period house overlooking Lough Eske

The Rectory, Lough Eske, Barnesmore, Co Donegal, F94 RCY8



Plans

3,724 sq ft

3 acres

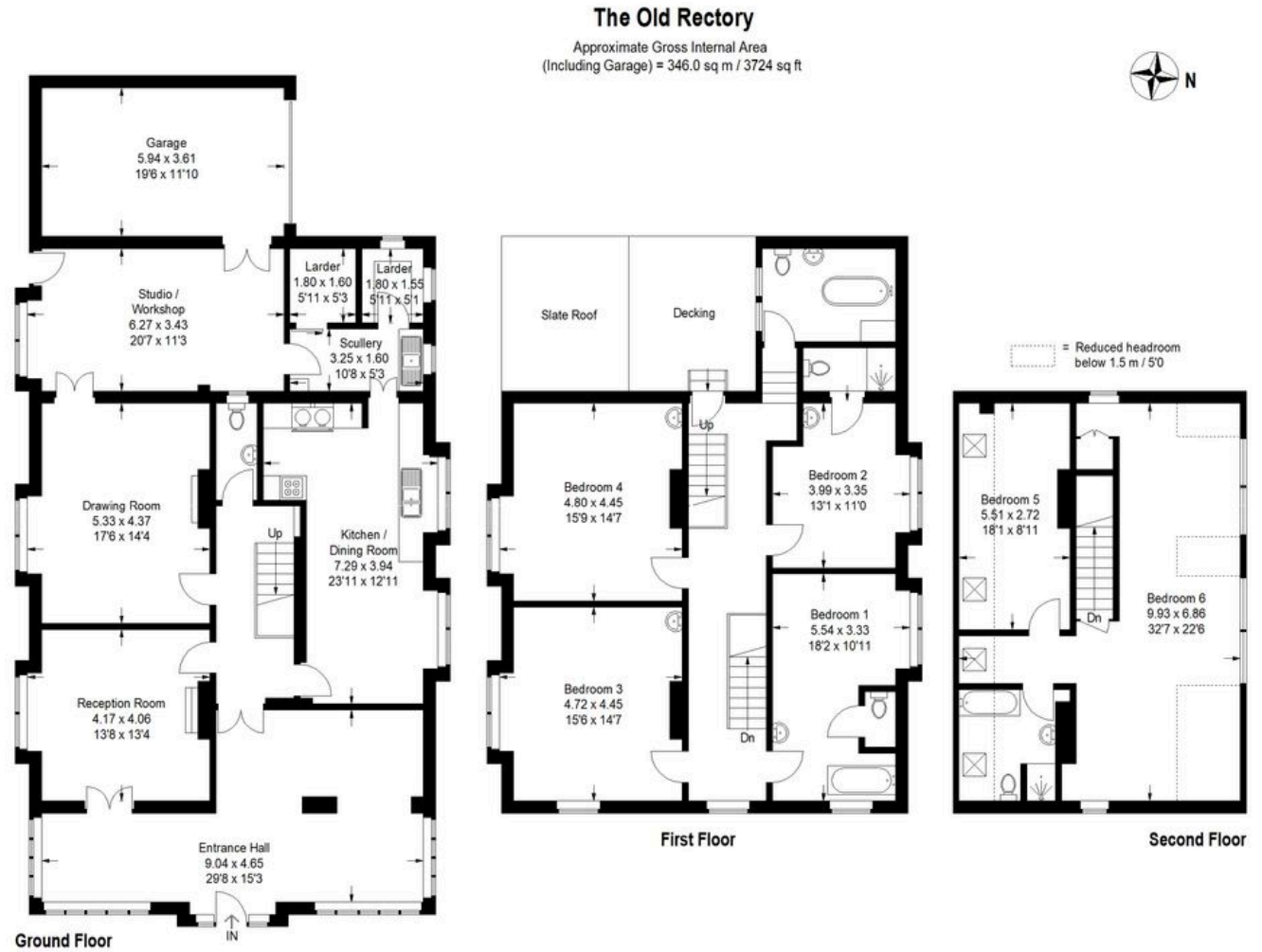

Illustration for identification purposes only, measurements are approximate, not to scale. (ID947567)



Local Area

County Donegal is located on the north-westerly tip of Ireland and is considered one of Ireland's most beautiful and unspoilt counties which is renowned for its history, heritage, and landscape. Donegal is typified by its dramatic towering sea cliffs, rolling lush hills and stunning beaches.

The Barnesmore Gap is one of the most stunning settings in Donegal and is well known throughout the country as a place of exceptional natural beauty.



Property Details

Key Features

- Immaculately kept formal reception rooms
- Ideal family or entertaining home
- Far reaching views in all seasons
- Beautiful gardens
- Close to all amenities

Services & Additional Information

- Oil fired central heating
- Mains electricity
- Private drainage
- Broadband
- Local authority water connection

BER

BER Rating = D1

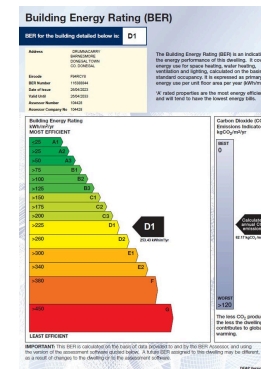

Tenure

Freehold

Period house overlooking Lough Eske

The Rectory, Lough Eske, Barnesmore, Co Donegal, F94 RCY8



Enquire



Cianan Duff

Dublin - Country

+353 (0) 86 386 1466

cianan.duff@savills.ie

More Information



[View on website](#)



[View Digital Brochure](#)



[Property Search](#)

Viewing strictly by appointment

Property Ref: DUY230097

Residential & Country

33 Molesworth Street, D02 CP04

+353 (0) 1 618 1300



Important Notice: Savills, its clients and any joint agents give notice that 1: They are not authorised to make or give any representations or warranties in relation to the property either here or elsewhere, either on their own behalf or on behalf of their client or otherwise. They assume no responsibility for any statement that may be made in these particulars. These particulars do not form part of any offer or contract and must not be relied upon as statements or representations of fact. 2: Any areas, measurements or distances are approximate. The text, photographs and plans are for guidance only and are not necessarily comprehensive. It should not be assumed that the property has all necessary planning, building regulation or other consents and Savills have not tested any services, equipment or facilities. Purchasers must satisfy themselves by inspection or otherwise. *powered by* **FluxPro**