

THIRD FLOOR PLAN

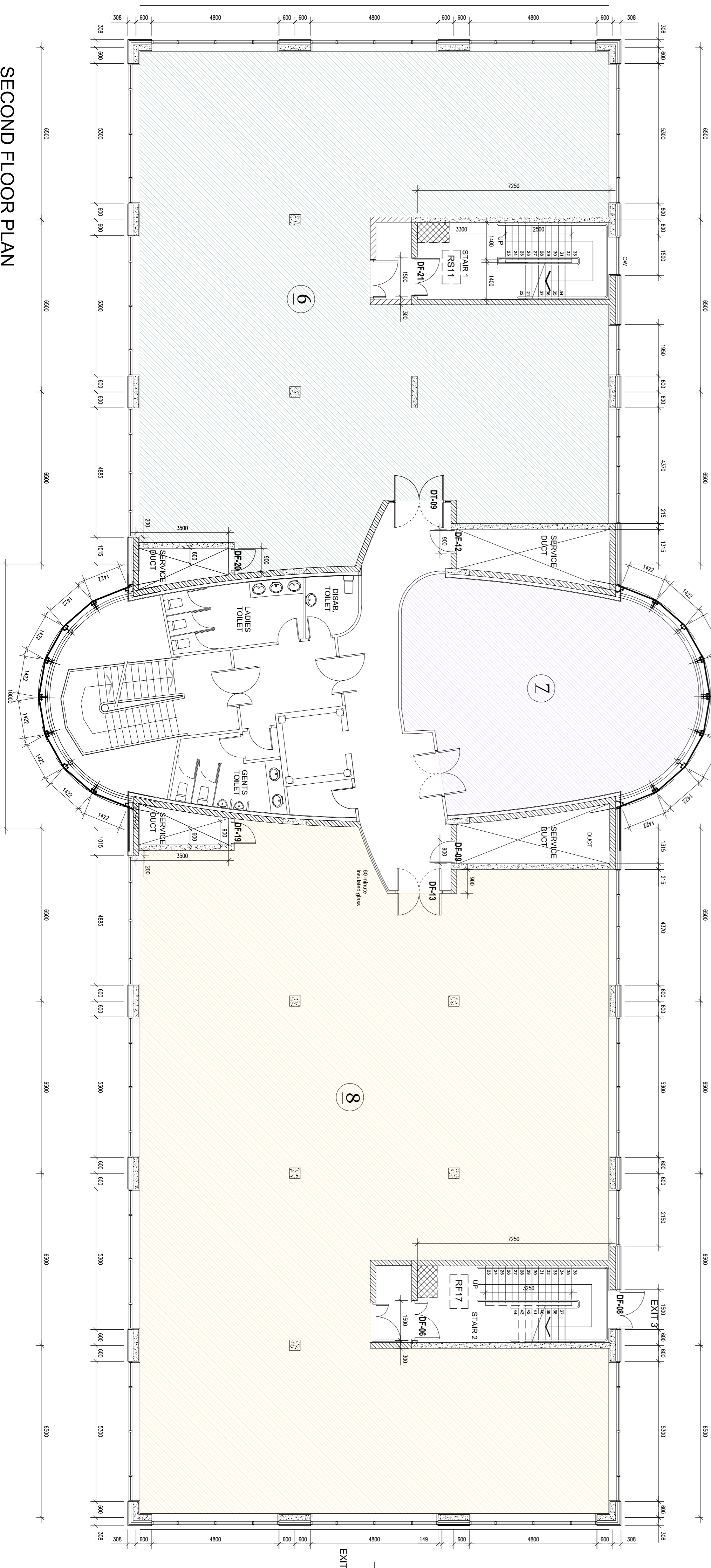

SECOND FLOOR PLAN

IMPORTANT TO BE READ

THIS DRAWING IS COPYRIGHTED. THIS DRAWING IS TO BE READ IN CONJUNCTION WITH ALL OTHER RELEVANT ARCHITECTURAL & ENGINEERING DRAWINGS. DO NOT SCALE. USE FIGURED DIMENSIONS ONLY. ALL DIMENSIONS TO BE NOMINAL-FINISHES. CONTRACTORS MUST VERIFY ALL DIMENSIONS AT SITE PRIOR TO CONSTRUCTION OR FABRICATION. ALL CONSTRUCTION TO BE CARRIED OUT IN ACCORDANCE WITH RELEVANT AND CURRENT BUILDING REGULATIONS. ARCHITECTS TO BE INFORMED IMMEDIATELY OF ANY DISCREPANCIES BEFORE WORK PROCEEDS. "IF IN DOUBT ASK"

- OFFICE 9 - 178,23sq.m. /1918sq.ft.
- OFFICE 10 - 46,37sq.m. /499sq.ft.
- OFFICE 11 - 79,92sq.m. / 860sq.ft.
- OFFICE 12 - 315,81sq.m. / 3398sq.ft.

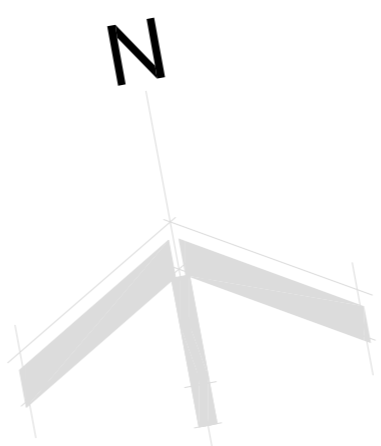

- OFFICE 6 - 293,68sq.m. /3160sq.ft.
- OFFICE 7 - 80,78sq.m. / 869sq.ft.
- OFFICE 8 - 408,80sq.m. / 4399sq.ft.

TOTAL AREA OF ENTIRE BUILDING: 2,777.62 Sq/m or 29,898 Sq ft

REV	DESCRIPTION	DATE

PROJECT: CASTLELANDS CONSTRUCTION
GOULDS HILL BUSINESS PARK
MAIN BUILDING

PLANNING DRAWINGS
PLANS

SCALE: 1:100 DATE: OCTOBER 2007 DRAWN: POC/ML/AO DRAWING NO. (A) 07/20/EB/3

KEVIN O'KEEFFE ARCHITECTS LTD.
ANNABELLA MALLOW, CO. CORK.
TEL: (022) 21529, FAX: (022) 42526, e-mail: info@kokai.ie
WEBSITE: www.kokai.ie

Kevin O'Keefe Dip. Arch., Eric Beamish Dip. Arch., Paul O'Connell Dip Arch.