

SCHILLER & SCHILLER

LICENSED AUCTIONEERS & SOLE AGENTS

ARDTARMON CASTLE, BALLINFULL, CO. SLIGO

TEL: 071-9163284/ 087-2500-974. FAX: 071-9163860. WEB SITE: <http://www.irishproperties.com>



No. 232 Glenlossera Lodge, Ballycastle, Co. Mayo

(232FN-GL) Approx 7 acres Price Guide: REDUCED TO € 125.000



Description:

A unique property in many ways. It combines an exceptional location by the Atlantic with a period property full of history and style in one of Ireland's last undeveloped areas outside Ballycastle, Co. Mayo.

History:

The Lodge was built in the mid 1850's as a principal Residence of an estate comprising 3635 acres acquired by Zachary Mudge (1814-1867) from the Encumbered Estates Commission in January 1854 for 2,490 pounds probably as a commercial enterprise.

The Muges' family originated from Devonshire and their historic Mudge family links to the renowned 18th century portrait painter Sir Joshua Reynolds (1723 –1792) who also hailed from Devonshire. The Mudge ownership gradually reduced in Mayo over the next seventy years with the sale of the remaining 2731 acres taking place in 1927 to the Irish Land Commission. Thereafter the Lodge was next owned by the Moran family and was sold again in the 1950's to the present owners. It has become derelict over the years but full planning permission for full restoration has been granted in 2008.

The above particulars are issued by this office on the understanding that all negotiations are conducted through this office. Every care is taken in preparing particulars but this firm does not hold itself responsible for any inaccuracies. All reasonable offers will be submitted to the vendors.

O.S.I. No. AU0024902

SCHILLER & SCHILLER

LICENSED AUCTIONEERS & SOLE AGENTS

ARDTARMON CASTLE, BALLINFULL, CO. SLIGO

TEL: 071-9163284/ 087-2500-974. FAX: 071-9163860. WEB SITE: <http://www.irishproperties.com>



No. 232 Glenlossera Lodge, Ballycastle, Co. Mayo

(232FN-GL) Approx 7 acres Price Guide: REDUCED TO € 125.000



The Lodge

Built with locally sourced pale yellow sandstone with mica the windows, doors and chimneystacks are all in imported pale yellow brick and the roof covering was in black Welsh slate. Glenlossera Lodge is stylistically similar in many ways to the cottages and ancillary structures of estates elsewhere in the British Isles of that period.

The building features a most unusual plan arrangement consisting of three blocks with a central symmetrical block 14m wide by 7m deep featuring elaborately decorated flat gables with a receded central door flanked by two narrow slit windows that once featuring cast iron diamond pattern window frames. Behind the main block there are two almost symmetrical flanking elements the Southern block is 15m long by 6m wide and contains bedrooms, the Northern block is 12 m long and 6m wide and contains the kitchen and other ancillary staff accommodation.

Glenlossera is a most unusual building being designed in a style atypical of other conventional and traditional Mayo buildings typologies and is therefore architecturally stylistically and socially significant.

Grounds

The property commands circa 7 acres including sporting rights thereon. It also mentions approx 900 acres of additional sporting rights on a property transfer document from 1927 as well as fishing rights in the Glenlossera River, which have not been exercised.

Future Outlook:

The property is offered with the benefit of full planning permission for restoration. It would transform once again into one of Co Mayo's finest and most unique properties.

Price Guide: REDUCED TO € 125.000

Viewing strictly by appointment with sole selling agents.

The above particulars are issued by this office on the understanding that all negotiations are conducted through this office. Every care is taken in preparing particulars but this firm does not hold itself responsible for any inaccuracies. All reasonable offers will be submitted to the vendors.

O.S.I. No. AU0024902

SCHILLER & SCHILLER

LICENSED AUCTIONEERS & SOLE AGENTS

ARDTARMON CASTLE, BALLINFULL, CO. SLIGO

TEL: 071-9163284/ 087-2500-974. FAX: 071-9163860. WEB SITE: <http://www.irishproperties.com>



No. 232 Glenlossera Lodge, Ballycastle, Co. Mayo

(232FN-GL) Approx 7 acres Price Guide: REDUCED TO € 125.000



The above particulars are issued by this office on the understanding that all negotiations are conducted through this office. Every care is taken in preparing particulars but this firm does not hold itself responsible for any inaccuracies. All reasonable offers will be submitted to the vendors.

O.S.I. No. AU0024902

SCHILLER & SCHILLER

LICENSED AUCTIONEERS & SOLE AGENTS

ARDTARMON CASTLE, BALLINFULL, CO. SLIGO

TEL: 071-9163284/ 087-2500-974. FAX: 071-9163860. WEB SITE: <http://www.irishproperties.com>



No. 232 Glenlossera Lodge, Ballycastle, Co. Mayo

(232FN-GL) Approx 7 acres Price Guide: REDUCED TO € 125.000

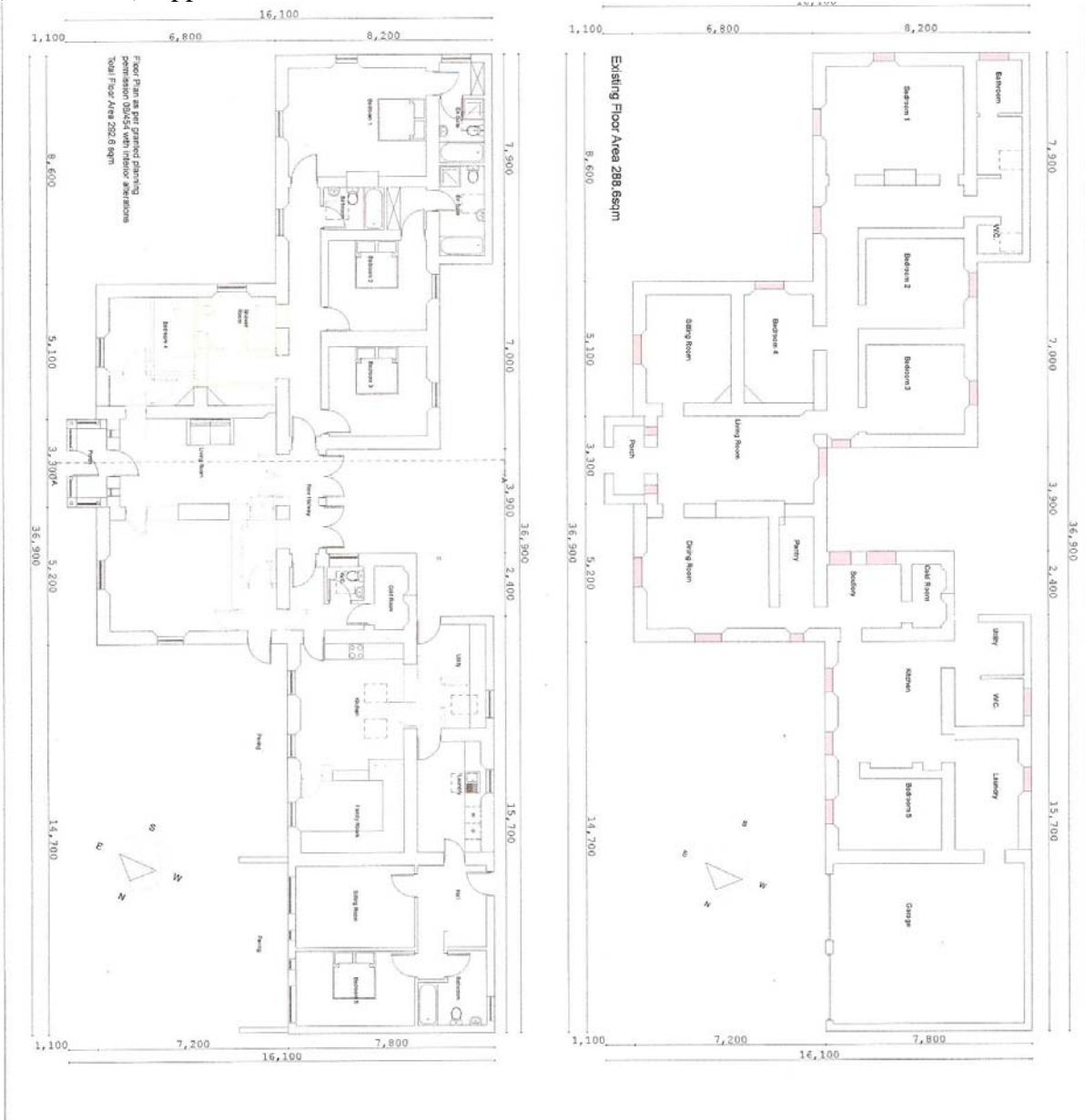

The above particulars are issued by this office on the understanding that all negotiations are conducted through this office. Every care is taken in preparing particulars but this firm does not hold itself responsible for any inaccuracies. All reasonable offers will be submitted to the vendors.

O.S.I. No. AU0024902

SCHILLER & SCHILLER

LICENSED AUCTIONEERS & SOLE AGENTS

ARDTARMON CASTLE, BALLINFULL, CO. SLIGO

TEL: 071-9163284/ 087-2500-974. FAX: 071-9163860. WEB SITE: <http://www.irishproperties.com>



No. 232 Glenlossera Lodge, Ballycastle, Co. Mayo

(232FN-GL) Approx 7 acres Price Guide: REDUCED TO € 125,000

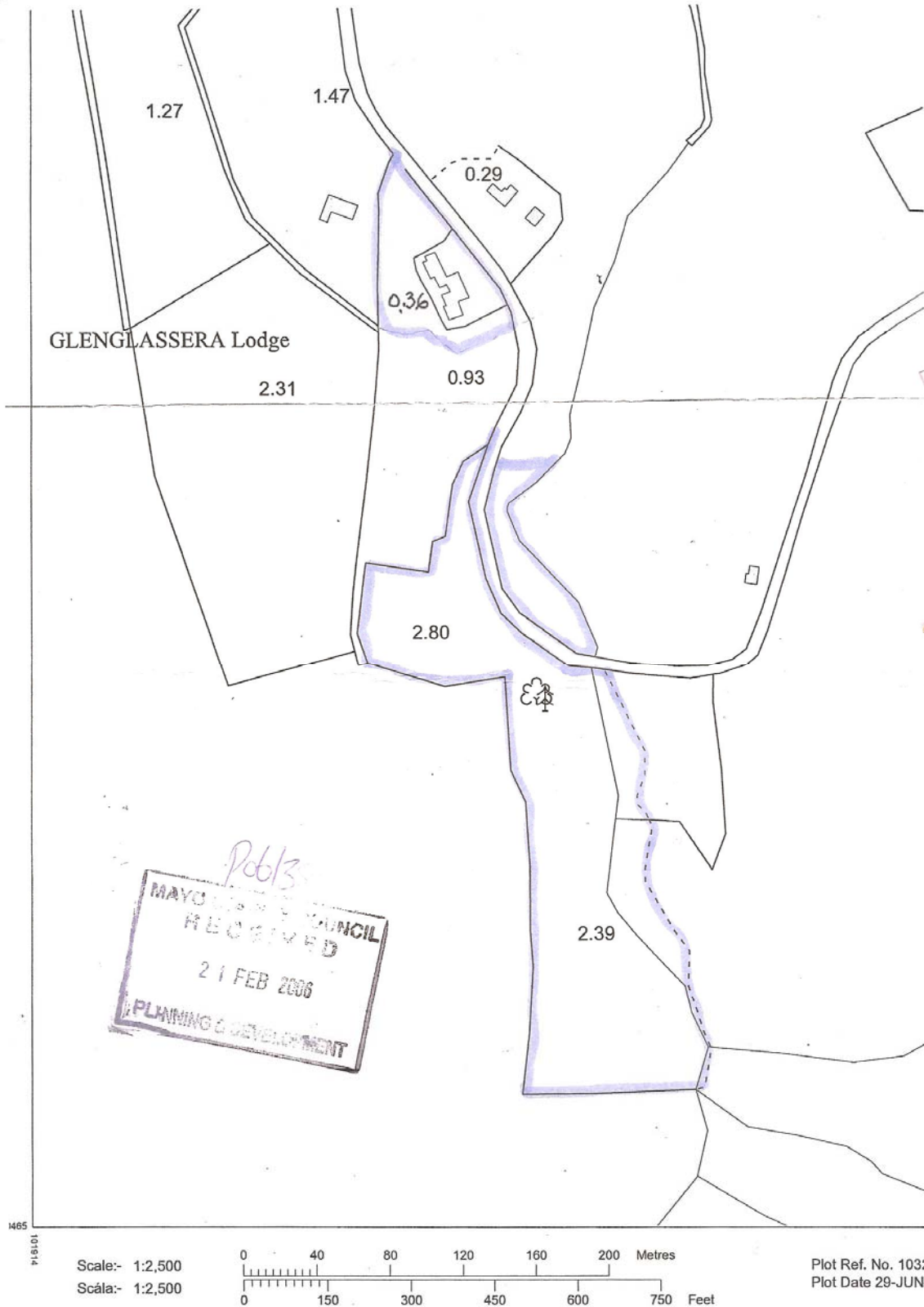

LANDHOLDING MAP.

The above particulars are issued by this office on the understanding that all negotiations are conducted through this office. Every care is taken in preparing particulars but this firm does not hold itself responsible for any inaccuracies. All reasonable offers will be submitted to the vendors.

O.S.I. No. AU0024902