



The Property Registration Authority
An tÚdarás
Clárúcháin Maoine
Folio: SL11214

This map should be read in conjunction with the folio.

Registry maps are based on OSI topographic mapping. Where registry maps are printed at a scale that is larger than the OSI published scale, accuracy is limited to that of the original OSI map scale.

For details of the terms of use and limitations as to scale, accuracy and other conditions relating to Land Registry maps, see www.pral.ie.

This map incorporates Ordnance Survey Ireland (OSI) mapping data under a licence from OSI. Copyright © OSI and Government of Ireland.

(centre-line of parcel(s) edged)

- Freehold
- Leasehold
- SubLeasehold

Burdens (may not all be represented on map)

- Right of Way / Wayleave
- Turbary
- Pipeline
- Well
- Pump
- Septic Tank
- Soak Pit

A full list of burdens and their symbology can be found at: www.landdirect.ie

The registry operates a non-conclusive boundary system. The Registry Map identifies properties not boundaries meaning neither the description of land in a register nor its identification by reference to a registry map is conclusive as to the boundaries or extent. (see Section 85 of the Registration of Title Act, 1964). AS inserted by Section 62 of the Registration of Deed and Title Act 2006.



1:2500 Scale

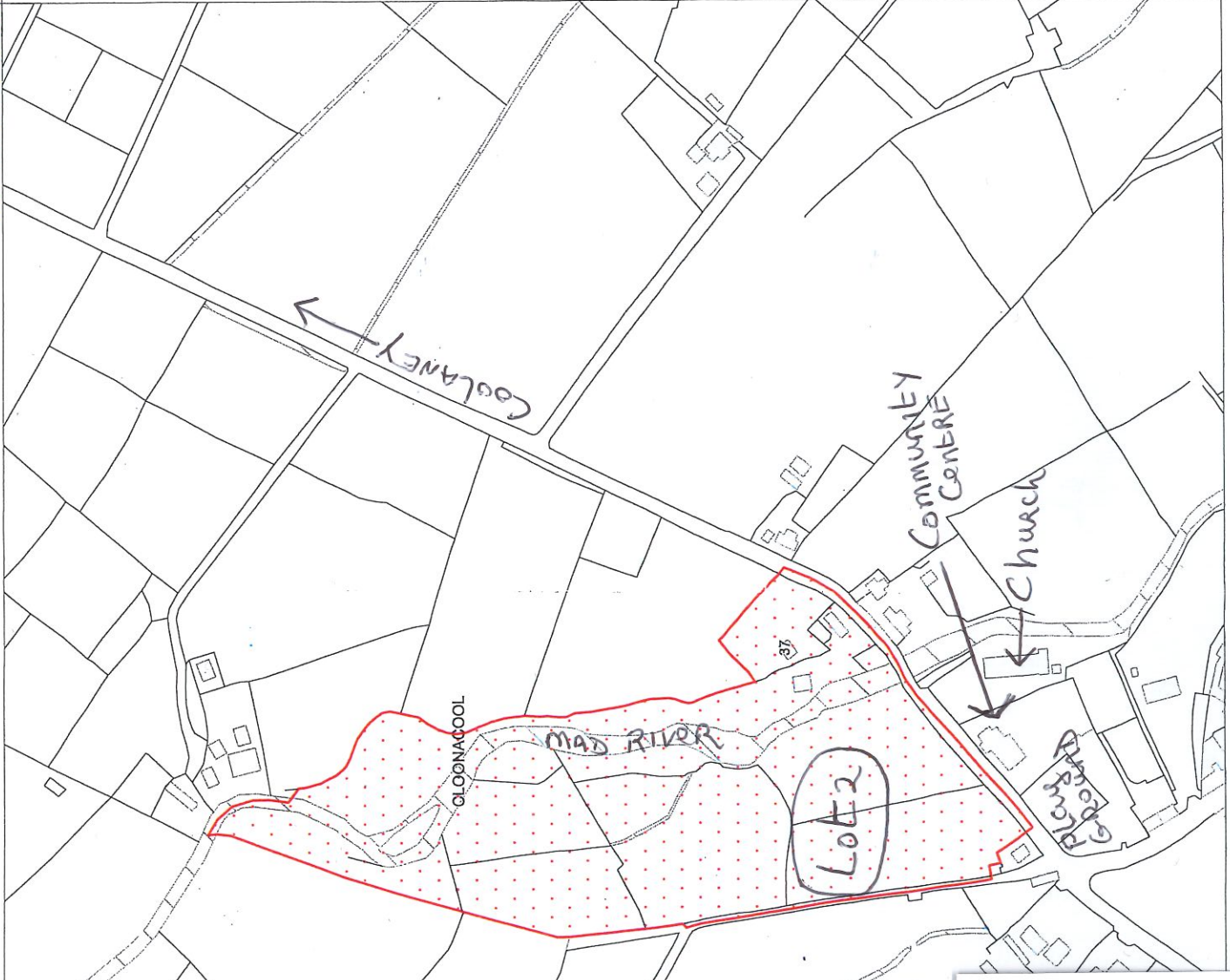

07 June 2022 13:32:22 Application Number: P2022LR064628E

Cloonacool Village, Co. Sligo

27 Acres & House For Sale

Lot 1: 16.25 acres at Mullaun, Cloonacool

Lot 2: 10.75 acres including old 2 storey residence
at Cloonacool village (Mad River)



ROGER McCARRICK
B.A. F.S.C.S.I.

- M 087 681 0848
- T +353 (0)71 918 5050
- F +353 (0)71 918 5922
- W www.realestatealliance.ie
- E info@reamccarrick.ie

- AUCTIONEERS
- VALUERS
- ESTATE AGENTS
- AGRI BUSINESS
- COMMISSIONER FOR OATHS



Tubbercurry, Co. Sligo, Ireland & Teeling St., Sligo, Ireland.

549390 mE, 817070 mN

The Property Registration Authority
An tÚdarás Clárúcháin Maoine

Folio: SL11214

This map should be read in conjunction with the folio.

Registry maps are based on OSI topographic mapping. Where registry maps are printed at a scale that is larger than the OSI published scale, accuracy is limited to that of the original OSI map scale.

For details of the terms of use and limitations as to scale, accuracy and other conditions relating to Land Registry maps, see www.prl.ie.

This map incorporates Ordnance Survey Ireland (OSI) mapping data under a licence from OSI. Copyright © OSI and Government of Ireland.

(centre-line of parcel(s) edged)

- Freehold
- Leasehold
- SubLeasehold

Burdens (may not all be represented on map)

- Right of Way / Wayleave
- Turbary
- Pipeline
- Well
- Pump
- Septic Tank
- ▽ Soak Pit

A full list of burdens and their symbology can be found at: www.landdirect.ie



- AUCTIONEERS
- VALUERS
- ESTATE AGENTS
- AGRI BUSINESS
- COMMISSIONER FOR OATHS

ROGER McCARRICK
 B.A., F.S.C.S.I.

M 087 681 0848
T +353 (0)71 918 5050
F +353 (0)71 918 5922
W www.realestatealliance.ie
E info@reamccarrick.ie

Tubbercurry, Co. Sligo, Ireland & Teeling St., Sligo, Ireland.



Cloonacool Village, Co. Sligo

27 Acres & House For Sale

Lot 1: 16.25 acres at Mullaun, Cloonacool

Lot 2: 10.75 acres including old 2 storey residence

at Cloonacool village (Mad River)

The registry operates a non-conclusive boundary system. The Registry Map identifies properties not boundaries meaning neither the description of land in a register nor its identification by reference to a registry map is conclusive as to the boundaries or extent. (see Section 85 of the Registration of Title Act, 1964). As inserted by Section 62 of the Registration of Deed and Title Act 2006.

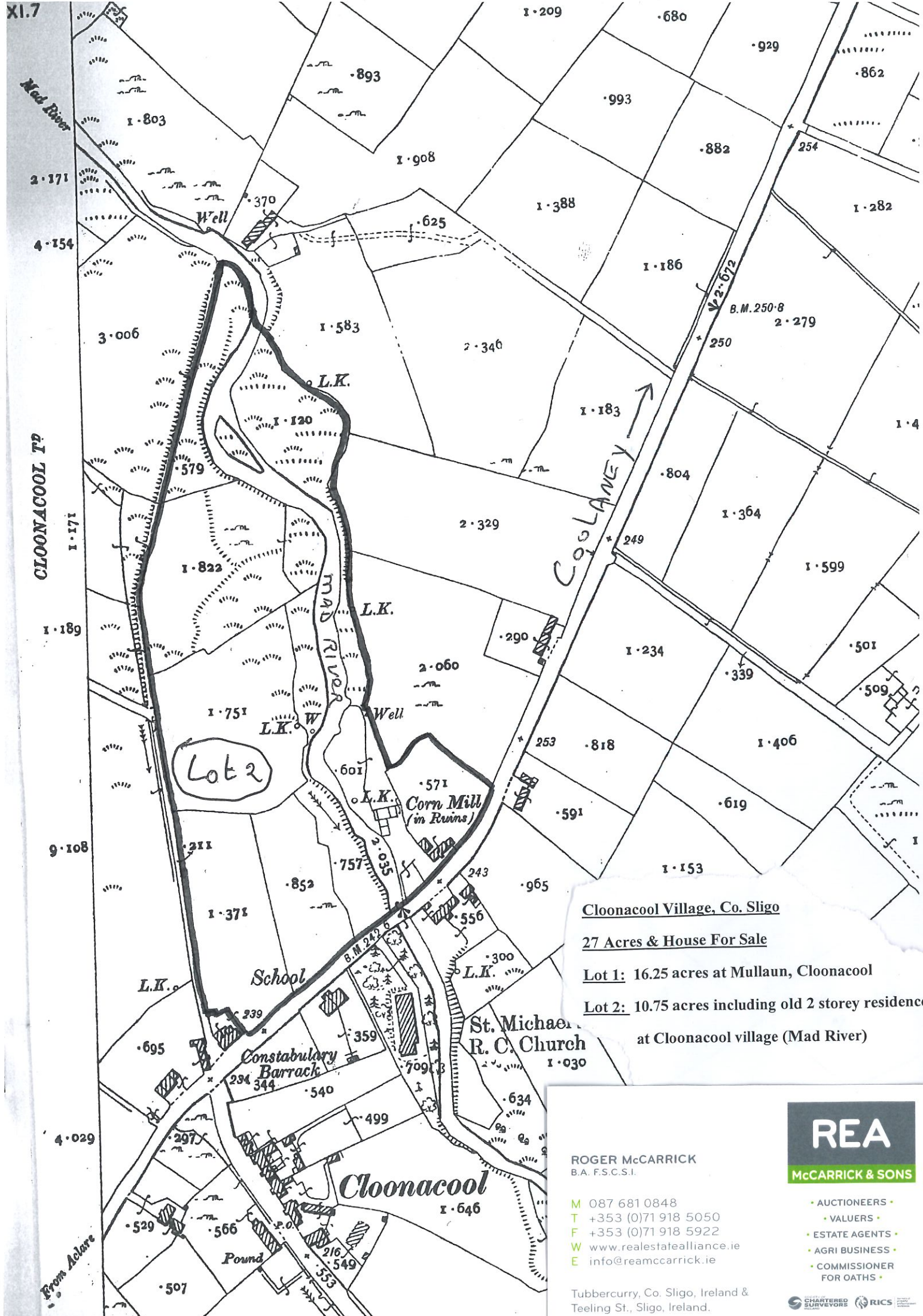

Cloonacool Village, Co. Sligo

27 Acres & House For Sale

Lot 1: 16.25 acres at Mullaun, Cloonacool

Lot 2: 10.75 acres including old 2 storey residence at Cloonacool village (Mad River)

REA

McCarrick & Sons

ROGER McCARRICK
B.A. F.S.C.S.I.

M 087 681 0848
T +353 (0)71 918 5050
F +353 (0)71 918 5922
W www.realestatealliance.ie
E info@reamccarrick.ie

- AUCTIONEERS •
- VALUERS •
- ESTATE AGENTS •
- AGRI BUSINESS •
- COMMISSIONER FOR OATHS •

Tubbercurry, Co. Sligo, Ireland & Teeling St., Sligo, Ireland.



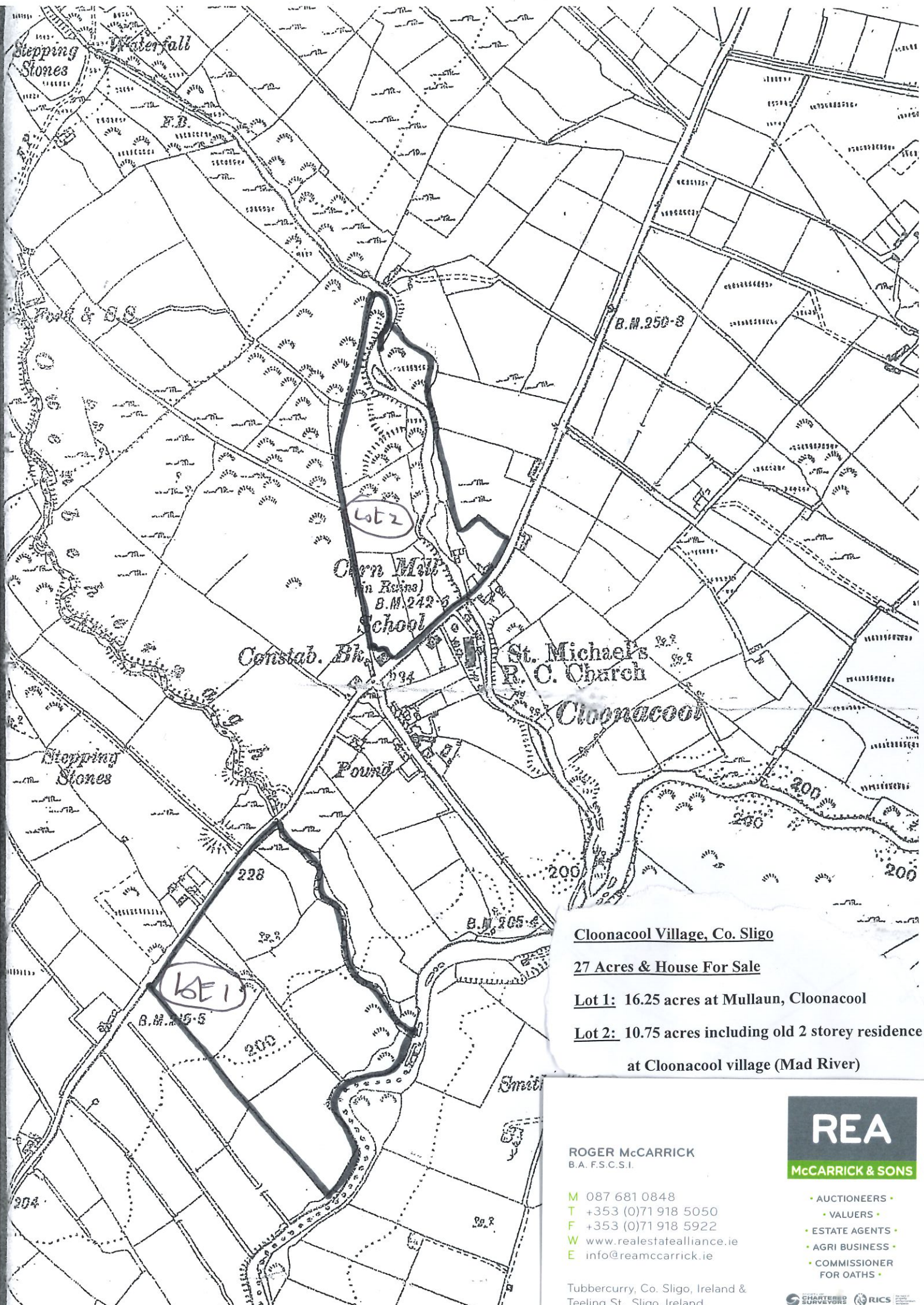

Clonacool Village, Co. Sligo

27 Acres & House For Sale

Lot 1: 16.25 acres at Mullaun, Clonacool

**Lot 2: 10.75 acres including old 2 storey residence
at Clonacool village (Mad River)**



ROGER McCARRICK
B.A. F.S.C.S.I.

M 087 681 0848
T +353 (0)71 918 5050
F +353 (0)71 918 5922
W www.realestatealliance.ie
E info@reamccarrick.ie

- AUCTIONEERS •
- VALUERS •
- ESTATE AGENTS •
- AGRI BUSINESS •
- COMMISSIONER FOR OATHS •

Tubbercurry, Co. Sligo, Ireland &
Teeling St., Sligo, Ireland.

