

Charming 4-Bed 18th century cottage on about C. 5 Acres

Rose Cottage, Carrownedeen, Swinford, Co Mayo, F12 DE92

savills



Charming 4-Bed 18th century cottage on about C. 5 Acres

Rose Cottage, Carrownedeen, Swinford, Co Mayo, F12 DE92



Charming 4-Bed 18th century cottage on about C. 5 Acres

Rose Cottage, Carrownedeen, Swinford, Co Mayo, F12 DE92



About this property

Nestled within almost 5 acres of landscaped grounds, Rose Cottage stands as a testament to meticulous restoration, with no stone being unturned. This exquisite property combines two stone cottages from the 18th century, seamlessly linked to create a haven of timeless charm and elegance. At the heart of its landscaped mature gardens lies a captivating 500,000-litre spring-fed pond, a sanctuary for an array of beautiful wildlife, enhancing the serene and private ambience that envelops the property.

The journey to Rose Cottage begins with an impressive approach via 7-foot electric gates, leading down a hedge-lined 180-meter driveway, ensuring privacy and an immediate sense of arrival.



Charming 4-Bed 18th century cottage on about C. 5 Acres

Rose Cottage, Carrownedeen, Swinford, Co Mayo, F12 DE92



Charming 4-Bed 18th century cottage on about C. 5 Acres

Rose Cottage, Carrownedon, Swinford, Co Mayo, F12 DE92



Plans



191.5 Square Meters

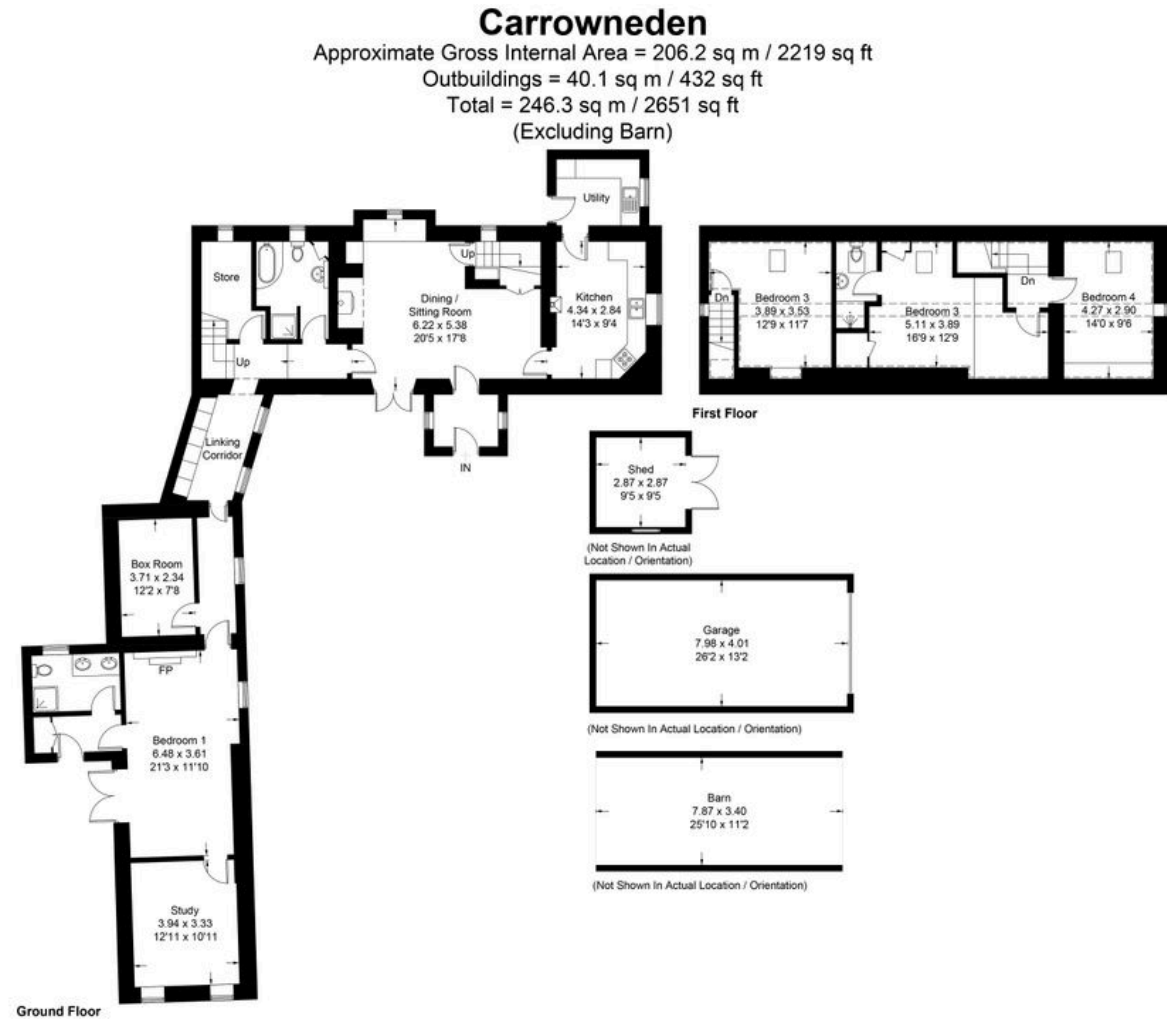

Illustration for identification purposes only, measurements are approximate, not to scale. floorplansUsketch.com © (ID1073934)

Charming 4-Bed 18th century cottage on about C. 5 Acres

Rose Cottage, Carrowneden, Swinford, Co Mayo, F12 DE92



Local Area

Rose Cottage sits between the quaint market towns of Swinford and Foxford located in the East of Mayo and is approx. 22.6 Km from County Mayo's largest Town of Ballina. With excellent transportation connections, residents enjoy swift access to major routes such as the N26 & N5, as well as convenient TFI Bus services 421 & 451, and the Bus Eireann route 22 to Dublin Airport. Additionally, Knock Airport lies a mere 18 km away.



Charming 4-Bed 18th century cottage on about C. 5 Acres

Rose Cottage, Carrownedan, Swinford, Co Mayo, F12 DE92



Property Details

Key Features

- Recently renovated 18th century 4-bed cottage
- Property sits on approx C.5 acres
- 500,000 ltr natural pond
- Multiple outbuilding's with water and electricity

Services & Additional Information

- Oil Fired Central Heating
- CCTV Security System
- Solid Fuel Back Boiler
- Own Septic Tank
- Well Water

BER

BER Rating = C3

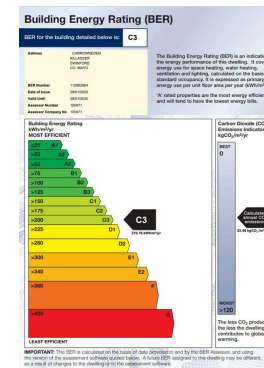

Local Authority

Mayo County Council

Tenure

Freehold

Charming 4-Bed 18th century cottage on about C. 5 Acres

Rose Cottage, Carrownedeen, Swinford, Co Mayo, F12 DE92



Enquire



Cianan Duff

Dublin - Country
+353 (0) 86 386 1466
cianan.duff@savills.ie



Cian Pearse

Dublin - Country
+353 (0) 86 203 2613
cian.pearse@savills.ie

More Information



[View on website](#)



[View Digital Brochure](#)



[Property Search](#)

Viewing strictly by appointment

Property Ref: DUY240043



Important Notice: Savills, its clients and any joint agents give notice that 1: They are not authorised to make or give any representations or warranties in relation to the property either here or elsewhere, either on their own behalf or on behalf of their client or otherwise. They assume no responsibility for any statement that may be made in these particulars. These particulars do not form part of any offer or contract and must not be relied upon as statements or representations of fact. 2: Any areas, measurements or distances are approximate. The text, photographs and plans are for guidance only and are not necessarily comprehensive. It should not be assumed that the property has all necessary planning, building regulation or other consents and Savills have not tested any services, equipment or facilities. Purchasers must satisfy themselves by inspection or otherwise. *powered by* **FluxPro**