

Beech & silver birch planted to reinforce existing mature hedge

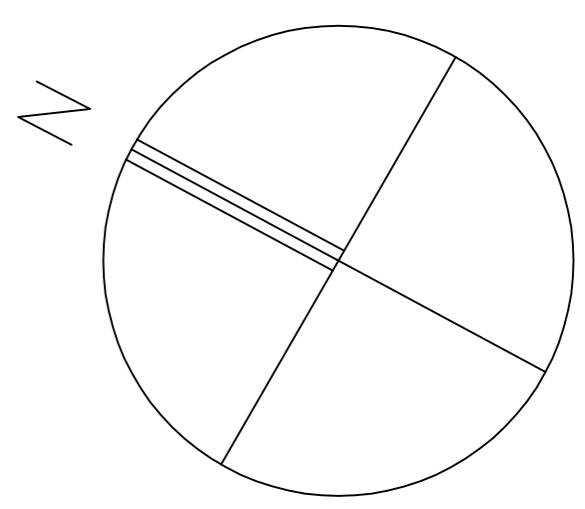
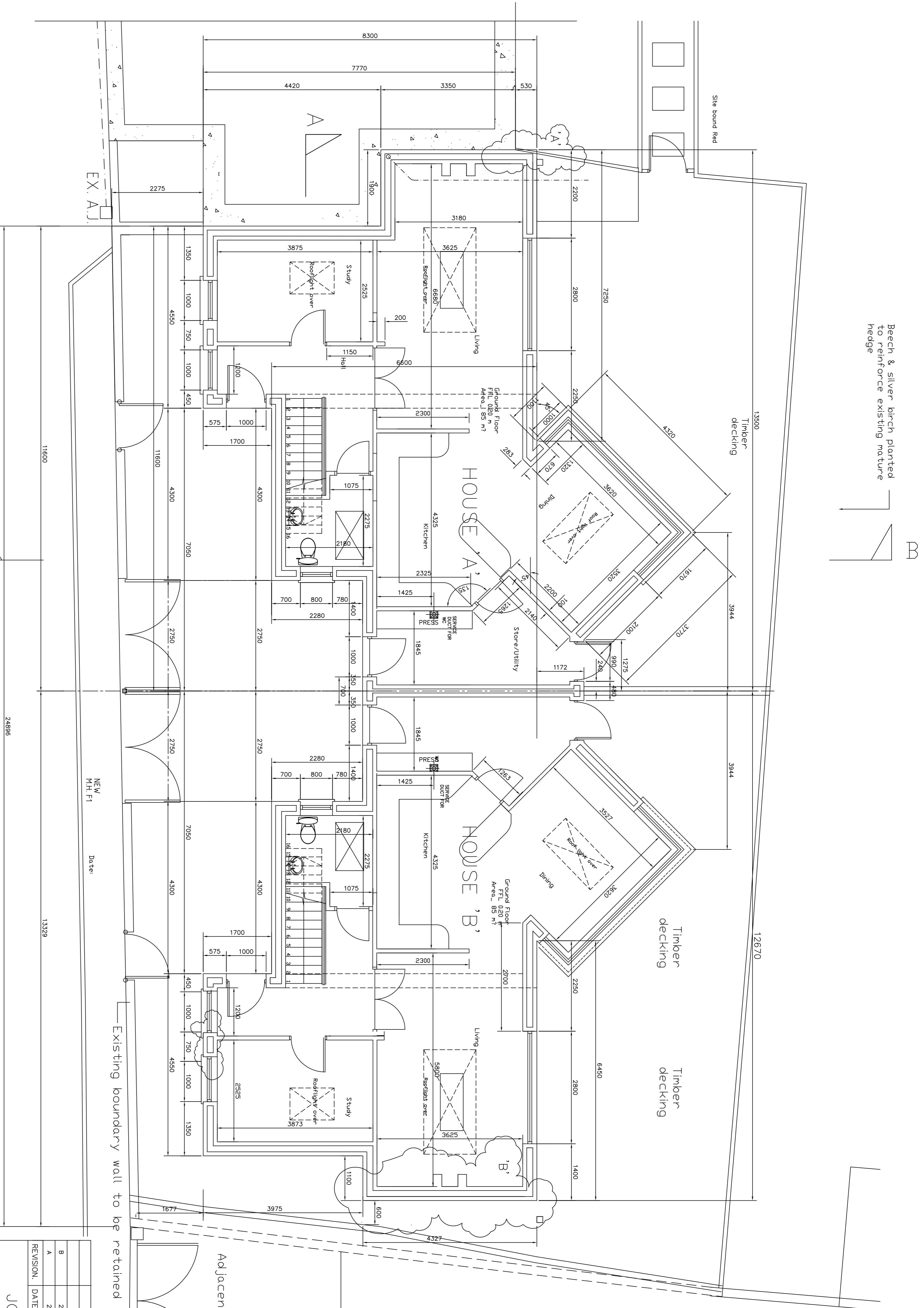

Adjacent Property

**ROISIN HANLEY**  
 ARCHITECTS LIMITED  
 "Lisieux House", No 5 Charltons, Tice, Crofton Rd., Dan Loughare  
 Ph. 01-2020886/2020887  
 Fax. 01-2010495 Mobile: 087-4555261 email: roisinh@roisinh.com

**Historic Building Consultants**  
 Interior Design Consultants  
 Healthcare Consultants

REVISION	DATE	DETAILS
B	22.2.16	REVISIONS TO LIVING ROOM DIMENSIONS HOUSE 'B'
A	20.2.16	MINOR REVISION AT JUNCTION WITH EXISTING COTTAGE

**JOHN L. O'HANLON & ASSOC.**  
 Architectural, Engineering Design  
 and  
 Project Management  
 69 Lr MAIN ST. ARKLOW Co. WICKLOW  
 E-mail: jloh@eircom.net  
 DORM QUALITY DEVELOPMENTS

TITLE : PROPOSED DWELLING HOUSES AT SIDMONTON ROAD  
 GREYSTONES CO. WICKLOW  
**GROUND FLOOR PLAN BLOCKWORK REVISED DIMENSIONS**  
**OPTION 'B'**

DRN. JLOH SCALE 1:50 DWG. No. 847003 REV. A  
 DATE 9.2.16