

Impressive detached home in excellent decorative order with sea views

Distant Waves, Myrtleville, Cork, P43PX53

savills



Impressive detached home in excellent decorative order with sea views

Distant Waves, Myrtleville, Cork, P43PX53



Impressive detached home in excellent decorative order with sea views

Distant Waves, Myrtleville, Cork, P43PX53



About this property

Savills is delighted to introduce Distant Waves, a large detached property in excellent decorative order with spectacular ocean views. Upon arrival, you are greeted by a recessed entrance leading to wrought iron electric gates, which guide you onto an ascending driveway, leading to the parking area, where you will find ample parking and access to a large, two-storey detached garage. The garage itself is powered and has been brought to first fix of electric and plumbing, subject to planning, the garage could be converted to a home office or self-contained space.

From here you will notice the spectacular ocean views on display from the level lawn and private rear patio. The patio area benefits from a brick built outdoor kitchen space, with porcelain tiled floor, well chosen planting and glass balustrade. This area is accessed directly off the kitchen/dining/living room via glass panelled double doors and also benefits from artificial grass, storage space and an outdoor pizza oven.

Stepping inside the front door with overhead fanlight reveals a welcoming hallway with a beautiful staircase with Mahogany monkeys tail and swan neck balustrade with intricate ironworks. To your right, you

will find a comfortable and private living room with fireplace which could also be used as a fourth bedroom. To the left, you will find a light filled and spacious open plan kitchen/dining/living room with clear sea views. This room benefits from cornicing a marble fireplace with stove and solid wood floor. Moving into the kitchen reveals an abundance of storage space, marble worktops, a large island unit with additional storage and recessed lighting. Here, you will also find a spacious utility room and guest lavatory.

Making your way upstairs, brings you to 3 spacious double bedrooms and master bathroom. The main bedroom benefits from stunning sea views, built-in wardrobes and double doors leading onto a balcony area where you can enjoy spectacular sea views. The main bedroom further benefits from a large en-suite. The second and third bedrooms are both double rooms with built in wardrobes and clear sea views.

Impressive detached home in excellent decorative order with sea views

Distant Waves, Myrtleville, Cork, P43PX53



More Details

Myrtleville beach is within a 1-minute stroll where you can enjoy a host a water activity to include sea swimming, fishing and sailing, these activities are literally on your doorstep. You will also find a bar, restaurant and shop close by as well as the picturesque Coast Road walk bringing you to Fountainstown Beach.

Distant Waves is a rare open market offering in a highly sought after coastal location.

Don't delay, contact us today to arrange your individual viewing.



Impressive detached home in excellent decorative order with sea views

Distant Waves, Myrtleville, Cork, P43PX53

savills



Impressive detached home in excellent decorative order with sea views

Distant Waves, Myrtleville, Cork, P43PX53



Plans



233 sq m / 2,508 sq ft

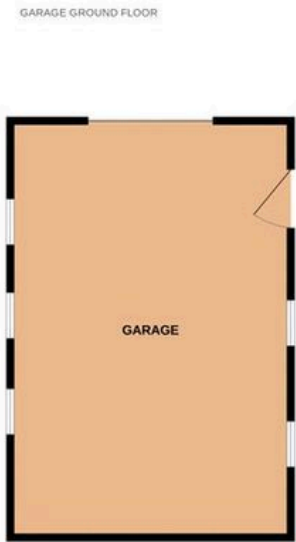
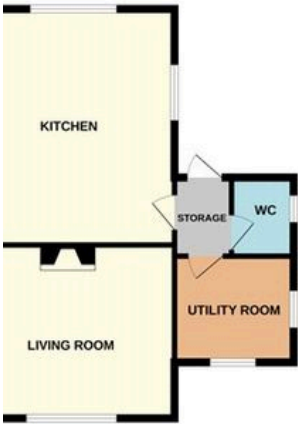

Impressive detached home in excellent decorative order with sea views

Distant Waves, Myrtleville, Cork, P43PX53

savills



Local Area

Cork City - 20 km

Myrtleville Beach - 300m

Fountainstown Beach - 2 km

Crosshaven - 3 km

Fennell's Bay - 1 km

Weaver's Point - 2.9 km

Carrigaline - 8 km

Cork International Airport 18 km

*All distances are approximate

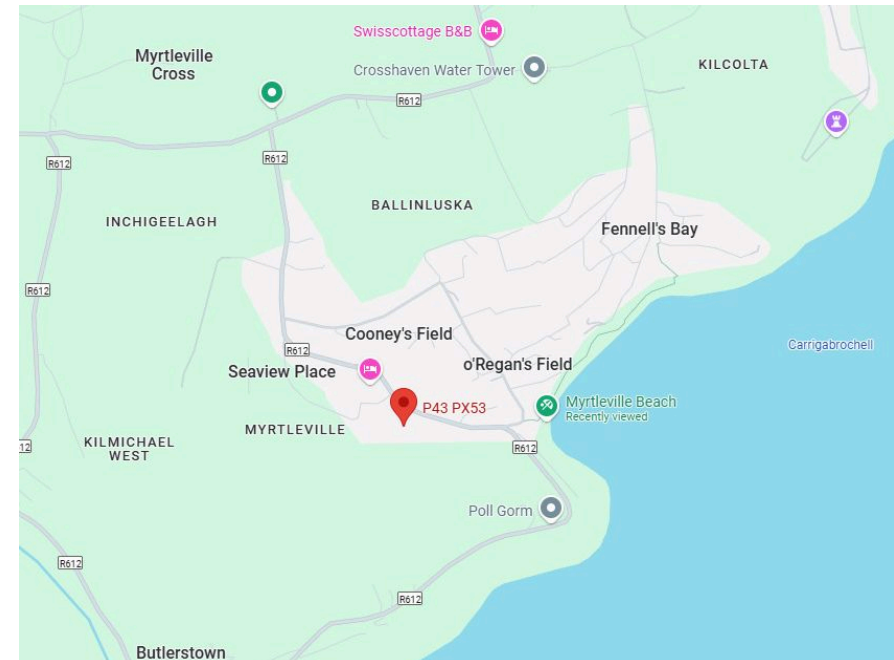

Impressive detached home in excellent decorative order with sea views

Distant Waves, Myrtleville, Cork, P43PX53



Property Details

Key Features

Impressive detached property in excellent decorative order
Approx. 233 sq m / 2,508 sq. ft
Situated on approximately 0.5 ac / 0.2 ha
Outstanding ocean views
Constructed C. 2012
Underfloor heating on the ground floor
Large detached garage
Security fencing to perimeter
Robotic lawnmower

Services & Additional Information

OFCH
Alarm / CCTV
Bio cycle
Internet
Parking

BER

BER Rating = N/A

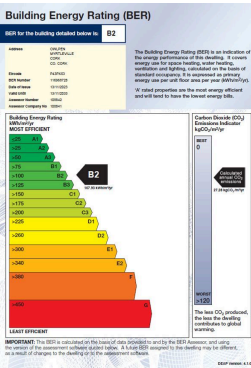

Impressive detached home in excellent decorative order with sea views

Distant Waves, Myrtleville, Cork, P43PX53



Enquire



Michael O'Donovan
Cork
+353 (0) 86 8205 474
Michael.odonovan@savills.ie

More Information



View on website



View Digital Brochure



Property Search

Viewing strictly by appointment

Property Ref: CKK230334

Cork

Penrose House, Penrose Dock, T23 V38E
+353 (0) 21 427 1371



Important Notice: Savills, its clients and any joint agents give notice that 1: They are not authorised to make or give any representations or warranties in relation to the property either here or elsewhere, either on their own behalf or on behalf of their client or otherwise. They assume no responsibility for any statement that may be made in these particulars. These particulars do not form part of any offer or contract and must not be relied upon as statements or representations of fact. 2: Any areas, measurements or distances are approximate. The text, photographs and plans are for guidance only and are not necessarily comprehensive. It should not be assumed that the property has all necessary planning, building regulation or other consents and Savills have not tested any services, equipment or facilities. Purchasers must satisfy themselves by inspection or otherwise. *powered by* **FluoPro**