

REV	DATE	DESCRIPTION	BY	CHKD
0	17.12.16	Issued for information	AIM R.Reidney	
			Dm: Chud/Agnie	

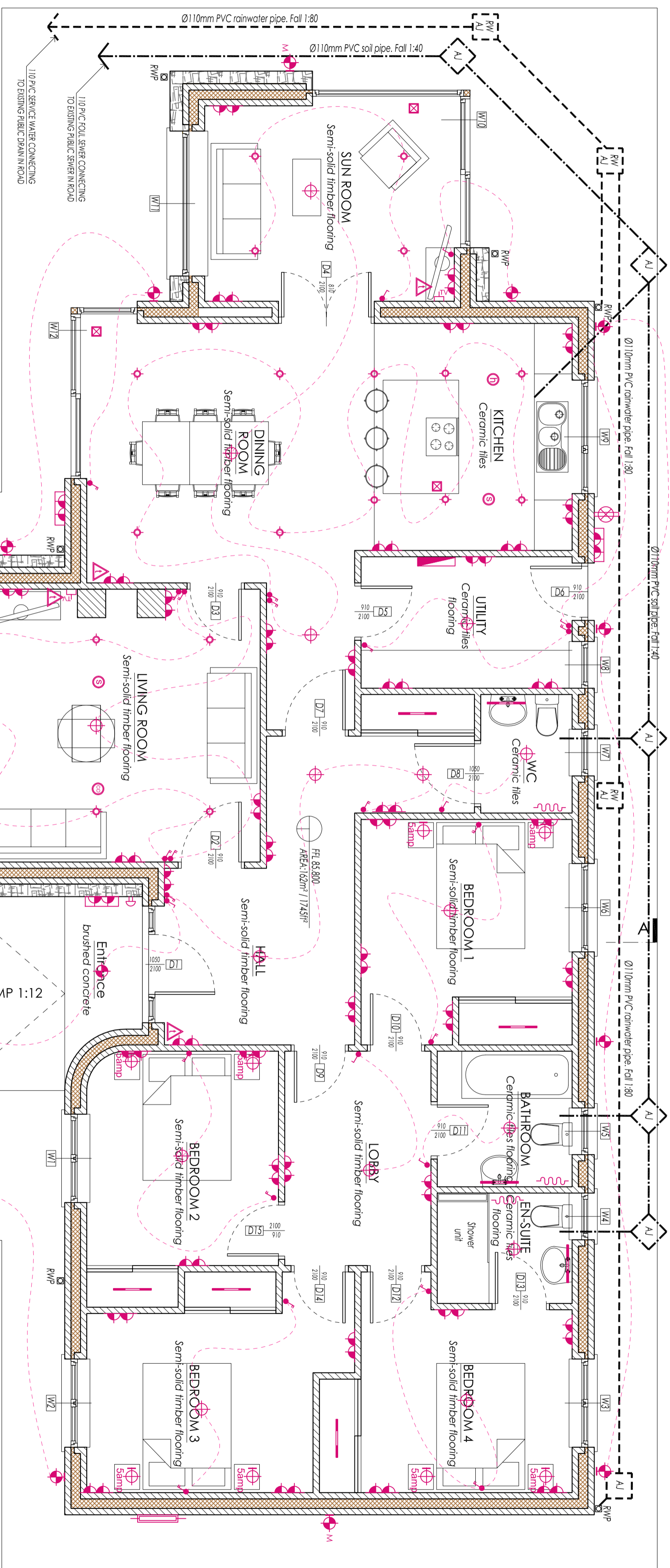

B

A

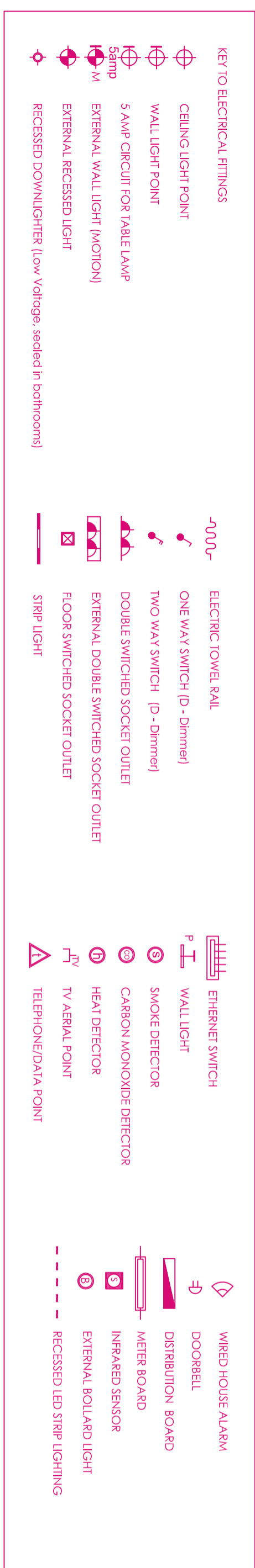

**Note: Refer to Engineers' drawings for foundation, steelwork, woodwork structure and retaining wall details and specifications.**

© The copyright of the drawing and designs contained therein remains vested in the Richard Rainey Architects. No part of this drawing is to be reproduced without written permission. This drawing is for planning permission purpose only and cannot be reproduced without written permission.

**RICHARD RAINEY ARCHITECTS**  
 71 Lower O'Connell Street, Kinsale, Co. Cork, Ireland.  
 Tel: (021) 477444 Fax: 086 855731 Email: oareich@richardrainey.com

**GENERAL SERVICES GF PLAN**

Project Name: **501**  
 Date: DEC 16  
 Scale: 1:500/A2  
 Drawing No: 501  
 Design By: AIM  
 Scale: 1:500/A2  
 Date: DEC 16  
 Scale: 1:500/A2

Entire ground levels to be fitted with underfloor heating system to specialist detail. Allow four or more for separate zones

Note: Mechanical ventilation, ducting and underfloor heating by integrated system NILON or similar