

For Sale

'Frenchlawn House' on c. 85.30 Acres,
Frenchlawn, Ballintober, Co. Roscommon.
F45 A021



Guide Price: €750,000

A rare opportunity to acquire a country residence with significant historical interest

The late Daniel O'Connell regularly stayed at 'Frenchlawn House', previously owned by his daughter Elizabeth (1810-1893) who married Nicholas Joseph French in 1831

The political significance of this residence includes a previous owner Mr. Terence Glancy, the First Secretary of Roscommon County Council in 1898. Another notable former resident of Frenchlawn is one Thomas Rogers, who emigrated to America pre Famine. The City of Rogers in Minnesota is named after Thomas, a visionary who kindly donated one acre of agricultural land that developed into a City of major importance today

This residence is in the ownership of the same family for over a century and while in need of renovation, 'Frenchlawn' holds much of its original features and is an ideal project for those interested in restoring to its former glory.

The approach to this historic residence is by entrance gates and sweeping tree lined driveway offering maximum privacy without impeding the unrivalled views of the lands/countryside to front.

The residence comprises entrance hall, living room, dining room and kitchen on ground floor with first floor comprising landing, three bedrooms (one en-suite) and bathroom. (Gross Internal Area c. 1,870 sq.ft)
Outbuildings include garage, coach house and granary with cut limestone and multiple arches

Located on the Roscommon/ Galway border and just 30 mins from Ireland West Airport Knock.

Viewing is strictly by appointment with Joint Selling Agents:

DNG Ivan Connaughton Tel: 090-6663700
DNG Country Homes and Estates (Gemma Lanigan) Tel: 01-4912600

Lot 1 – 'Frenchlawn House' & Outbuildings on c. 2.30 Acres

Lot 2 - c. 42.00 acres of prime lands

Lot 3 - c. 35.00 acres (across from residence)

Lot 4 - c. 6.00 acres with Derelict Residence (across from residence)

Lot 5 – Entire: Residence on c. 85.30 Acres

Entrance Hall

4.92m (16'2") x 3.5m (11'6")

Living Room

6.06m (19'11") x 3.63m (11'11")

Dining Room

6.11m (20'1") x 4.69m (15'5")

Kitchen

2.8m (9'2") x 3.97m (13'0")

Landing

4.46m (14'8") x 3.67m (12'0")

Bedroom

6.17m (20'3") x 3.88m (12'9")

En-Suite

2.58m (8'6") x 1.51m (4'11")

Bedroom

3.87m (12'8") x 4.66m (15'3")

Bedroom

2.15m (7'1") x 4.65m (15'3")

Bathroom

2.59m (8'6") x 5.27m (17'3")



'Frenchlawn House' on c. 85.30 Acres, Frenchlawn, Ballintober, Co. Roscommon. F45 A021



'Frenchlawn House' on c. 85.30 Acres, Frenchlawn, Ballintober, Co. Roscommon. F45 A021



'Frenchlawn House' on c. 85.30 Acres, Frenchlawn, Ballintober, Co. Roscommon. F45 A021



'Frenchlawn House' on c. 85.30 Acres, Frenchlawn, Ballintober, Co. Roscommon. F45 A021



'Frenchlawn House' on c. 85.30 Acres, Frenchlawn, Ballintober, Co. Roscommon. F45 A021



'Frenchlawn House' on c. 85.30 Acres, Frenchlawn, Ballintober, Co. Roscommon. F45 A021



'Frenchlawn House' on c. 85.30 Acres, Frenchlawn, Ballintober, Co. Roscommon. F45 A021



'Frenchlawn House' on c. 85.30 Acres, Frenchlawn, Ballintober, Co. Roscommon. F45 A021



'Frenchlawn House' on c. 85.30 Acres, Frenchlawn, Ballintober, Co. Roscommon. F45 A021



'Frenchlawn House' on c. 85.30 Acres, Frenchlawn, Ballintober, Co. Roscommon. F45 A021



'Frenchlawn House' on c. 85.30 Acres, Frenchlawn, Ballintober, Co. Roscommon. F45 A021

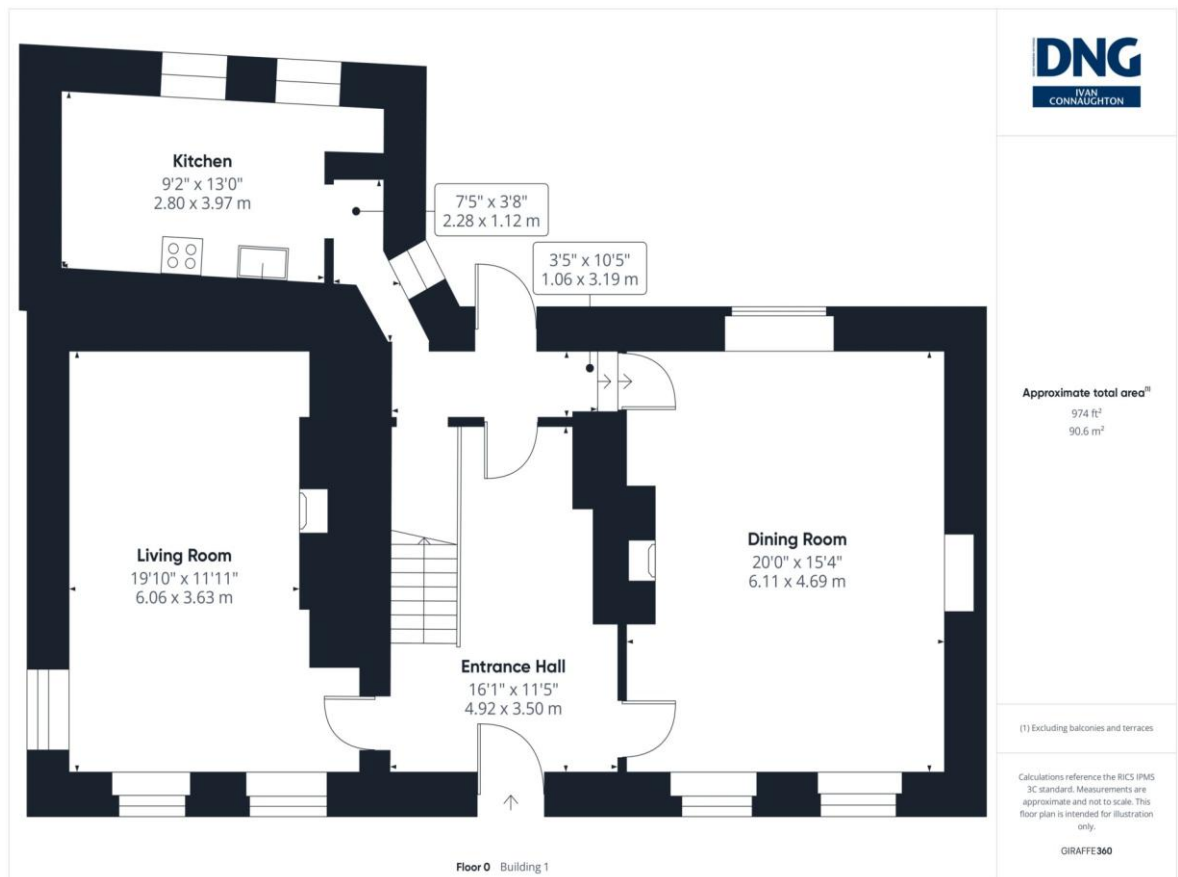

'Frenchlawn House' on c. 85.30 Acres, Frenchlawn, Ballintober, Co. Roscommon. F45 A021

