

# For Sale

Asking Price: €575,000

Sherry  
FitzGerald



1A Cross Avenue, Dun Laoghaire,  
Co. Dublin A96 X392



[sherryfitz.ie](https://sherryfitz.ie) - make and view offers 24/7

BER C3



24 HOUR ACCESS



SEARCH



BOOK VIEWINGS



MAKE OFFERS



### SPECIAL FEATURES

- Two bed 63sqm semi detached
- Charming home in heart of Dun Laoghaire
- Private bright, sun filled, low-maintenance courtyard spanning the full width of the home
- GFCH - BER C3 Built 1999
- Permit on street parking

### BER

BER C3, BER No. 105159768  
Energy Performance Indicator: 217.77

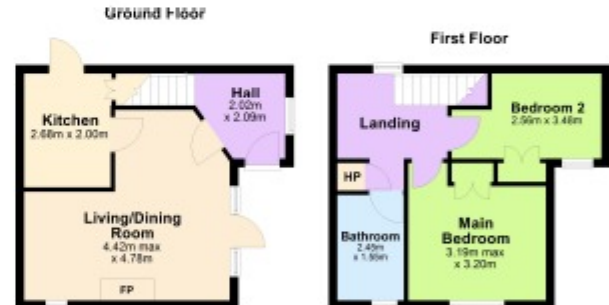

### NEGOTIATOR

Pippy Proger  
Sherry FitzGerald  
35 George's Street Upper  
Dun Laoghaire Co. Dublin  
A96 NW94  
T: 012844422  
M: 0873328328  
E: pippy.proger@sherryfitz.ie

### MORTGAGE ADVICE

For mortgage advice talk to  
Tara Cassidy  
T : 0874451212  
M: 0874451212  
E: tara.cassidy@sherryfitz.ie

sherryfitz.ie