

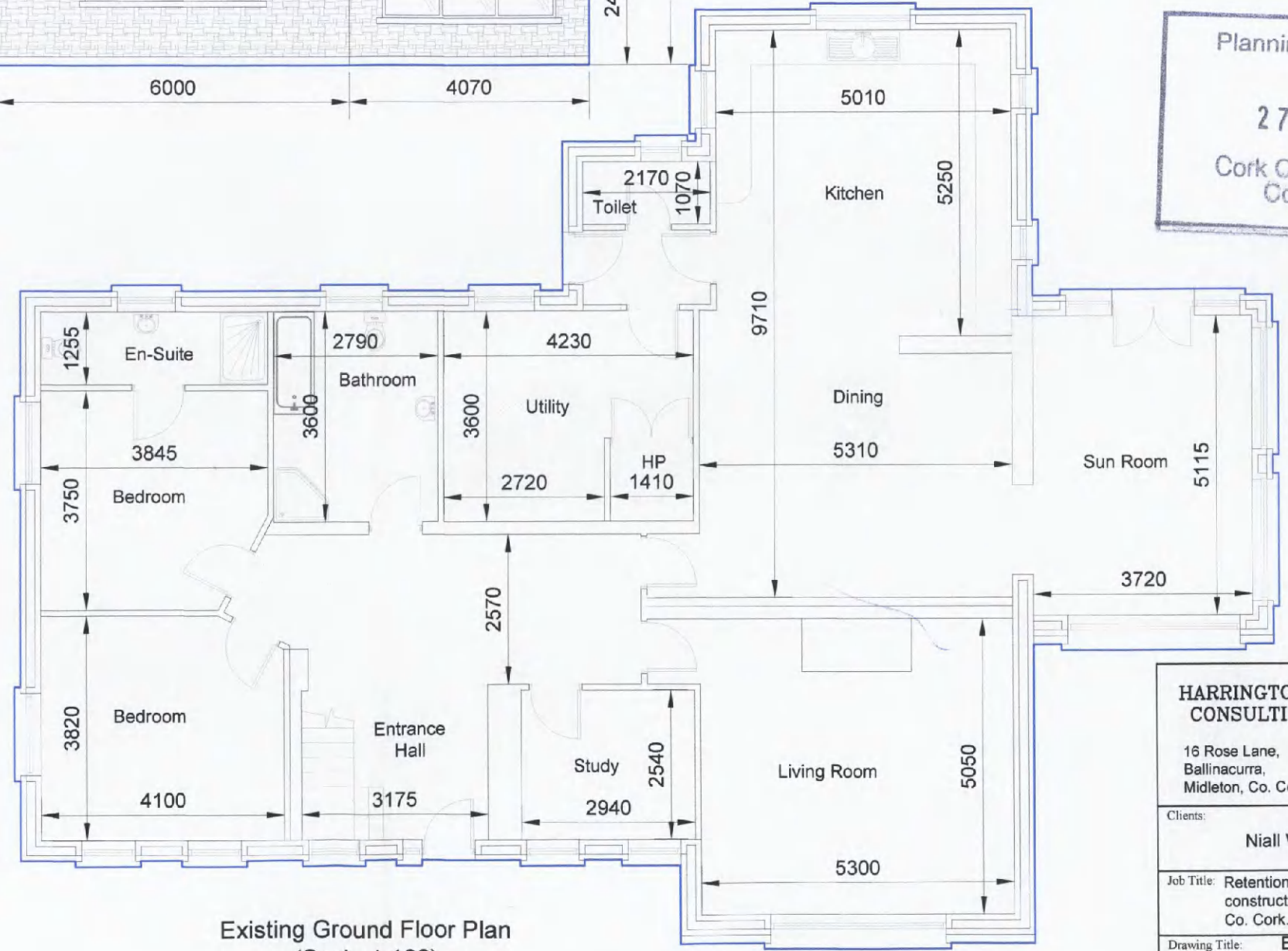

175613-27/06/2017-Existing Ground Floor



Existing Front Elevation
(Scale 1:100)



Existing Ground Floor Plan
(Scale 1:100)

Existing Finishes:

- Blue/black roof slates.
- White upvc windows and doors.
- Medium texture sand & cement render to front, rear & side of dwelling.
- Natural stone to section of front elevation.
- Smooth plaster plinth.
- White upvc fascia, soffit and rainwater goods.

Existing Floor Areas

Ground Floor Area	= 206.1 sq.m
First Floor Area	= 166.7 sq.m
Modified Attic Space Floor Area	= 43.5 sq.m
Total Existing Floor Area	= 416.3 sq.m

Planning Department
 27 JUN 2017
 Cork County Council
 County Hall
 Cork.

**HARRINGTON O'FLYNN LTD
CONSULTING ENGINEERS**

16 Rose Lane, Tel: 021-4636760
 Ballinacurra, Fax: 021-4636701
 Middleton, Co. Cork. Email: hofce@eircom.net

Clients:
Niall Wiseman

Job Title: Retention of dwellinghouse and garage as constructed at Kilboy, Ballyfeard, Carrigaline, Co. Cork.

Drawing Title: Existing Ground Floor Plan & Existing Front Elevation

Drawing Scale: 1:100 Date: June 2017

Drawing Number: NW-PP-01 Drawing Issue: Planning

Drawn By: PH Checked By: HOF