

JOB: Proposed Housing development of 61 No dwellings		
TITLE: Site Layout Plan		
CLIENT: Liam Carey Homes Ltd. (t/a Carey Homes)		
ADDRESS: Killea Road, Dunmore East, Co. Waterford		
DWN BY: Gráinne Daly	PROJECT NO.: 2846-18	DWG. NO.: 01A
SCALE: 1:1000	DATE: May 2018	
A 02-08-18 Layout altered to Further Info. request from planning		
Rev.	Date.	Description.

Extract from O.S. Map No. 5918-C

61 No. Houses;
13 No. 4-bed
44 No. 3-bed
4 No. 2-bed

Site Area = 27,523 sq.m.
(exclud. poss.new road area)
30,890 sq.m.
(including new road)

=P.O.S. AREAS
P.O.S. = 5790sq.m =18.74%
(min 15% required)



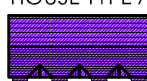
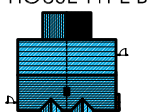
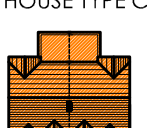

22 No visitor parking spaces
(Min. 16 No. required)

EXISTING DITCH RETAINED &
REINFORCED WITH INDIGENOUS
PLANTING IF NECESSARY

HOUSING LEGEND

- HOUSE TYPE A**
 2-BED TERRACED
4 No. Units - TYPE A
on sites 30-33
- HOUSE TYPE B & B1**
 3-BED SEMI-DETACHED
44 No. Units - TYPE B
2 No. Units - TYPE B1
(on sites 29 & 61 only)
- HOUSE TYPE C & C1**
 4-BED SEMI-DETACHED
13 No. Units - TYPE C & C1
7 No. type C
6 No. type C1
(on sites 1,8,16,17, 47& 48)

BOUNDARY WALL LEGEND

-  2.1m HIGH 100mm THK. POINTED & CAPPED CONC. BLOCK WALL, PLASTERED WHERE FACING PUBLIC AREAS.
-  1.8m HIGH CONC. POST & TIMBER FENCE/PANEL
-  CONC. KERB GARDEN DIVIDERS
-  900mm HIGH CONC. BLOCK WALL, PLASTERED & CAPPED BOTH SIDES
-  600mm HIGH DRY STONE WALL, BOTH SIDES, WITH STONE CAPPING.

SITE NOTICE FIXED AT FRONT OF SITE NEAR ROADSIDE EDGE

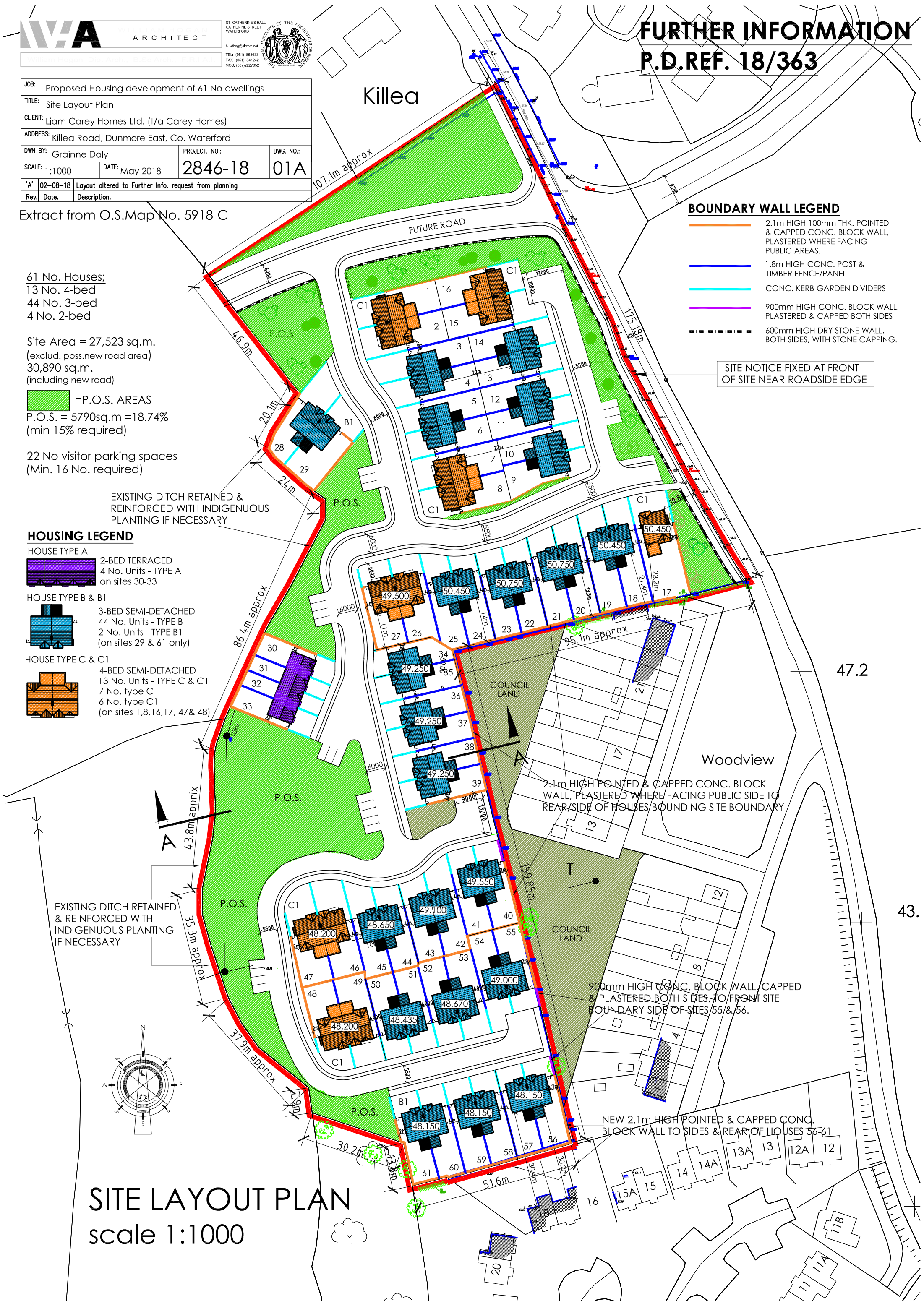

SITE LAYOUT PLAN
scale 1:1000