

# For Sale

Asking Price: €195,000

Sherry  
FitzGerald  
O'Neill



50 Bridge Street, Skibbereen,  
Co Cork, P81 EH50

**BER** -exempt

[sherryfitz.ie](http://sherryfitz.ie)



Traditional Commercial and Residential Premises with garden to rear and enjoying an excellent location on Skibbereen's main thoroughfare.

Substantial 3 storey building. The premises have a useable floor area of 1,885 sq. ft. approx.

Ideal for Commercial, Investment, Family Home or a mix of uses.

- Ground Floor: 862 square feet approx. laid out in 3 spacious rooms.
- First Floor: 687 square feet approx. laid out in 2 adaptable rooms and a bathroom.
- Second Floor: 335 square feet approx. laid out as one large adaptable room.

The premises was previously laid out as retail / commercial on ground floor and 2 upstairs apartments.

Excellent town centre opportunity with garden to rear and is available with vacant possession.

Ideal for the creative buyer to maximise use and potential.



GROUND FLOOR  
862 sq.ft. (80.1 sq.m.) approx.

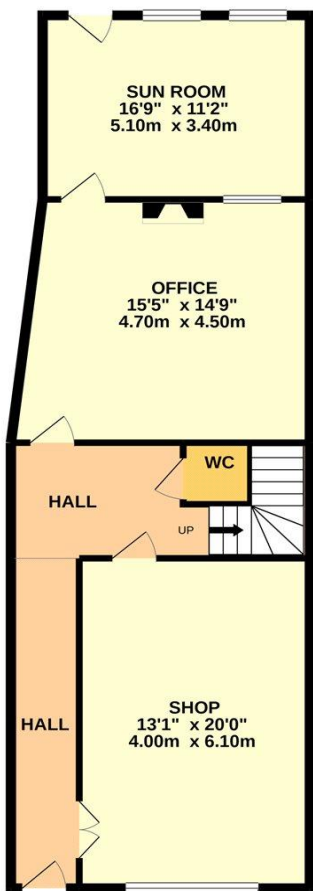

1ST FLOOR  
687 sq.ft. (63.9 sq.m.) approx.



2ND FLOOR  
335 sq.ft. (31.1 sq.m.) approx.

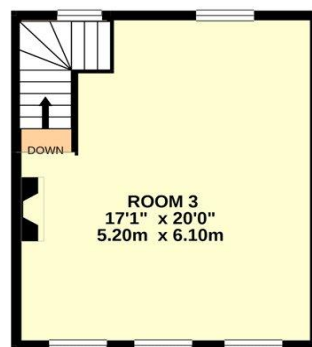

TOTAL FLOOR AREA : 1885 sq.ft. (175.1 sq.m.) approx.

Whilst every attempt has been made to ensure the accuracy of the floorplan contained here, measurements of doors, windows, rooms and any other items are approximate and no responsibility is taken for any error, omission or mis-statement. This plan is for illustrative purposes only and should be used as such by any prospective purchaser. The services, systems and appliances shown have not been tested and no guarantee as to their operability or efficiency can be given.  
Made with Metropix ©2020





#### NEGOTIATOR

Niamh Moloney  
Sherry FitzGerald O'Neill  
37 North Street,  
Skibbereen, Co Cork  
T: 028 21404  
E: info@sfoneill.ie

#### VIEWING

Strictly by prior appointment

#### ENERGY RATING

BER Exempt

[sherryfitz.ie](http://sherryfitz.ie)

[sfoneill.ie](http://sfoneill.ie)

[myhome.ie](http://myhome.ie)

[daft.ie](http://daft.ie)

[rightmove.co.uk](http://rightmove.co.uk)

**CONDITIONS TO BE NOTED:** A full copy of our general brochure conditions can be viewed on our website at <http://www.sherryfitz.ie/terms>, or can be requested from your local Sherry FitzGerald office. We strongly recommend that you familiarise yourself with these general conditions. While care has been taken to ensure that information contained in Sherry FitzGerald publications is correct at the time of publication, changes in circumstances after the time of publication may impact on the accuracy of this. PSRA Registration No. 004158