



LOFTUS HALL

FETHARD-ON-SEA, CO. WEXFORD Y34 YC93

Approx. 68 ACRES



From Legend to Luxury.

Loftus Hall's stunning transformation into a world-class 22-room hotel is just the beginning.



THE PROPERTY

Loftus Hall is a large, partly re-furbished country house which was built on the site of the original Redmond Hall.

The property boasts one of the most scenic locations in the southeast with views over Hook Peninsula and the world famous Hook Lighthouse, providing the most stunning landscape. The building itself is steeped in history and reputed by locals to be the most haunted mansion in Ireland.

The property was purchased by the Quigley family in 2011 and run as a tourist attraction with guided tours of the property and seasonal events. In 2021 the property was bought by its current owners who had a masterplan to refurbish the original building over two phases. The estate has already undergone extensive renovations, with Phase 1 nearing completion, set to transform the property into an exclusive 22-bedroom luxury hotel with high-end amenities, extensive food and beverage facilities, and beautifully landscaped gardens. The vision for Phase 2, included an additional 56 bedroom hotel block, a gym and spa, dedicated wedding facilities, 33 standalone garden cottages and 10 eco pods strategically placed along the perimeter of the property.

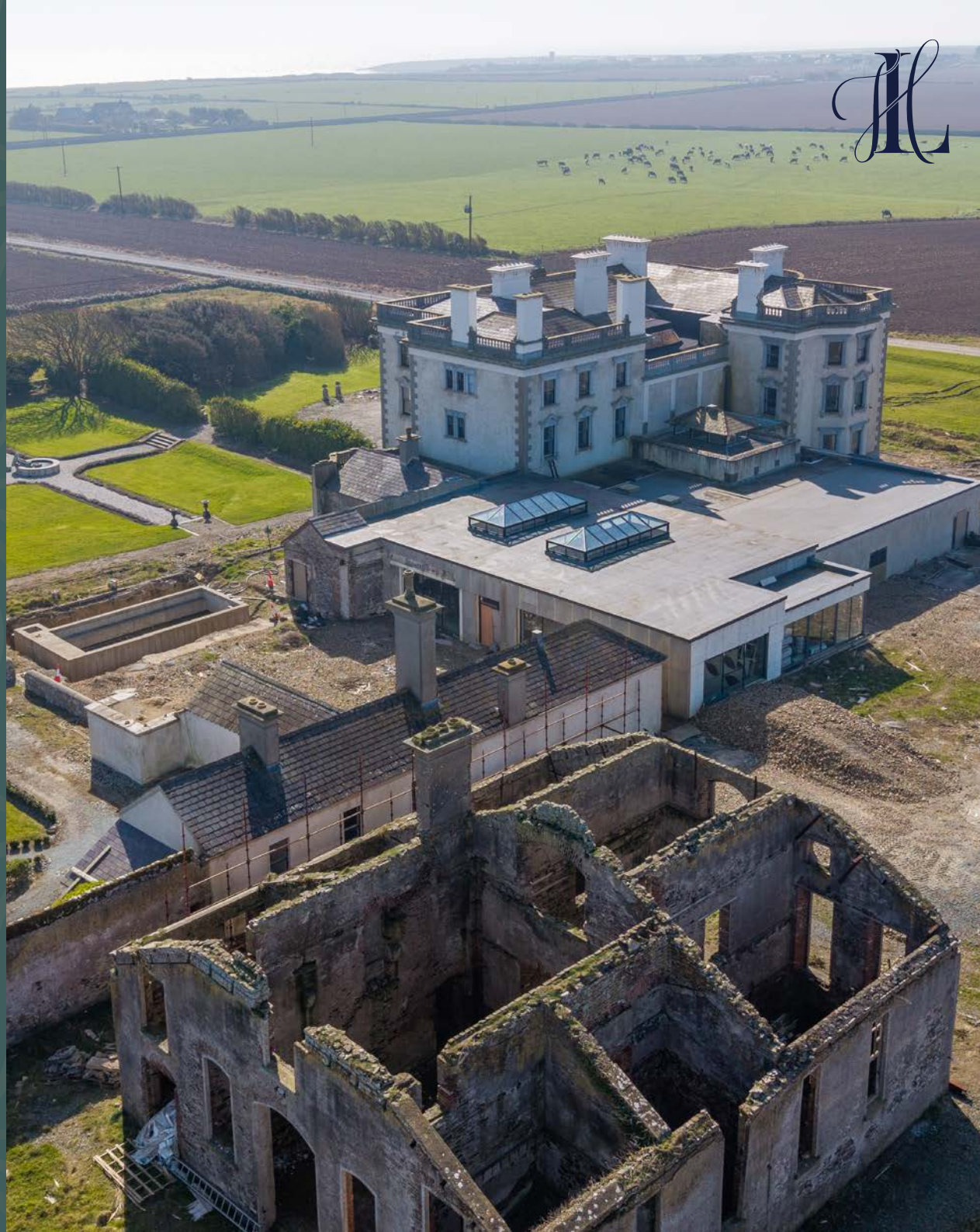



NEARBY TOURIST DESTINATION

Hook Lighthouse is close to the subject property and marks the entrance to Waterford Harbour where the Barrow, Nore and Suir rivers meet. It is one of the oldest lighthouses and reputedly is the oldest operating lighthouse in the world. It is operated by the Commissioners of Irish Lights, the Irish Lighthouse Authority and the current structure has stood for 850 years. It should be noted that Hook Lighthouse is in the top 10 Irish Tourist attractions and receives visitors annually in the region of 200,000 people.

HISTORY

Loftus Hall has a rich history of ownership, transitioning from a private residence to landlords, an order of nuns, and eventually a hotel.

Between 1872 and 1884, John Henry Wellington Graham Loftus, the 4th Marquess of Ely (1849-1889), guided by his mother Lady Jane Hope Vere Loftus (a Lady in Waiting to Queen Victoria), undertook a significant renovation of the mansion. This renovation introduced many notable features, including the grand staircase, mosaic tiled floor, intricate parquet flooring, and advanced technical elements that were unprecedented in Irish homes at the time. Much of Lord Ely's inspiration came from Osborne House, Queen Victoria's summer residence on the Isle of Wight. The extensive renovations were believed to be in preparation for a visit from the Queen, which ultimately never occurred. Sadly, the family never fully enjoyed the house, as the 4th Marquess died young without an heir, leaving the estate in financial trouble. His cousin eventually put the mansion, described as a three-storey, non-basement building with nine bays and a balustraded parapet, on the market. In 1917, the Sisters of Providence purchased Loftus Hall, converting it into a convent and school for young girls aspiring to join the order. In 1983, Michael Devereaux bought the property and reopened it as "Loftus Hall Hotel," which later closed in the late 1990s. In 2011, the property was acquired by the Quigley Family and opened to the public as a tourist attraction centred on its ghostly reputation.

ACCOMMODATION

Main House

Built originally on the site of Redmond Hall, which traces its history to 1850, Loftus Hall comprises a detached nine-bay, three storey house. The estate is situated on approximately 27.68 hectares (68 acres) with the house extending to a total gross internal area (GIA) of 2,460 sq.m (26,480 sq. ft). Loftus Hall is a protected structure under RPS Ref WCC0692 and under the NIAH Ref 15705401.

The estate has already undergone extensive renovations, with Phase 1 nearing completion. The ground floor of the original building has been transformed to contain a large dining room, a cigar room and a number of guest lounge areas. When completed the restaurant will seat over 100 covers which will feature visibility of the chefs working with an open pass, an outside BBQ area and fire pit adjacent to the new restaurant area with the existing bar fully refurbished. The hotel bedrooms are finished to second fix over the first and second floors and are appointed with large ensuite bathrooms and with commanding and sweeping views out to sea.

The vision for Phase 2 consists of the development of a permanent marquee erected on the grounds which will cater for up to 300 seated wedding guests, a gym & spa, a new hotel bedroom block which will contain up to 56 additional bedrooms, 33 standalone garden cottages, 10 eco pods wrapped around the perimeter of the property, a children's playground, a herb and vegetable garden, over two hundred car park spaces in total between the front and rear of the development and a walkway that will allow guests to access the beach directly from the development.

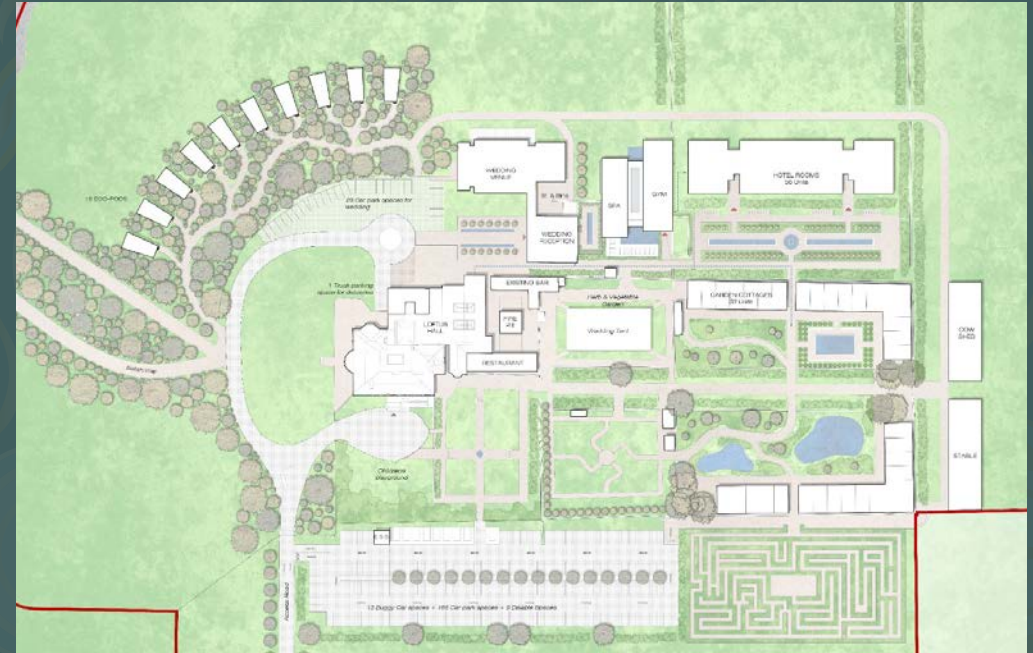

CGI Images



The Grounds

The grounds are a feature of Loftus Hall and have been maintained to the highest standards throughout the refurbishment.

The gardens at Loftus Hall, particularly the walled garden, were designed to thrive in the unique climate of the Hook Peninsula. The garden's high walls provided a sheltered environment, allowing a variety of plants to flourish.

Fruit trees were a significant feature, with mulberry trees being particularly successful. The sheltered environment also supported other fruit trees like apple and pear. Additionally, the garden likely included a variety of herbs and vegetables, which were essential for the estate's kitchen.

The garden's design and plant selection reflect the practical needs and aesthetic preferences of the time, creating a space that was both beautiful and functional.



LOFTUS HALL

WATERFORD



Hook
Lighthouse

LOCATION

Loftus Hall is located on the southern tip of Hook Peninsula, close to the famous Hook Lighthouse, one of the oldest operational lighthouses in the world.

Loftus Hall offers an unparalleled location for exploring the beauty and history of County Wexford. Just 4km from the iconic Hook Lighthouse, 33km from the vibrant town of New Ross, 45km from Wexford and 51km from Waterford. The property is also in close proximity to several popular tourist destinations, including Passage East (17km) and Dunmore East (30km) and the charming nearby villages such as Hookless Village, Slade, and Fethard-On-Sea, all within easy access.

Dublin City is just a two hour drive, at 178km and the main motorway access points to Dublin are either the M9 or the M11.





FEATURES

- Spacious partly restored period mansion house
- Extensive site area of approximately 68 acres
- Magnificent sea views with access to private beach
- Close proximity to Hook Lighthouse
- Beautiful walled gardens
- Enormous potential to expand as per Phase 2

SERVICES

- **ESB** | Full upgrade of supply to the property with 80kVA allowance
- **Mains Water** | Two water supplies to the property
- **Gas** | Storage tank for supply to the building
- **Heating** | Plumbed for electric central heating system

PRICE GUIDE

On Application

VIEWING

Strictly by prior appointment

BER

Exempt

DATA ROOM

<https://loftushall.co.uk>
Available upon request

CONTACT

Gillian Earley

+353 87 965 4555

Gillian.Earley@colliers.com

Marcus Magnier

+353 86 255 5161

Marcus.Magnier@colliers.com



Hambleden House
19-26 Lower Pembroke Street
Dublin, D02 WV96
+353 1 633 3700
PSRA Licence Number 001223

colliers.ie

Colliers Ireland and the Vendor/Lessor give note that the particulars and information contained in this brochure do not form any part of any offer or contract and are for guidance only. The particulars, descriptions, dimensions, references to condition, permissions or licences for use or occupation, access and any other details, such as prices, rents or any other outgoings are for guidance only and are subject to change. Maps and plans are not to scale and measurements are approximate. Whilst care has been taken in the preparation of this brochure intending purchasers, Lessees or any third party should not rely on particulars and information contained in this brochure as statements of fact but must satisfy themselves as to the accuracy of details given to them. Neither Colliers nor any of its employees have any authority to make or give any representation or warranty (express or implied) in relation to the property and neither Colliers nor any of its employees nor the vendor or lessor shall be liable for any loss suffered by an intending purchaser/ Lessees or any third party arising from the particulars or information contained in this brochure. Prices quoted are exclusive of VAT (unless otherwise stated) and all negotiations are conducted on the basis that the purchasers/lessees shall be liable for any VAT arising on the transaction. This brochure is issued by Colliers on the understanding that any negotiations relating to the property are conducted through it.