

For Sale

Asking Price: €370,000



5 Saunders Lane
Rathnew
County Wicklow
A67 CP82

--View & Make offers directly on [MySherryFitz.ie](https://www.MySherryFitz.ie)--

BER C1

[MySherryFitz.ie](https://www.MySherryFitz.ie)





This wonderful family home comes to the market in exceptional condition and beautifully decorated throughout. Located within a small cul de sac in this lovely residential development, No. 5 benefits from an open aspect to the front with large green area and country views.

Within the property, you will be struck by the space and quality on offer - from the spacious sitting room to the front, to the wonderful family kitchen and sunroom to the rear.

A house of this quality is sure to appeal to all and viewing is highly recommended.

Ring our team on (0404) 66466 if you want to know more or schedule a viewing!

#sherryfitz #forsale #residential
#sherryfitzgeraldcatherineoreilly #realestate #newlisting
#MoreThanAgents #IrishProperty #House



Special Features & Services:

-

Accommodation:

Entrance Hall 4.87 x 4.09: Lovely bright hallway with polished porcelain tiled flooring and ample under stairs storage.

Guest Wc 1.80 x 1.41: With white porcelain tiled flooring, laundry area plumbed for washing machine and tumble dryer, fitted with wc and whb.

Kitchen/Dining Room 2.97 x 5.59: A beautiful spacious kitchen come dining area with large white porcelain tiled flooring, the modern kitchen is complete with a fine selection of floor and eye level units and integrated appliances.

Living Room 3.66 x 4.10: A bright front facing living room with large bay window, oak flooring and gas fire set into stone surround.

Sun Room 4.21 x 3.02: Second reception room to the rear with access from the kitchen. This lovely room provides a wonderful space to relax, with garden views and tasteful decoration throughout. Velux windows within the solid roof allow for additional light and, for cosy winter evenings, the solid fuel stove and tv point ensure this room will be used year round.

Bedroom 1 2.97 x 4.42: A pretty Master bedroom with oak flooring, fitted wardrobes and views to rear.

Ensuite 1.80 x 1.85: With tiled flooring and partly tiled walls, fitted with whb, wc and enclosed shower area.

Bathroom 1.86 x 2.21: Family bathroom with tiled floor and part tiled walls featuring wc whb bath with shower

Garden:

BER: BER C1, BER No. 108788043

Directions:

A67 CP82



Ground Floor

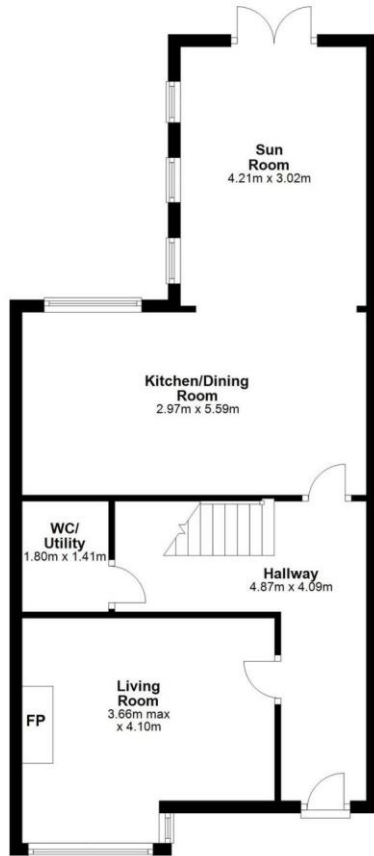

First Floor

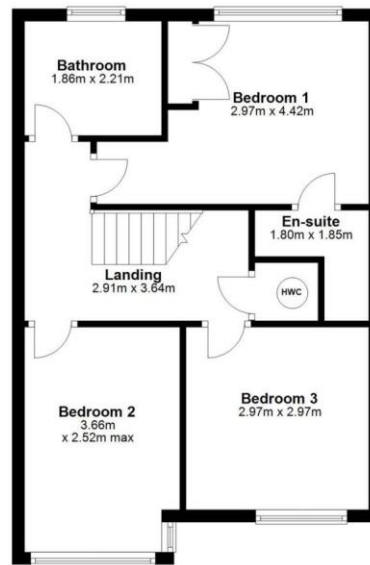

NEGOTIATOR

Sherry FitzGerald Catherine O'Reilly
1 Bridge Street Arcade, Fitzwilliam Square,
Wicklow Town

0404 66466
info@sfcatherineoreilly.ie

MySherryFitz.ie



CONDITIONS TO BE NOTED: A full copy of our general brochure conditions can be viewed on our website at <http://www.sherryfitz.ie/terms> or can be requested from your local Sherry FitzGerald office. We strongly recommend that you familiarize yourself with these general conditions.
PSRA Registration No. 003161