

For Sale

Asking Price: €195,000

Sherry
FitzGerald
O'Neill



50 Bridge Street, Skibbereen, Co Cork.
P81 EH50

BER -exempt

sherryfitz.ie



Traditional Commercial and Residential Premises with garden to rear and enjoying an excellent location on Skibbereen's main thoroughfare.

Substantial 3 storey building. The premises have a useable floor area of 1,885 sq. ft. approx.

Ideal for Commercial, Investment, Family Home or a mix of uses.

The ground floor consists of 862 sq. ft. approx., laid out in 3 spacious rooms. The first floor is laid out in 2 adaptable rooms and a bathroom and measures 687 sq. ft. approx. On the third floor there is one large adaptable room, 335 sq. ft. approx.

The premises was previously laid out as retail / commercial on the ground floor with 2 upstairs apartments.

Excellent town centre opportunity with garden to rear and is available with vacant possession. 50 Bridge Street is ideal for the creative buyer to maximise use and potential.



GROUND FLOOR
862 sq.ft. (80.1 sq.m.) approx.

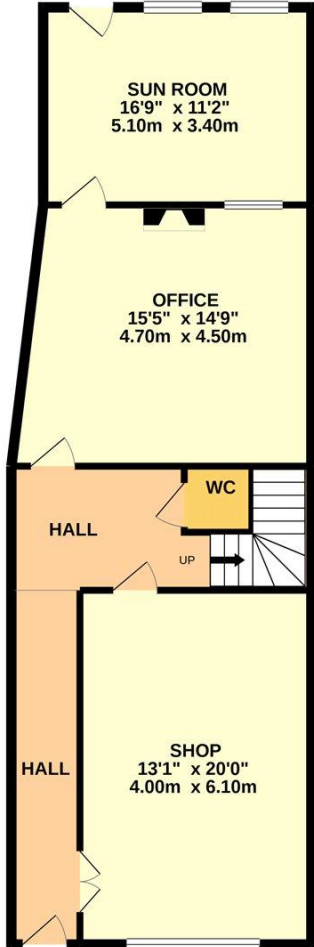

1ST FLOOR
687 sq.ft. (63.9 sq.m.) approx.



2ND FLOOR
335 sq.ft. (31.1 sq.m.) approx.

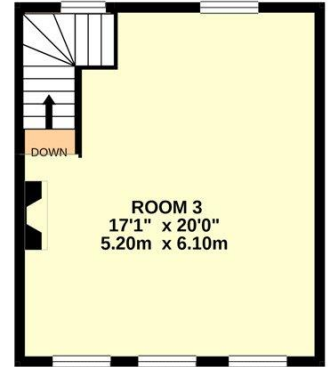

TOTAL FLOOR AREA : 1885 sq.ft. (175.1 sq.m.) approx.

Whilst every attempt has been made to ensure the accuracy of the floorplan contained here, measurements of doors, windows, rooms and any other items are approximate and no responsibility is taken for any error, omission or mis-statement. This plan is for illustrative purposes only and should be used as such by any prospective purchaser. The services, systems and appliances shown have not been tested and no guarantee as to their operability or efficiency can be given.
Made with Metropix ©2020



NEGOTIATOR
Niamh Moloney
Sherry FitzGerald O'Neill
37 North Street, Skibbereen
Co Cork
T: 028 21404
E: info@sfoneill.ie

VIEWINGS
Strictly By Appointment Only

ENERGY RATING
BER: Exempt

sherryfitz.ie
sfoneill.ie
myhome.ie
daft.ie
rightmove.co.uk

CONDITIONS TO BE NOTED: A full copy of our general brochure conditions can be viewed on our website at <http://www.sherryfitz.ie/terms>, or can be requested from your local Sherry FitzGerald office. We strongly recommend that you familiarise yourself with these general conditions. While care has been taken to ensure that information contained in Sherry FitzGerald publications is correct at the time of publication, changes in circumstances after the time of publication may impact on the accuracy of this. PSRA Registration No. 004158