



# THE CARRIAGE SHED

Horgan's Quay, Cork

To Let

savills

ACCOMMODATION

OPTION 1 ENTIRE	THE CARRIAGE SHED GIA
Ground Floor Retail	Approx 10,533.65 sq ft GIA
First Floor Retail	Approx 7,772 sq ft GIA

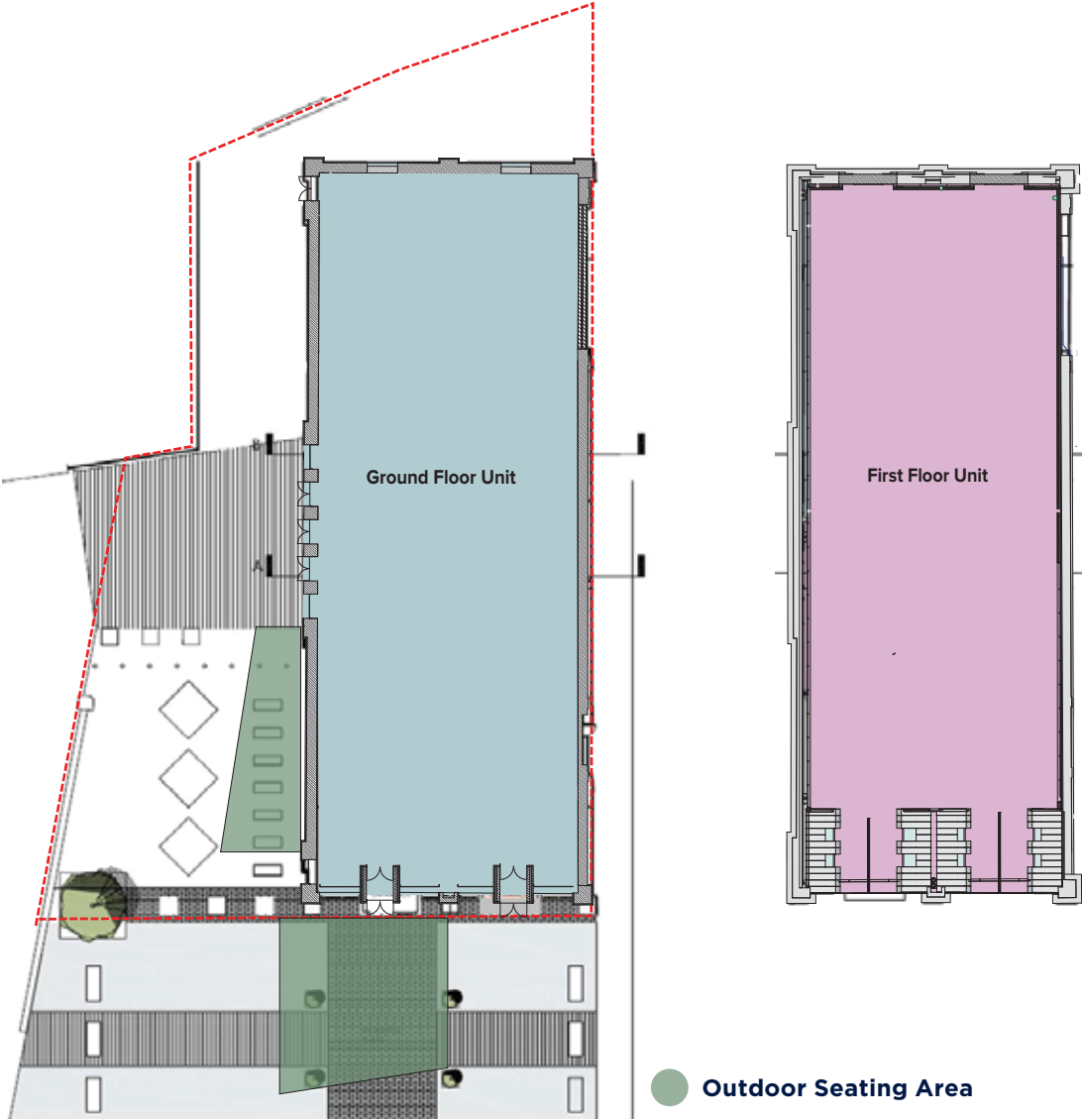

GROUND FLOOR RETAIL

FIRST FLOOR RETAIL



ACCOMMODATION

LEVEL	UNIT	AREA SQ. M NIA	AREA SQ. FT
Ground Floor	Unit 1	201	2,163.56
Ground Floor	Unit 2	245	2,637.18
Ground Floor	Unit 2a	488	5,252.83
Mezzanine	Upper Unit 1	242	3,046.21
Mezzanine	Upper Unit 2	347	3,444.48

- Circulation
- Void
- Unit 1
- Unit 2
- Unit 2a
- Upper Unit 1
- Upper Unit 2

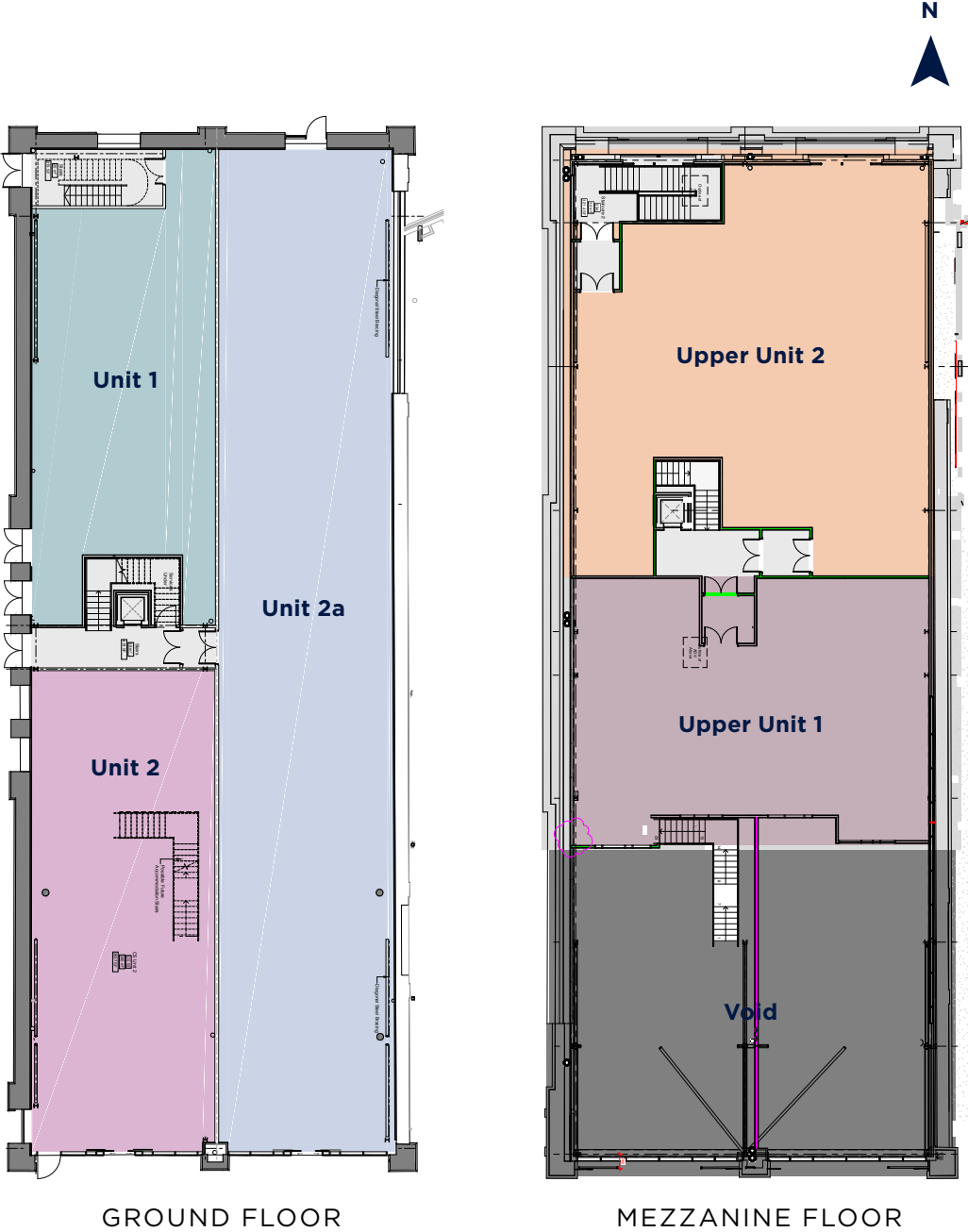

## HQ CORK

One of Ireland's most significant and exciting urban redevelopments. Spanning 6 acres along the River Lee, the development includes three LEED Gold Standard office blocks which when fully completed will accommodate over 3,600 people. No 1 Horgan's Quay is fully constructed and has various tenants in place, No 2 Horgan's Quay is currently under construction which will provide an additional 128,000 sq ft of Grade A office space. The planned construction of over 300 apartments are also included within the development. The fully occupied adjoining Penrose Dock office development has also seen an influx of approx. 2,400 people to the area since its completion. The Horgan's Quay site's rich history dates back to the 1800s when the Great Southern & Western Railway Station first opened there.

## PRIME LOCATION

The prime location of the Carriage Shed provides unrivaled access with vast appeal to residents, global firms and promising start-ups. HQ Cork is located less than 500 meters from the city's central bus terminus and is directly served by local and mainline trains via Kent Station. The site lies just a 15 minute drive to Cork airport - the country's second largest airport with domestic and international connections daily.

## THE CARRIAGE SHED

The Carriage Sheds date back to the 1850s and were designed by Sir John Benson, Joshua Hargrave and John Bagnell. These limestone buildings are now the centre focus of the Horgan's Quay development and are fully integrated into this significant urban scheme. The two Carriage Sheds form a potential retail/restaurant space with ground and first floor accommodation and extensive outdoor seating.

## CONTACT

For further information please contact:

### **Peter O'Meara**

021 490 6122  
peter.omeara@savills.ie

### **Lia Dennehy**

021 490 6122  
lia.dennehy@savills.ie

**savills**

11 South Mall,  
Cork

021 427 1371

**savills.ie**

PSRA No: 002233

### **IMPORTANT NOTICE**

Savills Ireland give note that the particulars and information contained in this brochure do not form any part of any offer or contract and are for guidance only. The particulars, descriptions, dimensions, references to condition, permissions or licences for use or occupation, access and any other details, such as prices, rents or any other outgoings are for guidance only and are subject to change. Maps and plans are not to scale, and measurements are approximate. Whilst care has been taken in the preparation of this brochure intending purchasers, lessees or any third party should not rely on particulars and information contained in this brochure as statements of fact but must satisfy themselves as to the accuracy of details given to them. Neither Savills Ireland nor any of its employees have any authority to make or give any representation or warranty (express or implied) in relation to the property and neither Savills Ireland nor any of its employees nor the vendor or lessor shall be liable for any loss suffered by an intending purchaser/lessee or any third party arising from the particulars or information contained in this brochure. Prices quoted are exclusive of VAT (unless otherwise stated) and all negotiations are conducted on the basis that the purchasers/lessees shall be liable for any VAT arising on the transaction. This brochure is issued by Savills Ireland on the understanding that any negotiations relating to the property are conducted through it. All maps produced by permission of the Ordnance Survey Ireland Licence No AU 001799 © Government of Ireland.

