

For Sale

Asking Price: €175,000

**Sherry
FitzGerald**
O'Donovan



Liss, Araglen,
Co. Cork.
P61 V212

sherryfitz.ie



Set in a scenic location surrounded by rolling countryside, this charming three-bedroom farmhouse offers the perfect blend of rural tranquillity and exciting potential.

The property features one reception room and a kitchen, along with 3 bedrooms. The property sits on approx. 0.4 of an acre and has benefitted from new windows and doors and a refurbishment internally.

Conveniently located just 16 km from Fermoy town and only 18 km from the picturesque town of Lismore, you'll find all amenities close at hand, including schools, shops, pharmacy, church, pubs and takeaways. The Knockmealdown Mountains & River Blackwater are also nearby, providing endless opportunities for outdoor enthusiasts.



BER BER Exempt

Special Features & Services

- Scenic country location
- Approximately 0.4 of an acre
- Recently refurbished internally
- Easy commute of Lismore/Fermoy

Accommodation

Entrance Hall	1.02m x 0.95m (3'4" x 3'1"):
Kitchen/Dining Room	5.14m x 3.59m (16'10" x 11'9"):
Sitting Room	4.34m x 2.93m (14'3" x 9'7"):
Bedroom 1	4.34m x 2.79m (14'3" x 9'2"):
Office/Bed 2	3.22m x 2.32m (10'7" x 7'7"):
Bedroom 3	3.22m x 2.30m (10'7" x 7'7"):
Bathroom	3.97m x 1.63m (13' x 5'4"):

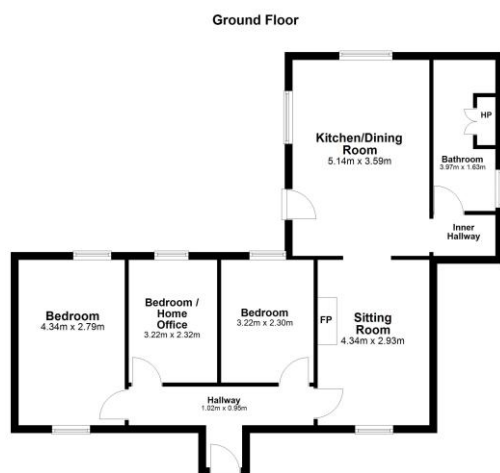

Total area: approx. 75.1 sq. metres
Liss, Araglin





NEGOTIATOR

Donal Barry MIPAV
Sherry FitzGerald O'Donovan
2 Waterside, Ashe Quay, Fermoy,
Co Cork
T: 025 32725
E: fermoy@sfod.ie

SOLICITOR

sherryfitz.ie

CONDITIONS TO BE NOTED: A full copy of our general brochure conditions can be viewed on our website at <http://www.sherryfitz.ie/terms>, or can be requested from your local Sherry FitzGerald office. We strongly recommend that you familiarize yourself with these general conditions.

PSRA Registration No 003457