

# For Sale

Asking Price: €95,000

Sherry  
FitzGerald  
O'Neill



Urhan, Eyeries, Beara,  
Bantry, Co. Cork, P75 RD73.



[sherryfitz.ie](https://sherryfitz.ie)



Coastal, detached, traditional farmhouse, having an exceptional scenic location and is ideal for a restoration project. The property benefits from stunning sea views of the Atlantic Ocean and is located in a rural setting between the Beara villages of Eyeries and Allihies, along the West Cork segment of the Wild Atlantic Way.

The house is a stone / masonry and slated structure with an attached shed and additional separate detached stone outbuilding.

The accommodation measures 52.8 sq.m. / 568 sq.ft. approx and comprises of a kitchen and living room on the ground floor and 2 double bedrooms on the first floor.

The grounds measure 0.2 acres approx. and require landscaping.

Eyeries is a multi award-winning village and is just a short drive away. The shops, cafes, pubs, colourful street scape, gardens and play area add to the ambience of this unique West Cork location.

The Beara Peninsula is renowned for its walking trails along the Wild Atlantic Way that take in many historical and archaeological sites. The Beara Peninsula's principal town, Castletownbere, is just a 15 minute drive away and is one of Europe's premier hubs for fishing fleets. The waters around the Harbour are ideal for sailing and fishing enthusiasts.



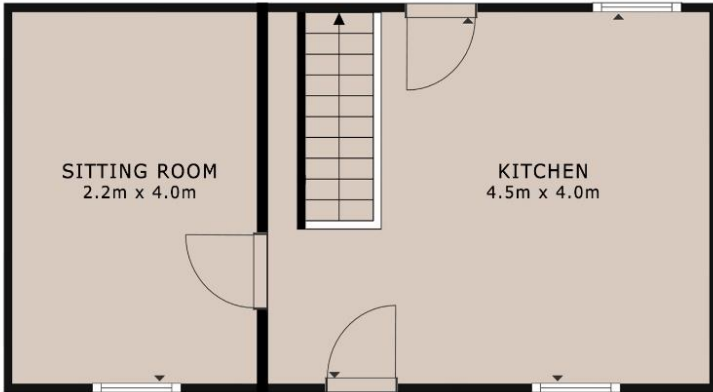

FLOOR 1

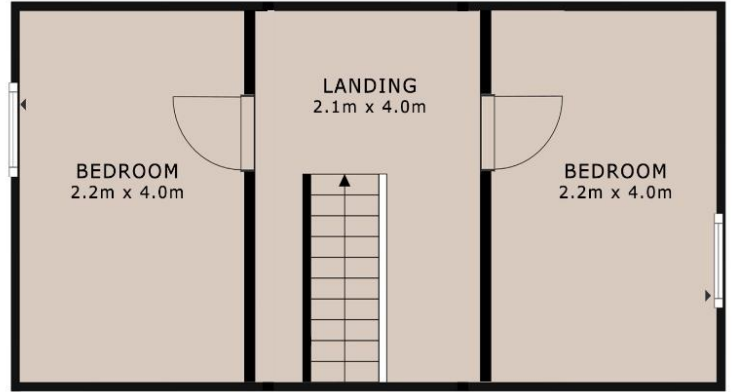

FLOOR 2

GROSS INTERNAL AREA

TOTAL : 52.80 m<sup>2</sup>

Whilst every attempt has been made to ensure the accuracy of the floor plan contained here, measurements of doors, windows, rooms and any other items are approximate and no responsibility is taken for any error, omission, or misstatement. This plan is for illustrative purposes only and should be used as such by any prospective purchaser.



**NEGOTIATOR**

Olivia Hanifan,  
Sherry FitzGerald O'Neill,  
Wolfe Tone Square, Bantry,  
Co. Cork.  
T: 027 31030  
E: info@sfoneill.ie

**VIEWINGS**

Strictly By Appointment Only

**ENERGY RATING**

BER: G  
Cert No.: 117241075  
EPI: 558.33 kWh/m<sup>2</sup>/yr

[sherryfitz.ie](http://sherryfitz.ie)  
[sfoneill.ie](http://sfoneill.ie)  
[myhome.ie](http://myhome.ie)  
[daft.ie](http://daft.ie)

---

**CONDITIONS TO BE NOTED:** A full copy of our general brochure conditions can be viewed on our website at <http://www.sherryfitz.ie/terms>, or can be requested from your local Sherry FitzGerald office. We strongly recommend that you familiarise yourself with these general conditions. While care has been taken to ensure that information contained in Sherry FitzGerald publications is correct at the time of publication, changes in circumstances after the time of publication may impact on the accuracy of this. PSRA Registration No. 004158