

NOTE A: ESB METER BOX:

- METER CABINET TO ESI STANDARD 12-3 (1986) TO BE INSTALLED (606mm H X 402mm W X 155mm D)
- SERVICE DUCTING TO BE INSTALLED AT A MINIMUM DEPTH OF 600mm & ENTER THE BUILDING THROUGH AN ESB APPROVED HOCKEY STICK WITHIN THE CAVITY OF THE BUILDING.
- HOCKEY STICK TO EXTEND 25mm INTO THE BASE OF THE ESB METER BOX.
- WARNING TAPE REQUIRED IN TRENCHING AT A DEPTH OF 300mm BELOW GROUND LEVEL.
- BOTTOM OF METER BOX TO BE BETWEEN 1000mm & 1200mm FROM THE EXTERNAL FINISHED LEVEL.
- ESBN CABLES TO ENTER THE METER BOX VIA THE BOTTOM LEFT HAND SIDE **ONLY**
- CUSTOMERS FEED & ASSOCIATED WORKS BY OTHERS

NOTE B: ETU UNIT(S):

- IP66 RATED EXTERNAL JUNCTION BOX WITH DIMENSIONS 150mm W X 230mm H X 150mm D
- THE DUCTING MUST BE LAID IN A TRENCH MINIMUM 400mm BELOW GROUND LEVEL - PROTECTIVE MEASURES REQUIRED IF MINIMUM COVER NOT ACHIEVED.
- WARNING TAPE REQUIRED IN TRENCHING AT HALF THE TRENCH DEPTH
- A NUMBER OF SMALL HOLES ARE TO BE DRILLED INTO THE DUCT AT LOW POINTS TO AVOID A BUILD-UP OF MOISTURE.
- SERVICES PIPES TO ENTER THE HOUSE VIA THE CAVITY VIA A HOCKEY STICK (PE) 50/45mm OD/ID
- CUSTOMERS FEED & ASSOCIATED WORKS BY OTHERS

WINDOW LEGEND:

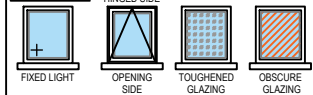

LEGEND:

--- = MASONRY REINFORCEMENT - BUILT INTO MINIMUM 2 COURSES.

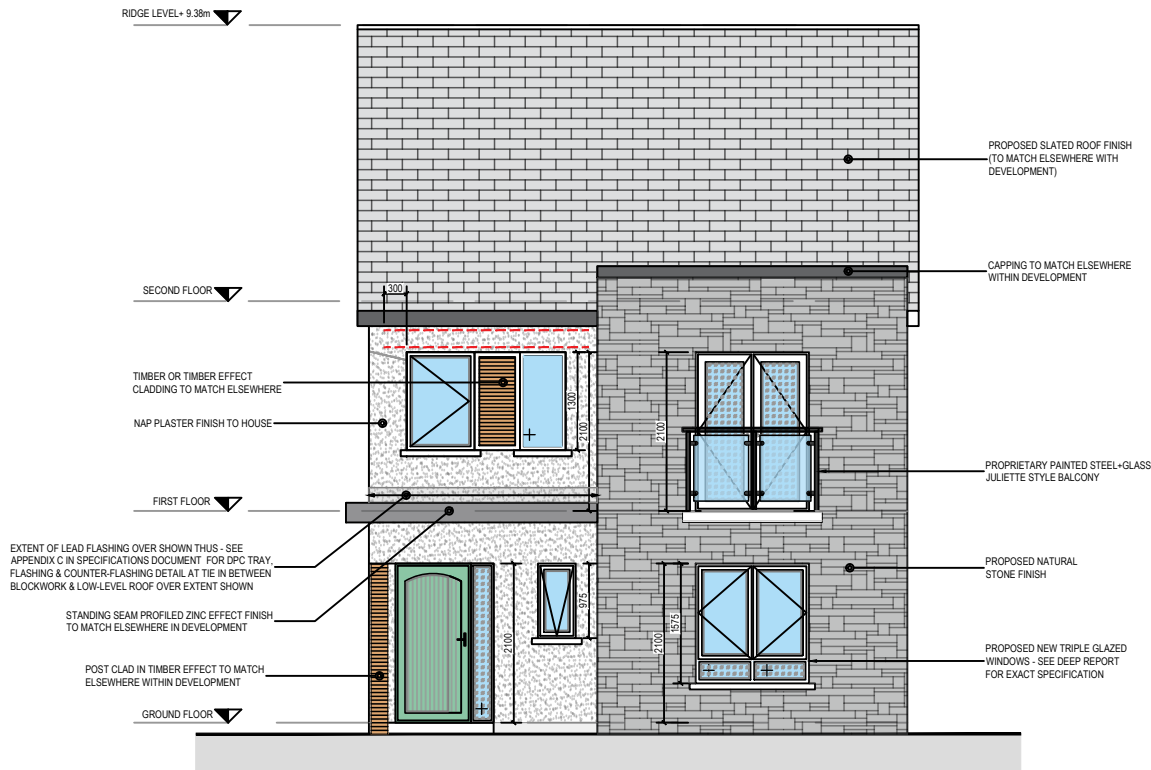

FRONT ELEVATION  
Scale 1:100

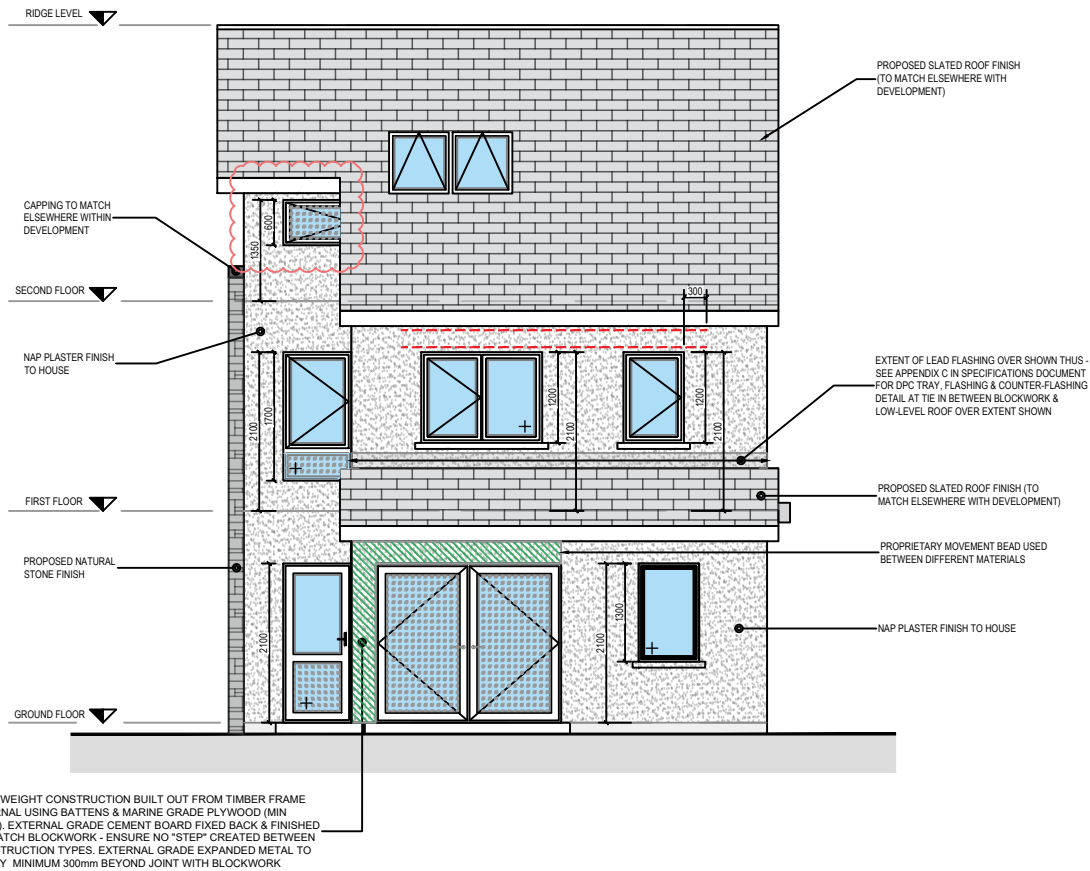

REAR ELEVATION  
Scale 1:100

NOTES:

- THIS DRAWING IS THE PROPERTY OF DFCE. IT IS A CONFIDENTIAL DOCUMENT AND MUST NOT BE COPIED, USED, OR ITS CONTENT DIVULGED WITHOUT PRIOR CONSENT.
- ALL WORKS TO COMPLY WITH THE BUILDING REGULATIONS AND THE BUILDING CONTROL ACT 2014, CURRENT IRISH STANDARDS AND CODES OF PRACTICE.
- DO NOT SCALE, ALL DIMENSIONS TO BE CHECKED ON SITE AND ANY DISCREPANCIES TO BE NOTIFIED TO ARCHITECT / ENGINEER.
- ALL CONTRACTORS, WHETHER MAIN OR SUB CONTRACTORS MUST VISIT THE SITE AND ARE RESPONSIBLE FOR TAKING AND CHECKING ANY AND ALL DIMENSIONS AND LEVELS THAT RELATE TO THE WORKS.
- WHERE THIS DRAWING CONTAINS DISCREPANCIES IN RELATION TO OTHER RELEVANT DOCUMENTS, SUCH DISCREPANCIES SHALL BE BROUGHT TO THE ATTENTION OF THE ARCHITECTS / ENGINEERS WHO SHALL ISSUE A WRITTEN INSTRUCTION AS TO WHICH INFORMATION IS TO BE FOLLOWED, AND UNTIL SUCH INSTRUCTIONS HAS BEEN ISSUED ANY WORK CARRIED OUT ON FOOT OF THE DISCREPANCIES SHALL BE UNAUTHORISED.
- PROPRIETARY ITEMS SHALL BE FIXED IN STRICT ACCORDANCE WITH MANUFACTURER'S INSTRUCTIONS.

Construction

Rev	Date	Dwn	Amendment / Issue	App
C02	26/11/2019	JG	Construction	JG
C01	14/11/2019	DBE	Construction	JG
D02	14/11/2019	DBE	Draft Issue	JG

Client:

Agrimac Contracts Ltd.

Project:

Coill Ard, Moycullen, Co Galway

Drawing:

House Type G -  
Proposed Elevations (Sheet 1 of 2)

Drawn By:	G1930BU0013	Rev:	C02
Drawn By:	DBE	Checked By:	JG
		Date:	November 2019



T: +353 (0)1 539 4100 (Dublin)  
T: +353 (0)11 380 792 (Galway)  
M: +353 (0)86 859 1904  
E: info@falloneng.com  
W: www.falloneng.com

Address (Dublin):  
Lia Cara Business Centre,  
51-52 Fitzwilliam Square West,  
Dublin 2.

Address (Galway):  
Office 27 Calbro Court,  
Tuam Road, Galway.

Scale:

1:100 on A3