

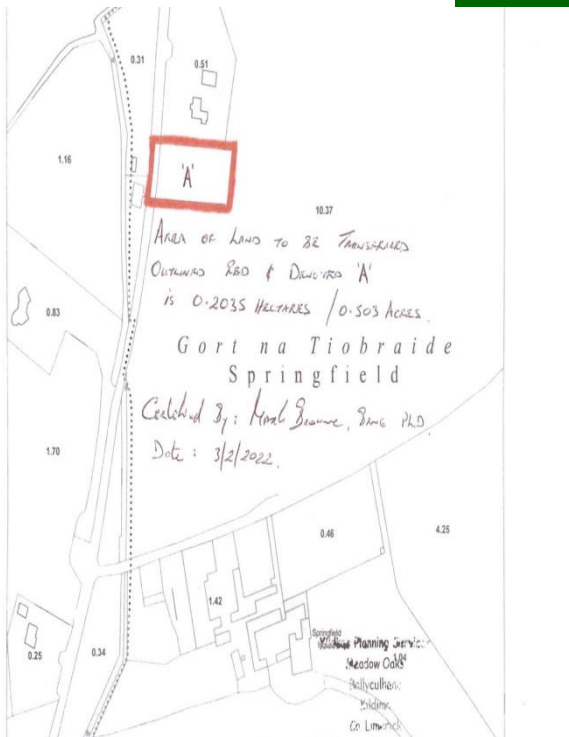

Springfield, Sixmilebridge, Co. Clare



Price on Application



For Sale by Private Treaty. Prime site extending to Circa 0.5 st acre for sale subject to planning permission in this superb location. Occupancy restrictions in this area so an applicant(s) must fulfil the local planning criteria. There is water and ESB adjacent. Just 20 minutes` drive from Limerick City, Shannon Airport and Ennis. Easy access to both Sixmilebridge and the picturesque and thriving tourist village of Bunratty which is home to a number of excellent restaurants and pubs, serving up delicious local cuisine and traditional Irish music. The nearby Dromoland Golf Club is a popular destination for golf enthusiasts, offering a challenging 18-hole course set against a stunning backdrop of rolling hills and lush greenery.

For those who enjoy outdoor activities this site is ideally located for exploring the surrounding countryside together with providing ample opportunities for fishing, boating, and water sports.

Excellent local schools and sporting amenities. So why not take advantage of this fantastic opportunity to purchase a wonderful in this beautiful location and start building your dream home today.

<

Features:

- Option to purchase additional lands to extend the site would be considered
- Renowned local walkways
- Ideal for those seeking country style living
- Located only a short distance from the popular tourist village of Bunratty
- Water and ESB adjacent
- Just 15 minutes drive to both Shannon Airport and Limerick City



Property Directions:

Travelling from Sixmilebridge proceed out the main Shannon Road R471 turn right just before Maxol Service Station. Proceed for 1/2 a kilometer. Site located on right hand side. GVM sign thereon.

Agent Information:

Contact :- john O Connell Mobile :- 087-6470746

Email johnoconnell@gvm.ie

Disclaimer

These particulars do not form any contract and are for guidance purposes only. Computer generated images, maps and plans are not drawn to scale and measurements are approximate and for guidance only. Intending purchasers must satisfy themselves as to the accuracy of detail given to them verbally or as part of this brochure. Such information is given in good faith and believed to be correct. However neither the vendor nor their agents shall be held liable for any inaccuracies therein.

Limerick Office

25-26 Glentworth St,
Co. Limerick,
V94WE12

Phone: (061)413522

Email: limerick@gvm.ie

Kilmallock Office

Head Office,
Railway Road,
Kilmallock,
Co. Limerick

Phone: (063)98555

Email:
kilmallock@gvm.ie

Tullamore Office

GVM Mart,
Arden Road,
Tullamore,
Co. Offaly

Phone: (057)9321196

Email:
tullamoreproperty@gvm.ie



PSRA Number: 002030