

Building Regulations

WHERE CILL LEVELS ARE LESS THAN 800MM ABOVE THE FLOOR LEVEL, EITHER GUARDING MUST BE PROVIDED OR TOUGHENED GLASS IN ACCORDANCE WITH THE REQUIREMENTS OF BS6262 pt4 MAY BE USED

GLAZING AT CRITICAL LOCATIONS TO BE TOUGHENED AND IN ACCORDANCE WITH THE REQUIREMENTS OF BS6262 pt4 (TGD K BUILDING REGULATIONS 1997)

DOORS TO HABITABLE ROOMS MUST HAVE A CLEAR OPENING WIDTH OF: (TGD M BUILDING REGULATIONS 2000): 750MM IF CORRIDOR IS 1200MM WIDE, 775MM IF CORRIDOR IS 1050MM WIDE, 800MM IF CORRIDOR IS 900MM WIDE

AN LD3 TYPE FIRE ALARM SYSTEM SHOULD BE PROVIDED AND INSTALLED IN ACCORDANCE WITH THE REQUIREMENTS OF BS 5839 pt6 1995 (TGD B BUILDING REGULATIONS 1997)

AIRTIGHTNESS TO BE ACHIEVED IN ACCORDANCE WITH REQUIREMENTS OF CURRENT BUILDING REGULATION REQUIREMENTS PARTICULAR ATTENTION TO BE PAID TO THE FITTING OF THE KINGSPAN K17 BOARD INTERNALLY, SEALING AROUND ALL EDGES AND WINDOWS IN ACCORDANCE WITH MANUFACTURERS RECOMMENDATIONS.

MECHANICAL VENTILATION MUST BE EMPLOYED IN AREAS PRONE TO CONDENSATION, i.e. KITCHENS, BATHROOMS AND SANITARY ACCOMODATION (TGD F BUILDING REGULATIONS 2002)

INSULATION USED THROUGHOUT THE DWELLING MUST COMPLY WITH THE NEW BUILDING REGULATIONS AS SET OUT IN TGD L - CONSERVATION OF FUEL AND ENERGY, DWELLING, BUILDING REGULATIONS 2002 & 2007

DOOR HANDLES AND ELECTRIC LIGHT SWITCHES SHOULD BE LOCATED AT A HEIGHT OF 900MM TO 1200MM ABOVE INTERNAL FLOOR LEVEL.

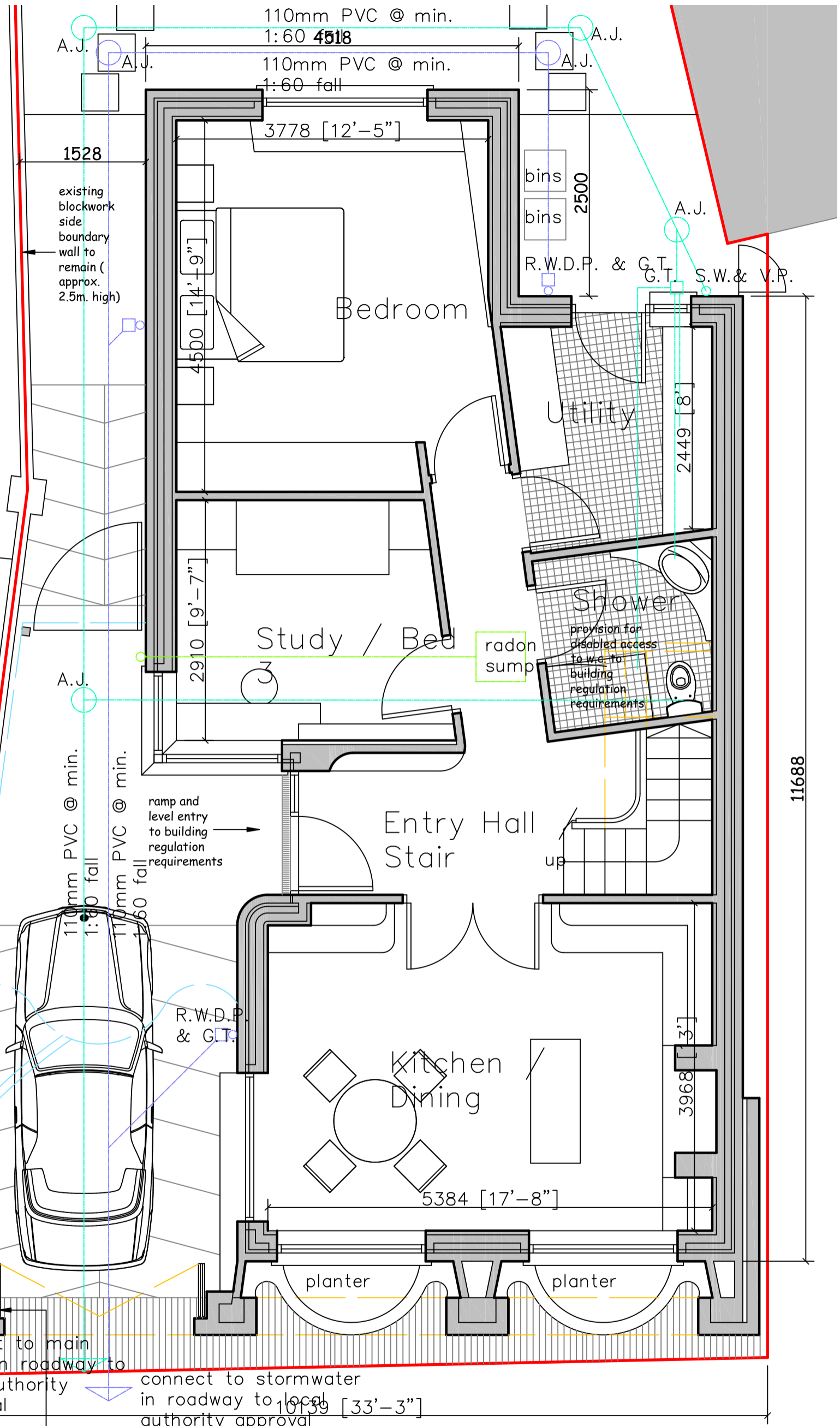

GROUND FLOOR PLAN
Ground Floor Area 70 sq. m.

bi-fold hot dip galvanised steel gates to later detail fitted in entrance archway

<p><i>Proposed Two Storey Dwelling for Patrick Landers at Strandside South, Abbeyside, Dungarvan, Co. Phortlairge.</i></p>		<p>Ailtire Architectural Services</p>
<p>Title GROUND FLOOR PLAN Date 14/11/12 Scale 1:50 Drawn M.K. Revisions Issued for: PLANNING</p>		
<p>Leigh, Ring, Co. Waterford, Tel 058-46498 email: ailtire@indigo.ie</p>		<p>Drwg. No. 002</p>