

A renovated period house offering
wonderful coastal views

Ballylawn, Moville, Co. Donegal, F93 H7YA



A renovated period house offering wonderful coastal views

Ballylawn, Moville, Co. Donegal, F93 H7YA

savills



A renovated period house offering wonderful coastal views

Ballylawn, Moville, Co. Donegal, F93 H7YA



About this property

Ballylawn is a charming 3-bedroom semi-detached home located on the scenic Inishowen Peninsula. Originally built in 1909, the property has been thoughtfully refurbished and renovated in both 2004 and 2022, blending modern comforts with classic charm. Set across two floors, the home takes full advantage of its stunning views over the Donegal coastline.

Upon entering through a traditional half door, you are welcomed into a cosy porch leading into the bright and inviting living room. This space features a wood-burning stove and is designed to allow in lots of natural light. The living room seamlessly flows into an open-plan kitchen and dining area, with the kitchen offering fully-fitted wall and floor units. A separate WC completes the ground floor accommodation.

The dining area opens out to a lean-to, which serves as a covered terrace and features both a wood burning stove and a hot tub, providing a perfect space for relaxation.

The first floor comprises three spacious double bedrooms. The master bedroom boasts breathtaking views of the coastline, along with an ensuite and a dressing room.

Ballylawn extends to approximately 1,062 sq ft (98 sq m) with a full layout shown on the adjoining floorplans.

Outbuildings

To the rear of the house is a garden shed.

Gardens & Grounds

Directly behind the house is a lawned garden area and a decking. To the front of the house is a driveway and parking area to the front of the house.

A renovated period house offering wonderful coastal views

Ballylawn, Moville, Co. Donegal, F93 H7YA



A renovated period house offering wonderful coastal views

Ballylawn, Moville, Co. Donegal, F93 H7YA



Plans

 1,062 sq ft

Ballylawn

Approximate Gross Internal Area = 98.7 sq m / 1062 sq ft

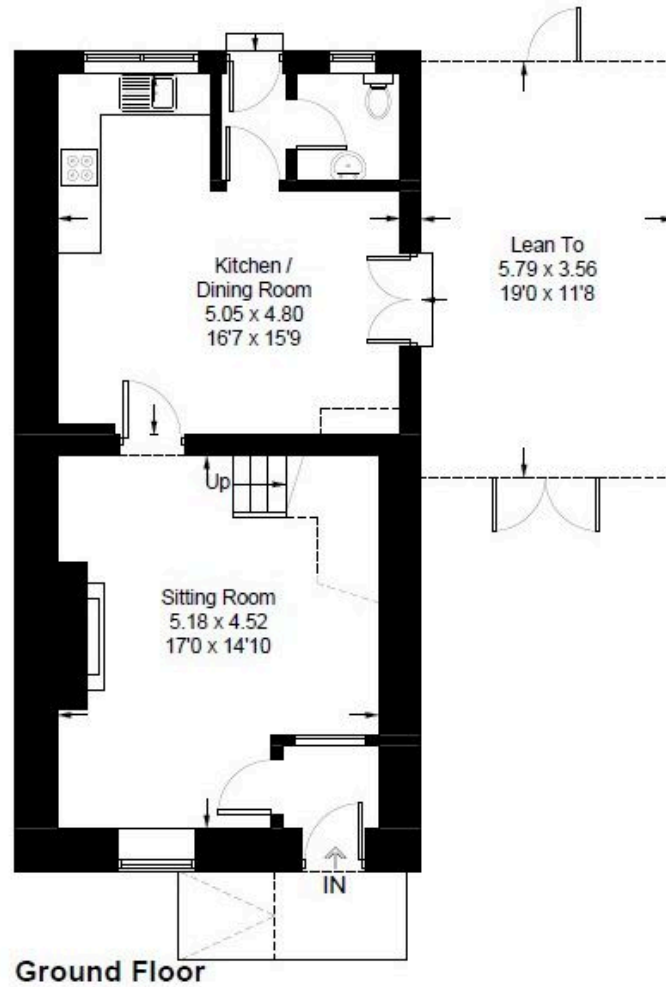

A renovated period house offering wonderful coastal views

Ballylawn, Moville, Co. Donegal, F93 H7YA

savills



Local Area

County Donegal is located on the north westerly tip of Ireland and is considered one of Ireland's most beautiful and unspoilt counties which is renowned for its history, heritage and landscape. Donegal is typified by its dramatic towering sea cliffs, rolling lush hills and stunning beaches. The house is situated on the Inishowen peninsula, which is the beginning of the Wild Atlantic Way and is also Ireland's largest peninsula.



A renovated period house offering wonderful coastal views

Ballylawn, Moville, Co. Donegal, F93 H7YA



Property Details

Key Features

- 3 bedrooms
- Semi-detached
- Spacious open-plan living accommodation
- Garden area
- Moville 3 km, Greencastle 6.5 km, Derry/Londonderry 29 km

Services & Additional Information

OFCH

BER

BER Rating = N/A

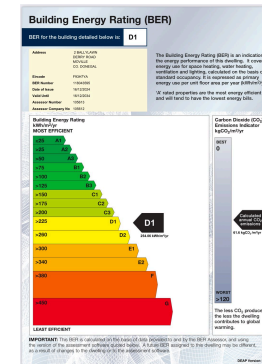

A renovated period house offering wonderful coastal views

Ballylawn, Moville, Co. Donegal, F93 H7YA



Enquire



Liam McCarthy

Dublin - Country

+353 83 878 4989

liam.mccarthy@savills.ie

More Information



[View on website](#)



[View Digital Brochure](#)



[Property Search](#)

Viewing strictly by appointment

Property Ref: DUY240216

Residential & Country

33 Molesworth Street, D02 CP04

+353 (0) 1 618 1300



Important Notice: Savills, its clients and any joint agents give notice that 1: They are not authorised to make or give any representations or warranties in relation to the property either here or elsewhere, either on their own behalf or on behalf of their client or otherwise. They assume no responsibility for any statement that may be made in these particulars. These particulars do not form part of any offer or contract and must not be relied upon as statements or representations of fact. 2: Any areas, measurements or distances are approximate. The text, photographs and plans are for guidance only and are not necessarily comprehensive. It should not be assumed that the property has all necessary planning, building regulation or other consents and Savills have not tested any services, equipment or facilities. Purchasers must satisfy themselves by inspection or otherwise. *powered by* **FluoPro**