

A spectacular, private and unique  
coastal property.

Roslynagh Lodge, Ardagh, Newport, Co. Mayo





A spectacular, private and unique coastal property.

Roslynagh Lodge, Ardagh, Newport, Co. Mayo





A spectacular, private and unique coastal property.

Roslynagh Lodge, Ardagh, Newport, Co. Mayo



## About this property

Roslynagh Lodge is one of the finest contemporary Residence ever to be offered for sale in this area. A stunning location, a striking house and extraordinary attention to detail create this coastal property jewel. Designed by an award winning architect strongly influenced by the surrounding built environment, Roslynagh Lodge includes a two-storey tower inspired by nearby Rockfleet castle, home of legendary pirate queen Granuaile. Nestled into a small hill and only visible from the sea, the house boasts panoramic views of Clew Bay with its myriad submerged drumlin islands surrounded by rugged hills including Ireland's holy mountain Croagh Patrick.

The property is approached through striking wrought-iron gates which open to a gravel driveway, giving unsurpassed panoramic views from Castlebar and the plains of Mayo in the east to Clare Island and the Atlantic Ocean in the west.

Solid oak double doors lead through a porch to a grand double-height atrium entrance hallway bathed in natural light from large roof windows. Designed for entertaining guests, the hall opens to a spacious west-facing drawing room with wall-to-wall ceiling-height windows giving extraordinary views. A door gives easy access to a patio outside. A cosy

sitting room with feature sandstone wall leads to the open-plan kitchen-dining room with spectacular vaulted ceiling and substantial reclaimed pitch-pine beams. This area is completed with a utility room, cloakroom, WC and shower which doubles as a mud room accessed by a second entrance to the house.

The very generous master suite is the only upstairs accommodation and includes a large bedroom with fitted wardrobe units along two walls, a separate study, and a large stone-tiled bathroom with a spacious rainfall shower and double jacuzzi bath, and a picture window to enjoy stunning sunsets. Downstairs, the hall leads to two double bedrooms with ensuite bathrooms and two walk-in storage cupboards. The accommodation extends to approximately 4,927 sq ft as shown on the accompanying floor plans.

A spectacular, private and unique coastal property.

Roslynagh Lodge, Ardagh, Newport, Co. Mayo

savills





A spectacular, private and unique coastal property.

Roslynagh Lodge, Ardagh, Newport, Co. Mayo



Plans

 4,927 sq ft

 7 acres

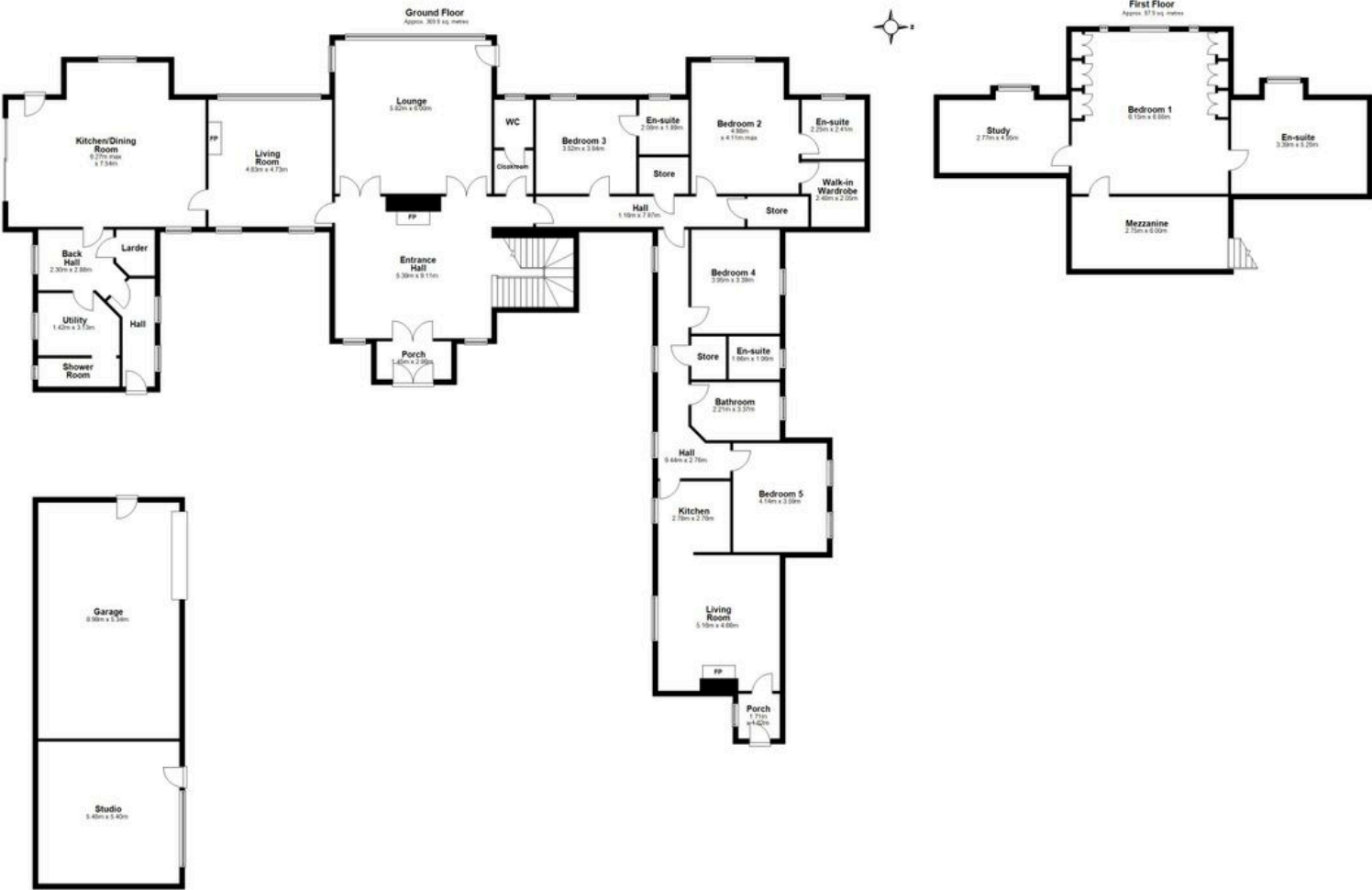

Total area: approx. 457.7 sq. metres

A spectacular, private and unique coastal property.

Roslynagh Lodge, Ardagh, Newport, Co. Mayo

savills



## Local Area

Newport village is a short distance east and offers small shops, cafes and restaurants including Hotel Newport. Westport, one of Ireland's most-acclaimed towns, is only 18 km away and is well-known for its vibrant arts scene, top quality restaurants and famous pubs. It also boasts supermarkets, leisure facilities and a station on the railway line to Dublin.

County town Castlebar is 26 km inland, while Galway city is less than two hours drive through the stunning scenery of south Mayo or Connemara.



A spectacular, private and unique coastal property.

Roslynagh Lodge, Ardagh, Newport, Co. Mayo



## Property Details

### Key Features

- Architect-designed coastal home with panoramic Clew Bay views.
- Bespoke kitchen with vaulted ceiling and granite island.
- Elegant double-height atrium and entertaining spaces.
- Flexible guest wing with independent access.
- Artist’s studio with apex north-facing windows.
- Private shoreline access, paddocks and native woodland.

### Services & Additional Information

- Geothermal under floor heating.
- Water treatment system fed by an abundant deep-bored well.
- Waste water is managed by a pumped sewage treatment unit.

### BER

BER Rating = B2

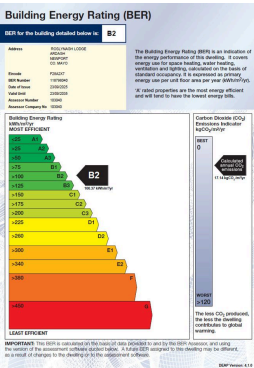



A spectacular, private and unique coastal property.

Roslynagh Lodge, Ardagh, Newport, Co. Mayo



Enquire



**Cianan Duff**  
Dublin - Country  
+353 (0) 86 386 1466  
cianan.duff@savills.ie

More Information



View on website



View Digital Brochure



Property Search

Viewing strictly by appointment

Property Ref: DUY250104

Residential & Country

33 Molesworth Street, D02 CP04  
+353 (0) 1 618 1300



Important Notice: Savills, its clients and any joint agents give notice that 1: They are not authorised to make or give any representations or warranties in relation to the property either here or elsewhere, either on their own behalf or on behalf of their client or otherwise. They assume no responsibility for any statement that may be made in these particulars. These particulars do not form part of any offer or contract and must not be relied upon as statements or representations of fact. 2: Any areas, measurements or distances are approximate. The text, photographs and plans are for guidance only and are not necessarily comprehensive. It should not be assumed that the property has all necessary planning, building regulation or other consents and Savills have not tested any services, equipment or facilities. Purchasers must satisfy themselves by inspection or otherwise. *powered by* **FluoPro**