

THIS DRAWING IS COPYRIGHT

All works to be in accordance with current Building Regulations and Codes. Contractors and Subcontractors are responsible for ensuring compliance with Building Regulations within their trade. Where this drawing is open to public inspection pursuant to a statutory requirement, or is a statutory register, copying is subject to the requirements of Section 74 of the Copyright and Related Right Act, 2000

Key Plan



House Type - HT2

GENERAL NOTES
THIS DRAWING TO BE READ IN CONJUNCTION WITH CONSTRUCTION DETAILS AND DRAWINGS & DOCUMENTATION PREPARED BY THE CIVIL / STRUCTURAL AND MECHANICAL / ELECTRICAL ENGINEER'S
Refer to sheet BTY-1-06-SW-ZZZ-DR-RDL-A-1000 for general specification notes

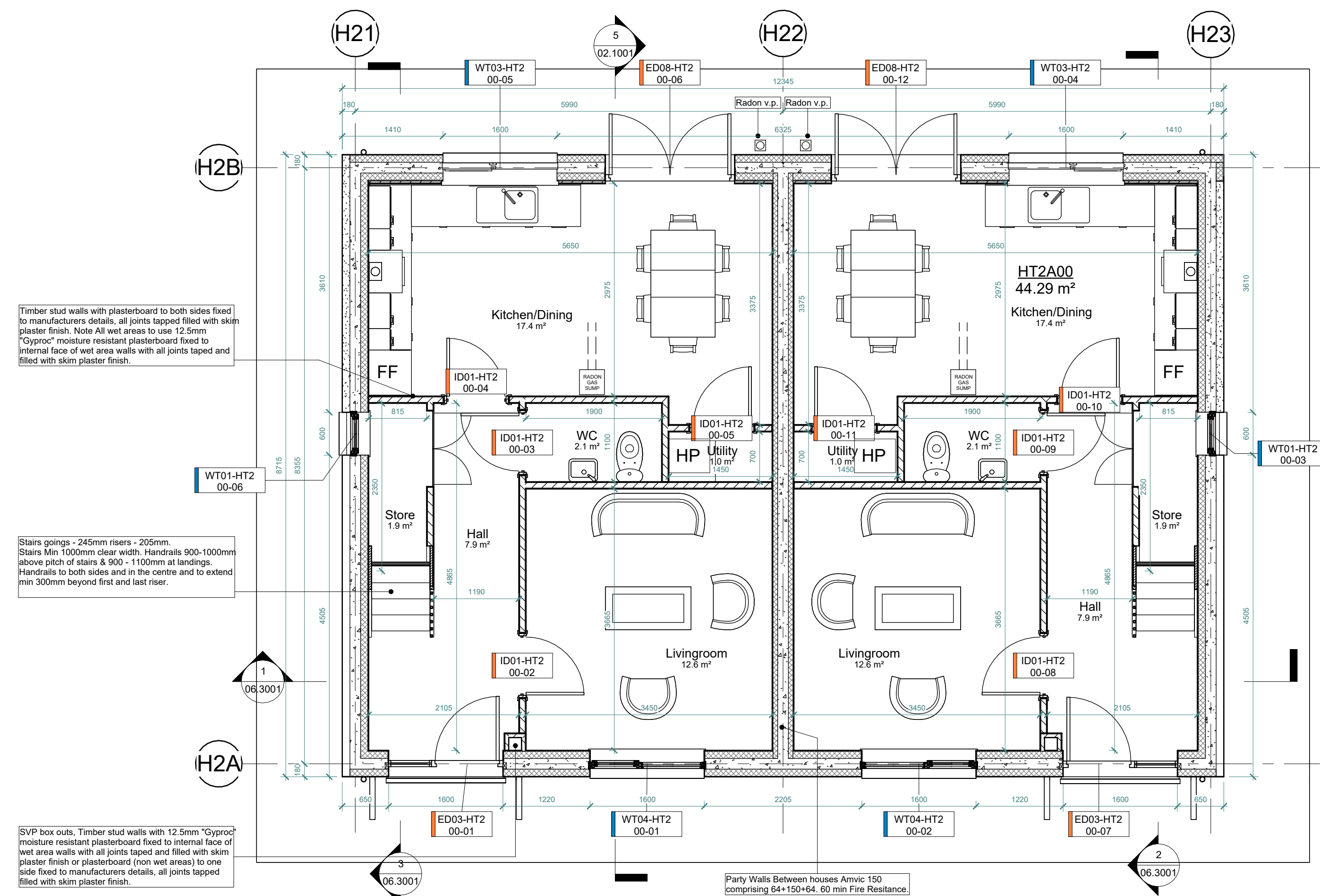

1 L00 - Ground Floor (GA)
1 : 50

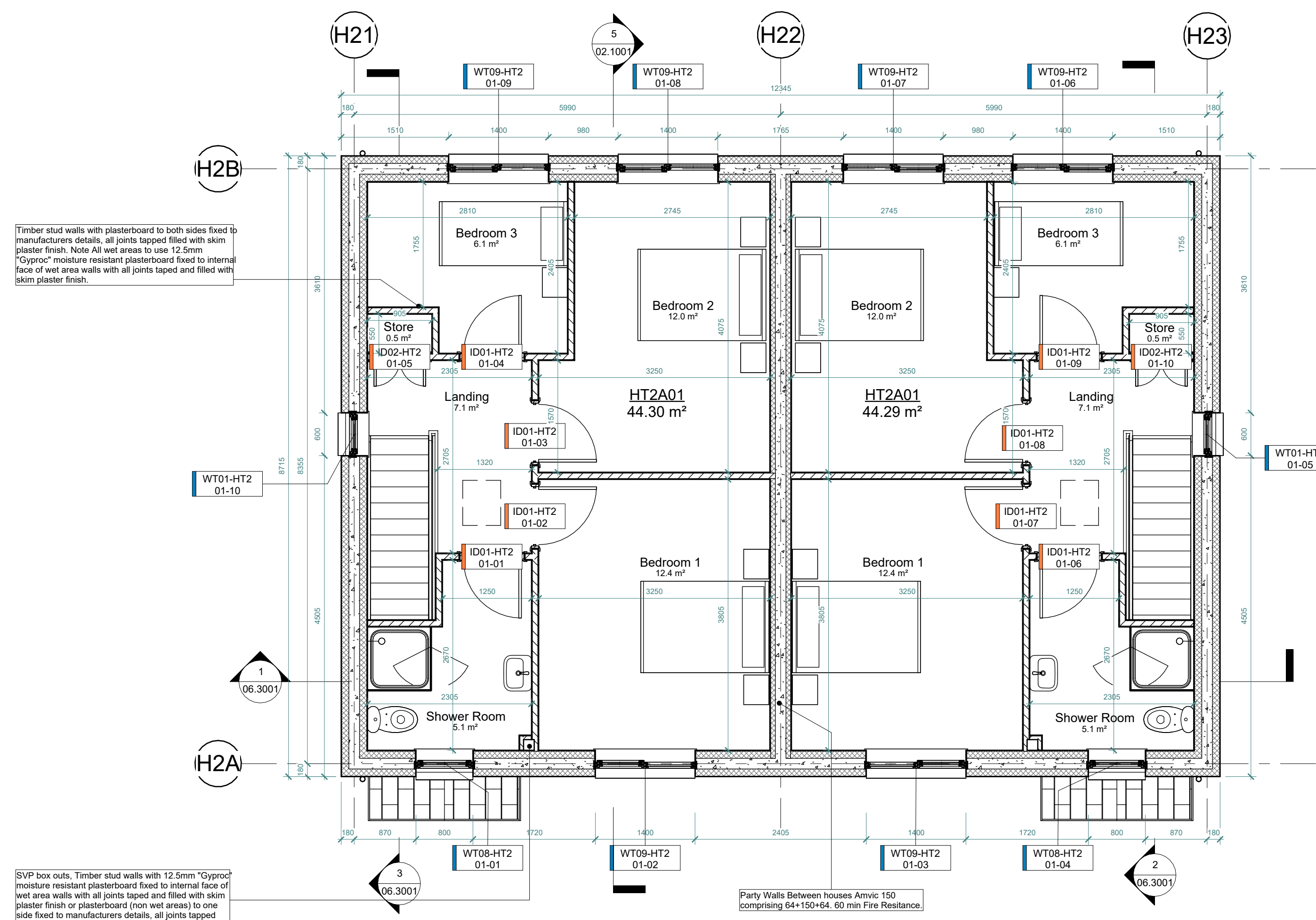

2 L01 - First Floor
1 : 50

Rev	Description	Date
P1-S1	Issued for Information	28.11.21
P4-S1	Amic Build Up	13.12.21
P9-S1	Issued for Construction	14/04/22

STATUS	PURPOSE OF ISSUE
P9	Issued for Construction

Remcoll Developments

Third Floor,
Broadmeadow Hall,
Applewood, Swords,
Co. Dublin, K67 Y5F2



+353 (1) 813 9754

PROJECT
Milleenoola, Bantry, Co. Cork

TITLE
HT2 - Ground Floor And First Floor Plans

DRAWN BY J. Fernandez	CHECKED BY D. O'Donnell	DATE 13/12/21
--------------------------	----------------------------	------------------

SCALE (@ A1) 1 : 50	PROJECT NUMBER BT01
------------------------	------------------------

DRAWING NUMBER BTY-1-06-H2-ZZZ-DR-RDL-A-1001	REV P9-S1
---	--------------