



JP&M
DOYLE

Established. 1952

Auctioneers | Valuers | Estate Agents | Property Consultants

FOR SALE

**LAND C.17 ACRES/6.88 HA.,
BRITTONSTOWN,**



**NR.BLESSINGTON
CO.WICKLOW.**

jpmdoyle.ie

(045) 865 568

LOCATION:

Situated adjoining the renowned Tulfarris Golf and Country Club on the shores of the Blessington Lakes, just off the N81 and within easy commuting distance of Dublin.

Blessington: c. 6 miles/ 9.7 km.

Dublin City Centre: c. 24.5 miles/ 39.4 km.

DESCRIPTION:

Land c. 17 acres/ 6.88 hectares of top quality, all in grass sheltered and benefitting from extensive road frontage. Situated in this most scenic location, it commands exceptional views of the Blessington Lakes and the Wicklow Mountains. The lands are but a short distance from a host of amenities in the nearby villages and towns including shops, churches, schools, pubs and restaurants. A wide variety of leisure pursuits are also catered for in the area including many fine golf courses, race courses, with water pursuits and fishing available on the adjacent lakes. Without a doubt, an outstanding opportunity to acquire such a unique property in this area of such beauty and scenery.



PRICE REGION: €169,000

VIEWING: Any Reasonable Time.

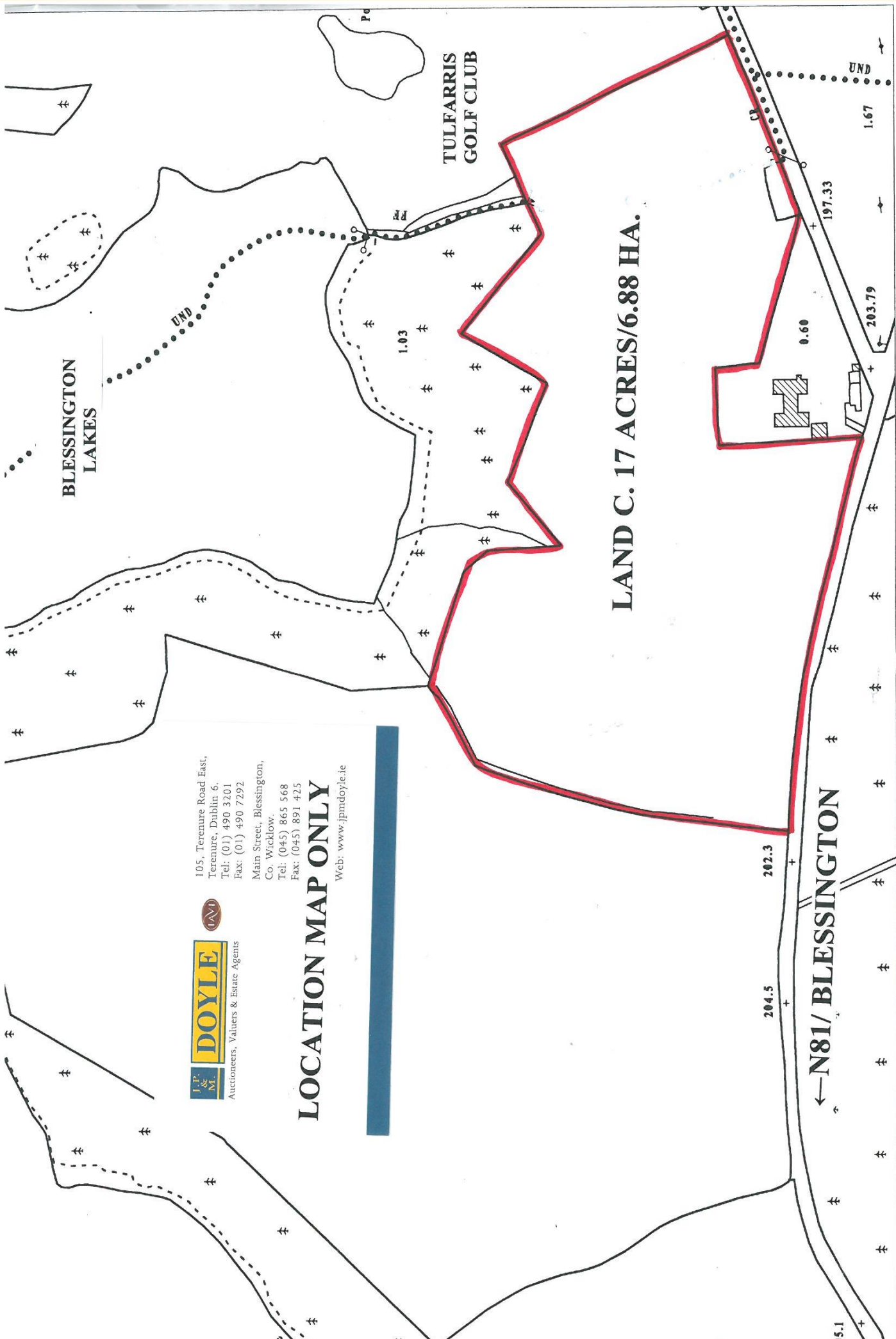

LAND C. 17 ACRES/6.88 HA.

105, Terenure Road East,
Terenure, Dublin 6.
Tel: (01) 490 3201
Fax: (01) 490 7292
Main Street, Blessington,
Co. Wicklow.
Tel: (045) 865 568
Fax: (045) 891 425
Web: www.ipmdoyle.ie



LOCATION MAP ONLY





JP&M
DOYLE

Established. 1952

Main Street, Blessington, Co. Wicklow.

t: (045) 865568

f: (045) 891425

e: blessington@jpmdoyle.ie

PSRA Licence: 002264

J.P. & M. Doyle Ltd., for themselves and for the vendors of this property whose agents they are, give notice that:

- (1) the particulars are set out as a general outline for the guidance of intending purchasers and do not constitute part of an offer or contract.
- (2) all description, dimensions, references to condition and necessary permission of use and occupation, and other details are given in good faith and are believed to be correct, but any intending purchasers or tenants should not rely on them as statements or representations of fact but must satisfy themselves by inspection or otherwise as to the correctness of each of them.
- (3) no person in the employment of J.P. & M. Doyle Ltd. has any authority to make or give any representations or warranty whatever in relation to the property.