



# THORNHILL OAKS

LUXURY LIVING IN MOUNT MERRION

THE MEWS HOMES

Lisney

---

**Sotheby's**  
INTERNATIONAL REALTY













.....

# SPECIFICATION

.....



- High quality, custom designed fitted kitchens to be provided
- Kitchens include quartz countertops and full height splashbacks, and come with high quality integrated appliances including oven, microwave, induction hob, extractor fan, fridge/freezer and dishwasher
- Attractive bathrooms and en-suites with extensive porcelain wall and floor tiling
- Top quality vitreous china sanitary ware from Roca
- Heated towel radiators will be provided in bathrooms.
- Utility room features fitted units, with a washing machine and tumble dryer included as standard
- All houses feature extremely high levels of energy efficiency with a BER Rating of A2/A3
- The heating system will consist of an efficient Air to Water heat pump system.
- Underfloor heating will be provided at ground floor level. Thermostatically controlled radiators will be provided at First Floor level.
- Multiple heating zones are provided in each house, controlled by individual OEM thermostat displays
- Fire alarm, smoke and heat detectors are fitted as standard
- All houses are pre-wired for Virgin Media and Eir broadband services
- Where applicable, contemporary built-in bedroom wardrobes are provided with extensive rails and shelving
- The front elevation consists of a white render finish to external walls with bespoke details including large format windows, sliding timber screens, a granite stone plinth and contemporary style dormer windows with a sheet metal finish. A natural slate finish is provided to the pitched roof.
- Gutters and downpipes will be aluminium with a powder-coated finish.
- All windows and doors are triple glazed Alu-clad by Rational.
- All Houses benefit from 10 Year Homebond Latent Defects Insurance Policy

.....

# SITE PLAN

.....

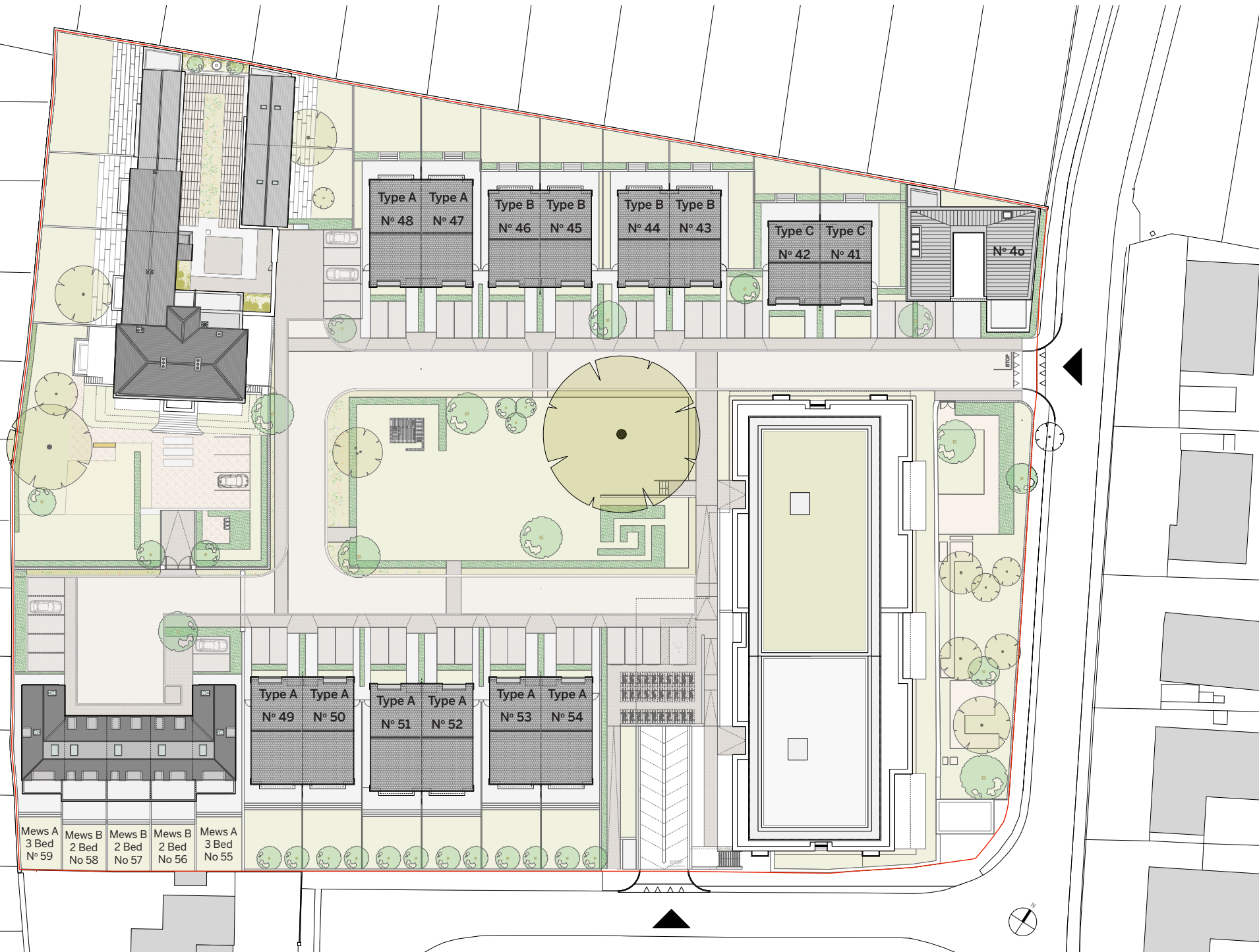

Type A  
N° 48

Type A  
N° 47

Type B  
N° 46

Type B  
N° 45

Type B  
N° 44

Type B  
N° 43

Type C  
N° 42

Type C  
N° 41

N° 40

Type A  
N° 49

Type A  
N° 50

Type A  
N° 51

Type A  
N° 52

Type A  
N° 53

Type A  
N° 54

Mews A  
3 Bed  
N° 59

Mews B  
2 Bed  
No 58

Mews B  
2 Bed  
No 57

Mews B  
2 Bed  
No 56

Mews A  
3 Bed  
No 55

HOUSE PLANS

PRIVATE  
RESIDENCES  
- SOUTH AVENUE

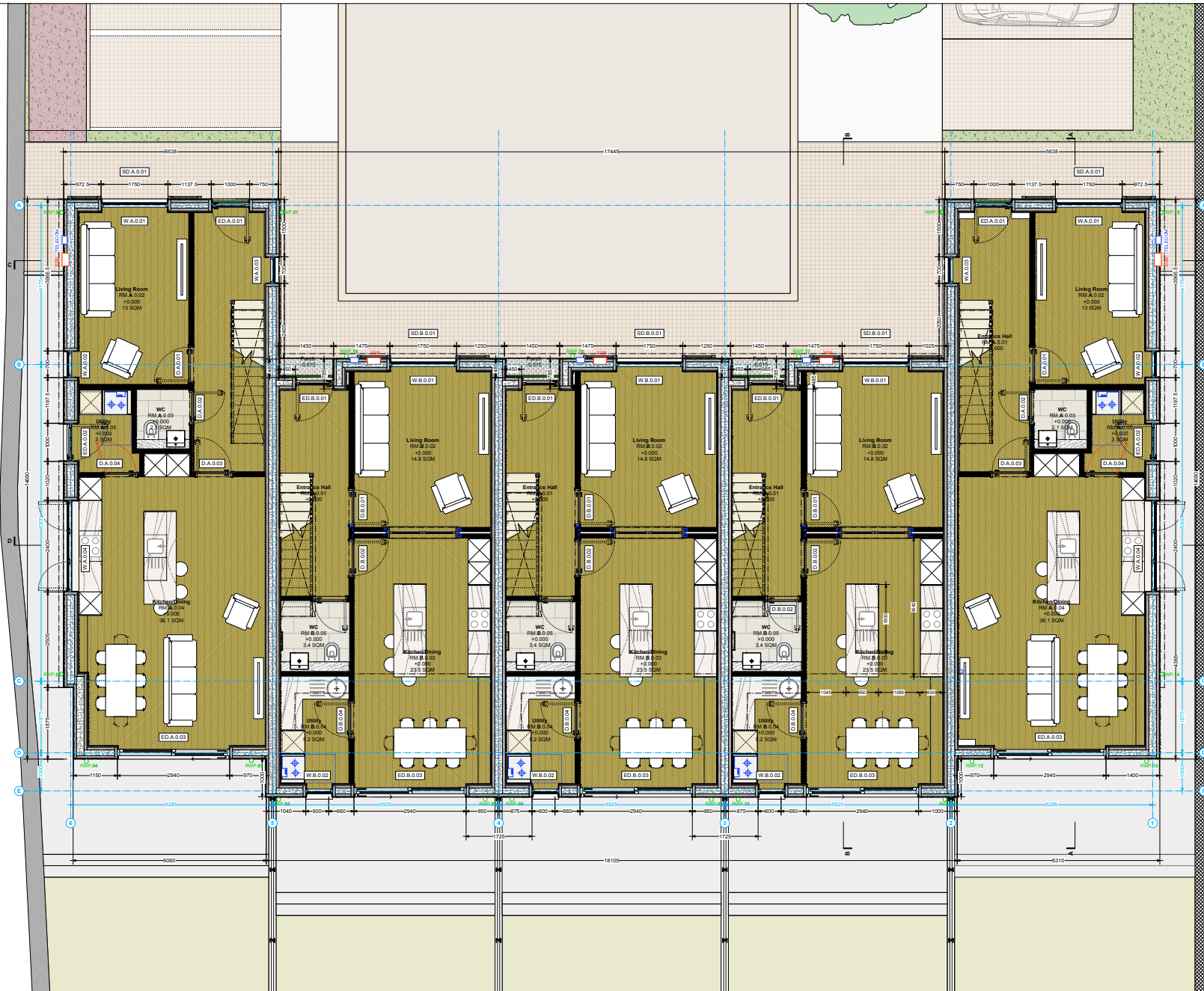

THORNHILL  
- PHASE II



# Lisney

---

# Sotheby's

INTERNATIONAL REALTY

Lisney Sotheby's International Realty

St. Stephen's Green House,

Earlsfort Terrace, Dublin 2.

T: (01) 638 2700

E: [newhomes@lisneysir.com](mailto:newhomes@lisneysir.com)

Lisney Sotheby's International Realty is an Independently Owned and Operated Company.

Any intending purchaser(s) shall accept that no statement, description or measurement contained in any newspaper, brochure, magazine, advertisement, handout, website or any other document or publication, published by the vendor or by Lisney Sotheby's International Realty, as the vendor's agent, in respect of the premises shall constitute a representation inducing the purchaser(s) to enter into any contract for sale, or any warranty forming part of any such contract for sale. Any such statement, description or measurement, whether in writing or in oral form, given by the vendor, or by Lisney Sotheby's International Realty as the vendor's agent, are for illustration purposes only and are not to be taken as matters of fact and do not form part of any contract. Any intending purchaser(s) shall satisfy themselves by inspection, survey or otherwise as to the correctness of same. No omission, misstatement, misdescription, incorrect measurement or error of any description, whether given orally or in any written form by the vendor or by Lisney Sotheby's International Realty as the vendor's agent, shall give rise to any claim for compensation against the vendor or against Lisney Sotheby's International Realty, nor any right whatsoever of rescission or otherwise of the proposed contract for sale. Any intending purchaser(s) are deemed to fully satisfy themselves in relation to all such matters. These materials are issued on the strict understanding that all negotiations will be conducted through Lisney Sotheby's International Realty. Please note we have not tested any apparatus, fixtures, fittings, or services. Interested parties must undertake their own investigation into the working order of these items. All measurements are approximate and photographs provided for guidance only. PSRA No. 001848.



# THORNHILL OAKS

LUXURY LIVING IN MOUNT MERRION

THE MEWS HOMES

Lisney

---

**Sotheby's**  
INTERNATIONAL REALTY