

For Sale

Asking Price: €650,000



8 Seacliff,
Wicklow Town,
Co. Wicklow,
A67 Y735

[MySherryFitz.ie](https://www.MySherryFitz.ie)



--View & Make offers directly on [MySherryFitz.ie](https://www.MySherryFitz.ie)--

BER C2



Nestled in the prestigious Seacliff development on the outskirts of Wicklow town, this wonderful four-bedroom bungalow with a separate home office offers luxury and tranquillity.

From the front, breathtaking sea views create a serene ambiance, while the south-facing rear gardens, completely private and meticulously landscaped, provide a sun-soaked haven for outdoor activities and leisure.

The spacious interior offers ample living space, perfect for both relaxation and entertaining. Upon entering the home, you are welcomed into a lovely bright living room located at the front of the house. The living room features an attractive bay window that providing a picturesque and peaceful setting. The heart of the home is the bright and spacious kitchen dining room, where family and friends can gather for meals and socialising. The property boasts four well-appointed bedrooms, with two of them featuring en-suite bathrooms for added convenience. Each bedroom is designed to provide a comfortable and private retreat. To enhance practicality, the home includes a utility room off the kitchen, providing additional space for laundry and storage needs.



Accommodation:

Entrance Hall A lovely and bright hallway with timber flooring, the hallway features ceiling coving and attractive architraves, and double doors open into the living room.

Living Room Bright and spacious living room with timber flooring, this room is beautifully decorated and boasts a feature fireplace with an open fire, ceiling coving, and a large bay window that overlooks the front lawn

Kitchen Dining Room A wonderful kitchen and dining area featuring tiled flooring, the kitchen boasts both floor and eye-level units, providing ample storage, and a tiled backsplash. Adjacent to the kitchen, the dining area is bathed in natural light, creating a welcoming atmosphere. Sliding doors open out to the wonderful private south facing garden.

Utility Room With tiled flooring, storage space and provisions for a washing machine and dryer.

Bedroom 1 Large double bedroom with timber flooring and built-in wardrobes, en-suite off.

En-Suite With floor and wall tiles, shower unit fitted with a power shower, WC and wash hand basin.

Bedroom 2 Double bedroom with timber flooring.

Home Office Ideal for those working from home or could be a bedroom if needed.

Bedroom 3 Double bedroom with timber flooring.

Bedroom 4 Large double bedroom with views overlooking the garden,

En-Suite With wall and floor tiles, shower unit is fitted with a power shower, WC and wash hand basin.

Family bathroom Large family bathroom with tiled flooring and partly tiled walls, WC and wash hand basin, bath with telephone shower connection and a separate shower unit fitted with a power shower.





Garden:

Special Features & Services:

-

BER: BER C2, BER No. 101560498



Directions:

A67Y735



Floor Plan

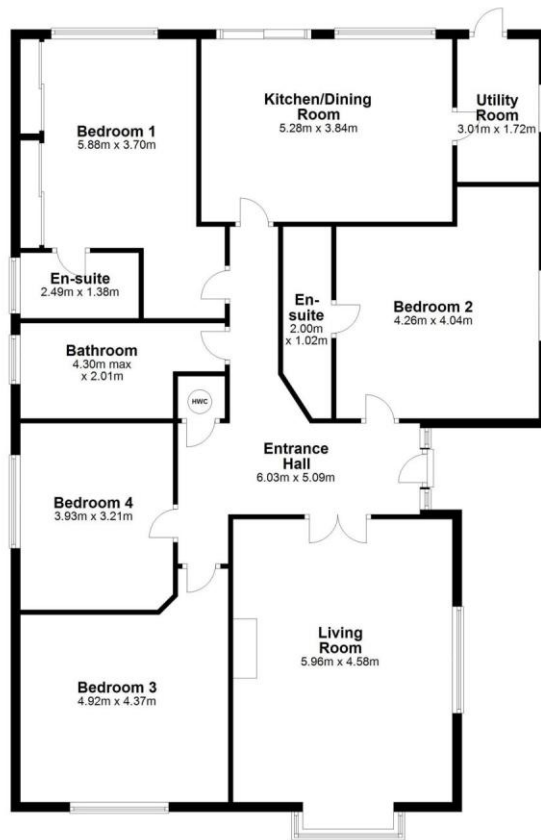

Total area: approx. 159.3 sq. metres

NEGOTIATOR



Sherry FitzGerald Catherine O'Reilly
1 Bridge Street Arcade, Fitzwilliam Square,
Wicklow Town

0404 66466
info@sfcatherineoreilly.ie

MySherryFitz.ie



CONDITIONS TO BE NOTED: A full copy of our general brochure conditions can be viewed on our website at <http://www.sherryfitz.ie/terms> or can be requested from your local Sherry FitzGerald office. We strongly recommend that you familiarize yourself with these general conditions.

PSRA Registration No. 003161