

# Residential

**Coonan**  
PROPERTY



## 52 Oldbridge View, Osberstown, Naas, Co. Kildare

- Excellent two-bedroom bungalow extending 65 sq.m/ 699 sq.ft
- Accommodation comprises of hallway, kitchen/dining/living room, two bedrooms and family bathroom
- Sunny south facing private garden located at the end of a quiet cul de sac with green area to the front
- Excellent transport links, within a short walk (approx. 650m) of Sallins arrow train station, with regular bus services nearby and convenient access to the M7 motorway connecting to all major road networks
- Oldbridge enjoys a prime position between Naas and Sallins within walking distance of vibrant shops, a host of eateries, pubs, schools and churches. An array of recreational activities including Naas and Punchestown racecourses, golf clubs, tennis club, GAA and rugby clubs.

2 bedroom bungalow  
extending to approx.  
65 sq.m (699 sq.ft)

Guide Price:

**€350,000**

Private Treaty

# Accommodation

**Coonan**  
PROPERTY

Entrance  
Hallway

**5.70m x 0.97m**

Semi-solid flooring, coving and cornice, phone point, additional sockets, alarm panel.

Bedroom 1

**2.33m x 3.55m**

Semi-solid flooring, fitted wardrobes, curtains.



# Accommodation

**Coonan**  
PROPERTY

**Bathroom**      **2.35m x 2.34m**      Tiled floor and semi-tiled walls, bath with electric shower, w.c., w.h.b. with vanity unit, mirror with integrated lighting and shelving, sky light extractor fan, attic hatch for access.

---

**Inner Hallway**      **3m x 3.98m**      Hotpress.

---

**Bedroom 2**      **2.96m x 3.74m**      Semi-solid flooring, fitted wardrobes, vanity table with mirror, additional sockets.



# Accommodation

**Coonan**  
PROPERTY

**Kitchen/  
Dining /Living  
Room**

**3.27m x 8.98m**

Open plan layout, semi-solid flooring, fully fitted kitchen, oven, hob, extractor fan, plumbed for a washing machine, stainless steel 1.5 bowl sink. Living room with feature gas fireplace, cast iron and wooden mantle with granite hearth, TV point, additional sockets, coving and cornice.

**Garden**

**15.00m x 7.37m**

Sandstone and concrete paved area, lawn, wall and panel fence surround.



# Accommodation

**Coonan**  
PROPERTY

## **Additional Information:**

Built in 2000  
Alarmed  
Granite sills

## **Entrance Driveway:**

Paving with loose stone chippings.

## **Items Included in sale:**

Fixtures, fittings and window dressings.

## **Services:**

Mains Water  
Gas central heating



# Floor Plans

**Coonan**  
PROPERTY

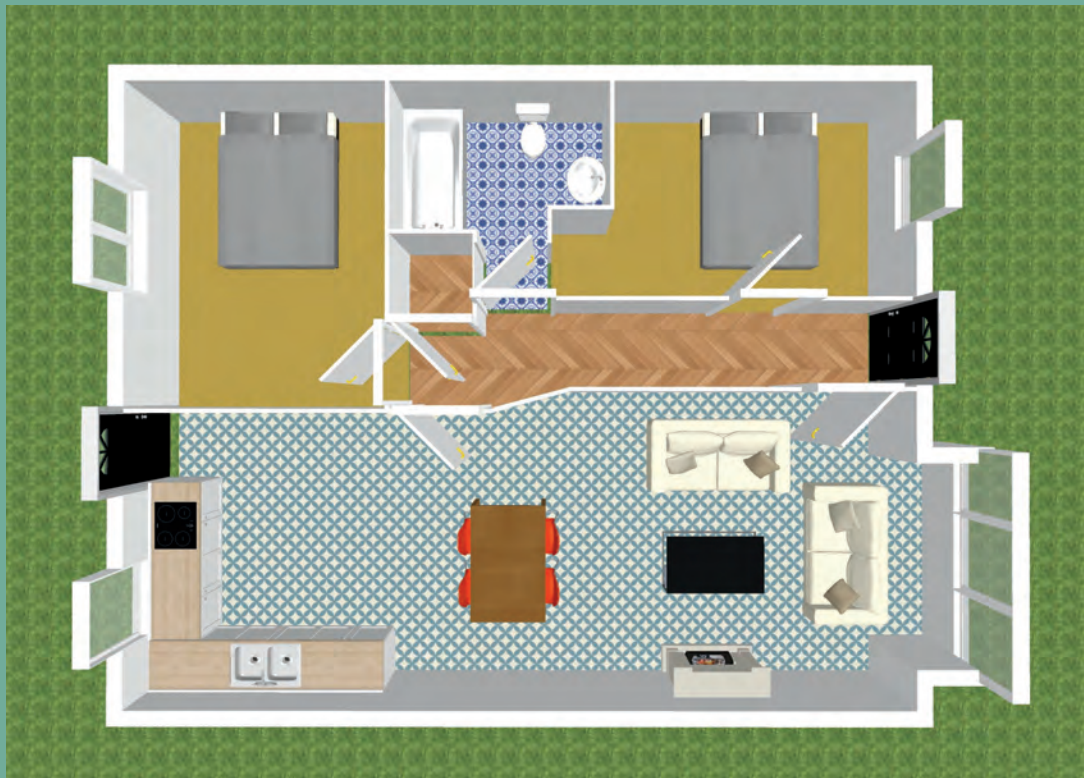

# Directions

**Coonan**  
PROPERTY

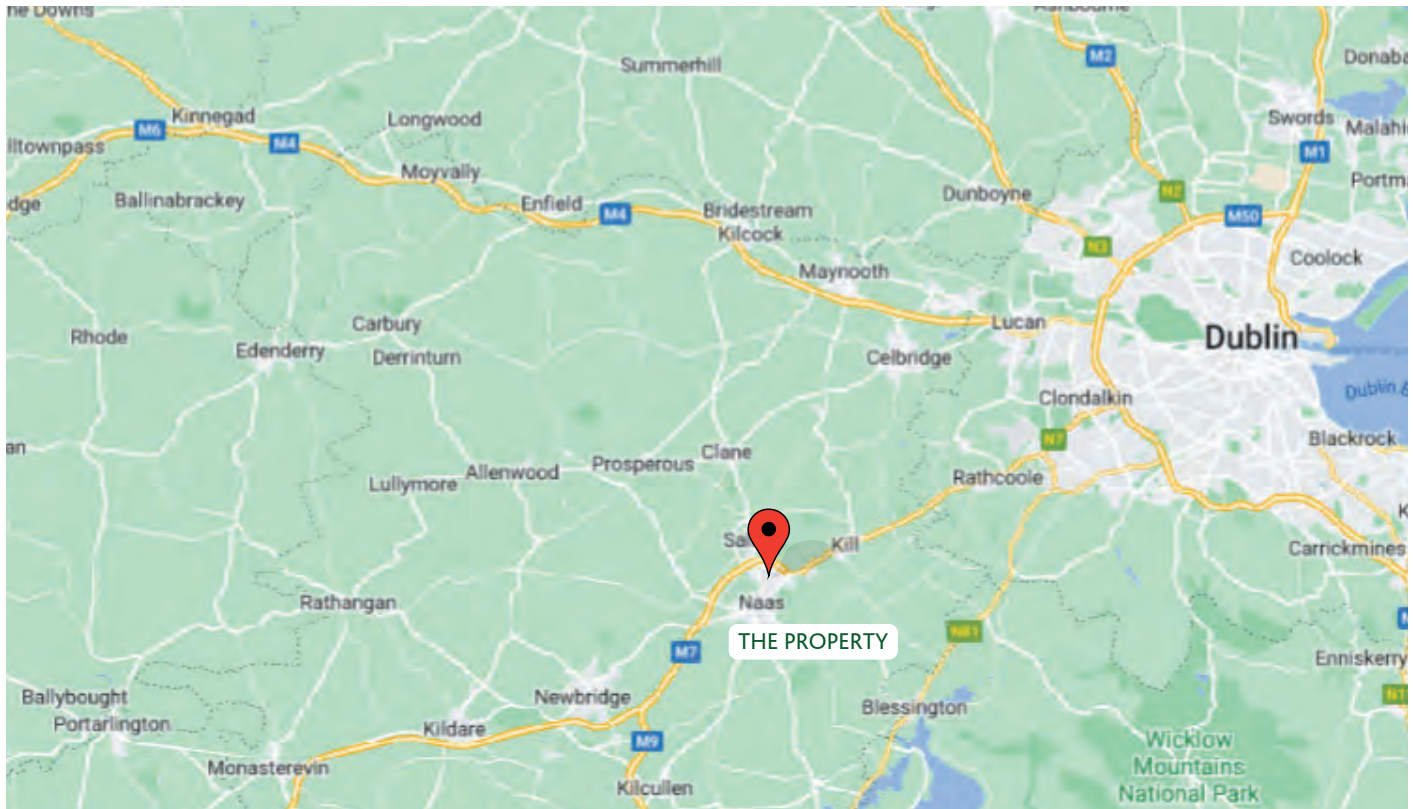

## Directions

W91 K6VH

**BER**

**BER C3**

## Viewing

By prior appointment at any reasonable hour.

**Coonan**  
PROPERTY

Contact Information:

Jill Wright

045 832020

jillw@coonan.com

PSRA No.: 003764.

The above particulars are issued by Coonan Property on the understanding that all negotiations are conducted through them. Every care is taken in preparing particulars which are issued for guidance only and the firm does not hold themselves responsible for any inaccuracies. All reasonable offers will be submitted to the vendors for consideration but the contents of this brochure shall not be deemed to form the basis of any contract subsequently entered into. The vendor or lessor do not make, give or imply nor is Coonan Property or its staff authorised to make, give or imply any representation or warranty whatsoever in respect of this property.

**Coonan**  
FINANCIAL GROUP

Coonan Mortgage Group Limited t/a Coonan Financial Group is regulated by the Central Bank of Ireland. Registration No.: 431200

For all your mortgage needs contact:

Dermot Horan / Romana Anca

01 505 2718

admin@coonanmortgage.com

coonan.com