

Wicklow Mountains

Blessington Lakes



For Sale By Private Treaty

IN ONE OR TWO LOTS

Cottage On c.42 Acres

Cromwellstown Hill, Killeel, County Kildare.

 (01) 490 3201

 www.jpmdoyle.ie

LOCATION:

This land and cottage are situated on the Dublin/ Kildare border, close to the villages of Brittas and Killeel, on a cul-de-sac road c. 1.2 miles off the Killeel to Rathcoole Road. Set in these most scenic surroundings, and commanding exception unparalleled views over the encompassing country side, this property is serviced by an abundance of sporting activities including golf, equestrian pursuits and water activities on the nearby Blessington Lakes. It is within easy commuting distance of Dublin City with access to N81, N7 and M50 and benefits from the convenient Luas Transport System, via the Citywest stop only 10 minutes away.

Brittas Village: c. 2.1 miles , **Killeel Village:** c.2 miles and **Rathcoole:** c.5.4 miles.

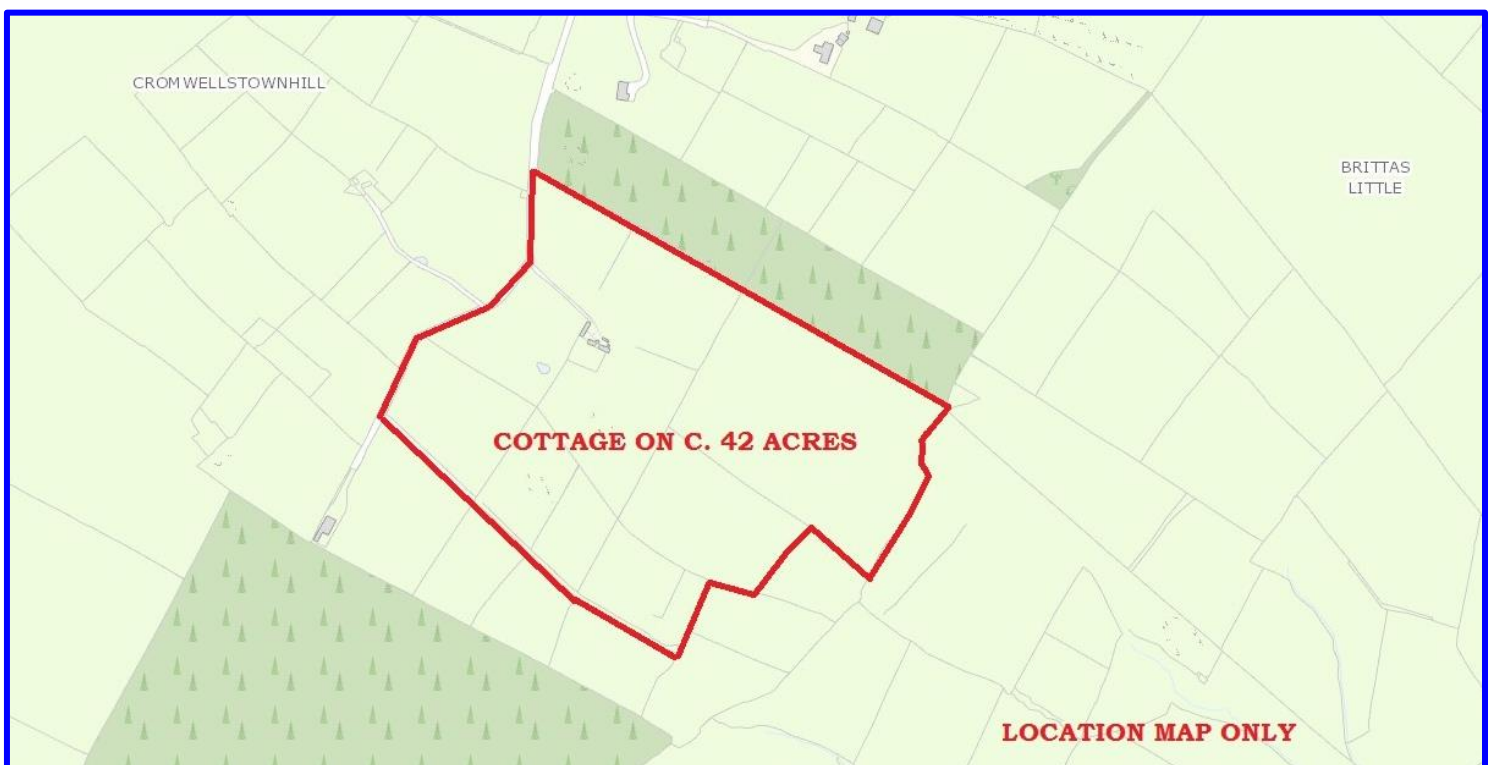
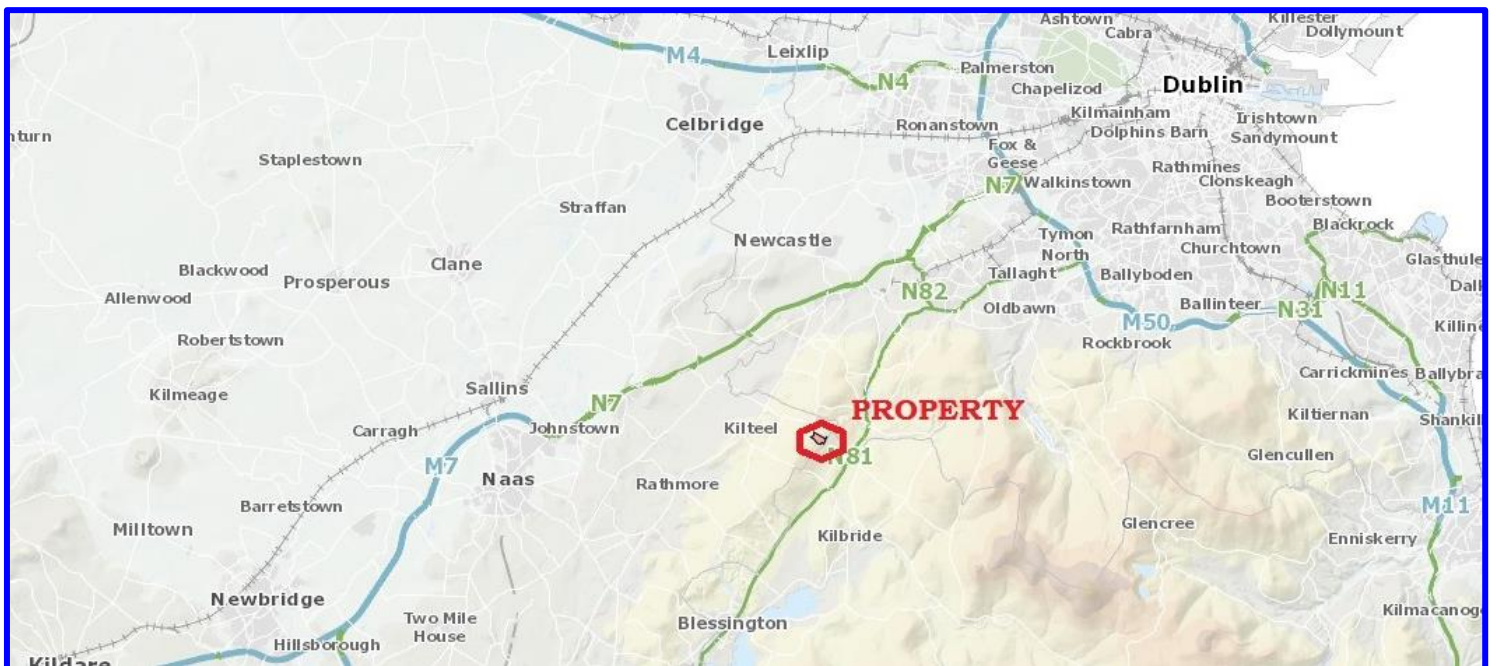

DISRIPTION:

The property comprises of an old-world Stone Cottage in a derelict state, with a range of Farm Buildings and Five Stables and is set on 42 Acres/ 17 Hectares of good quality land. Residing in a desirable and convenient location, the cottage and land proves to be an ideal opportunity for future development of the buildings thereon. The lands are laid out in eight fields, all of which have exceptional views.

LOT 1: COTTAGE ON C. 31.5 ACRES, **LOT 2:** LAND C. 10.5 ACRES, **LOT 3:** ENTIRE

SERVICES:

Well Water, ESB, Drainage to Septic Tank



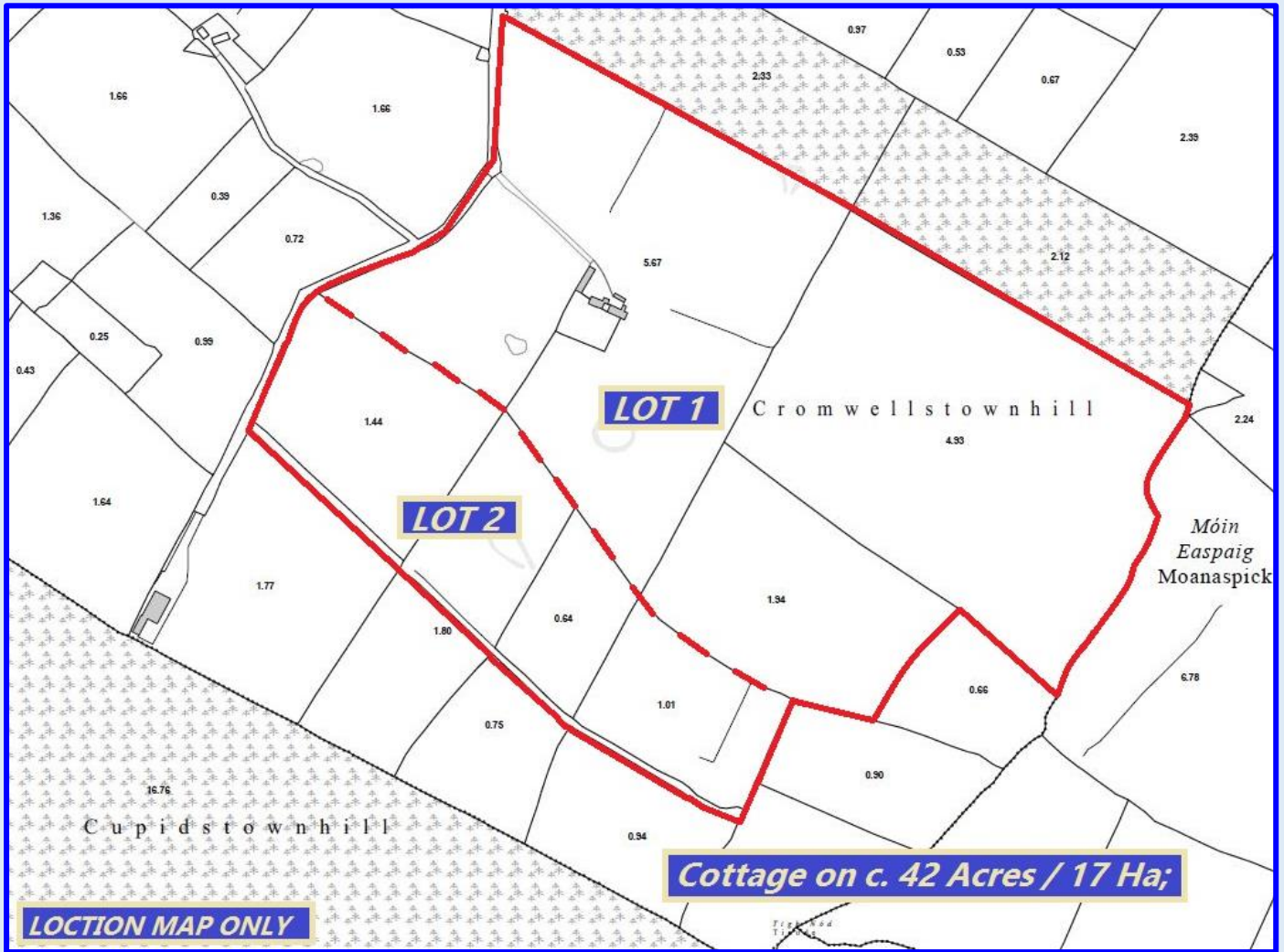

VIEWING:

BY APPOINTMENT ONLY

PRICE REGION:

€398,000 (Entire Property)

Lots Available on Request



JP&M
DOYLE

Established. 1952

105 Terenure Road East, Dublin 6, D06 XD29.

t: (01) 490 3201

f: (01) 490 7292

e: enquiries@jpmdoyle.ie

PSRA Licence: 002264

J.P. & M. Doyle Ltd., for themselves and for the vendors of this property whose agents they are, give notice that:

- (1) the particulars are set out as a general outline for the guidance of intending purchasers and do not constitute part of an offer or contract.
- (2) all description, dimensions, references to condition and necessary permission of use and occupation, and other details are given in good faith and are believed to be correct, but any intending purchasers or tenants should not rely on them as statements or representations of fact but must satisfy themselves by inspection or otherwise as to the correctness of each of them.
- (3) no person in the employment of J.P. & M. Doyle Ltd. has any authority to make or give any representations or warranty whatever in relation to the property.