



29 Hazelbrook

Upper Kilmacud Road, Dundrum, Dublin 14

Lisney | Sotheby's
INTERNATIONAL REALTY



A rare opportunity for the discerning purchaser to acquire a magnificent and exceptionally spacious penthouse apartment superbly situated in this highly regarded gated development of Hazelbrook. Hazelbrook was designed by RKD architects and built by Lomac Developments circa 2006, No. 29 boasts spacious well designed living space with high-quality finishes throughout and is further enhanced with spectacular views over the Dublin mountains.

The accommodation briefly comprises of a welcoming entrance hall, with store cupboard and utility room, family bathroom, large open plan living/ dining room with a feature fireplace and floor to ceiling picture windows and access onto a large balcony with stunning views over the Dublin mountains, large kitchen with all modern fittings, three good sized double bedrooms, main with ensuite and built in wardrobes.

The property enjoys a premier setting just off Upper Kilmacud Road within minutes' walks from local schools, shops and a host of local amenities including restaurants, coffee shops, boutiques and eateries at nearby Stillorgan and Dundrum Villages. The transport links are second to none with the Luas being minutes' walk away and numerous bus routes. An array of schools and colleges are all within easy reach including St. Benildus College, St Raphaela's Primary & Secondary Schools, Mount Anville Primary & Secondary Schools, Dominican College Sion Hill, St. Andrew's College, Oatlands Primary & Secondary School and Michael Smurfit Graduate Business School at UCD. The property also benefits from a ten minute drive from one of the finest shopping centres in Europe at Dundrum.

29 Hazelbrook, Upper Kilmacud Road, Dundrum, Dublin 14

Features

- Well-proportioned accommodation extending to approximately 113 sqm (1,216 sqft)
- Stunning views over the Dublin Mountains
- 2 designated car parking spaces
- Gas Fired Central Heating
- Excellent location
- Large balcony



Accommodation

Hallway 7.90m x 1.30m (25'11" x 4'3") with semi solid wood flooring, Velux rooflight, and recessed lights.

Living/Kitchen 10.50m x 4.30m (34'5" x 14'1") open plan with semi solid wood flooring, recessed lighting, gas fire inset, wall to floor picture windows with door out onto balcony. The kitchen has tiled floors, extensive range of wall and floor units, stainless steel dual sink, Miele extractor fan, Miele four ring electric hob, integrated Miele dishwasher, integrated Miele fridge/freezer, Miele espresso coffee machine, Miele dual oven, recessed lighting, intercom.

Utility Room 2.10m x 1.30m (6'11" x 4'3") plumbed for washing machine, recessed lighting.

Landing with large hot press which houses the gas boiler and hot water tank.

Family Bathroom 2.40m x 1.80m (7'10" x 5'11") with tiled floor and walls, recessed lighting, sound system, wash hand basin, wc, shaving socket, wall mounted mirror, bath with shower insert, underfloor heating, and heated towel rail.

Bedroom 1 2.90m x 3.70m (9'6" x 12'2") wall to floor ceiling with door out onto balcony, built in wardrobes, Mitsubishi electric aircon system, recessed lighting, speaker system.

Main Bedroom 5.80m x 3.40m (19' x 11'2") with door out onto balcony, floor to ceiling picture window, built in wardrobes, recessed lighting, speaker system.

En suite 1.50m x 2.50m (4'11" x 8'2") With tiled floor and walls, wash hand basin, wc, electric shaver socket, wall mounted mirror, recessed lighting, speaker system, step in shower, heated towel rail.

Bedroom 3 4.20m x 2.90m (13'9" x 9'6") With floor to ceiling picture window with door out onto the balcony, built in wardrobes, aircon system, recessed lighting, speaker system.

Balcony 11.20m x 3.30m (36'9" x 10'10") With spectacular views over the Dublin mountains, west facing capturing the evening sun.

BER Information

BER: B3.

BER No: 100736651

EPI: 126.08 kWh/m²/yr.

Eircode

D14 N971



FLOOR PLANS Not to scale - for identification purpose only.

OFFICES

51 Mount Merrion Avenue,
Blackrock, Co. Dublin,
A94 W6K7.
T: 01 280 6820
E: blackrock@lisneysir.com

8 Railway Road,
Dalkey, Co. Dublin,
A96 D3K2.
T: 01 285 1005

103 Upper Leeson Street,
Ballsbridge, Dublin 4,
D04 TN84.
T: 01 662 4511

St. Stephen's Green House,
Earlsfort Terrace, Dublin 2,
D02 PH42.
T: 01 638 2700

29 Dunville Avenue,
Ranelagh, Dublin 6,
D06 K283.
T: 01 662 4511

55 South Mall,
Cork, T12 RR44.
T: 021 427 8500



lisneysir.com

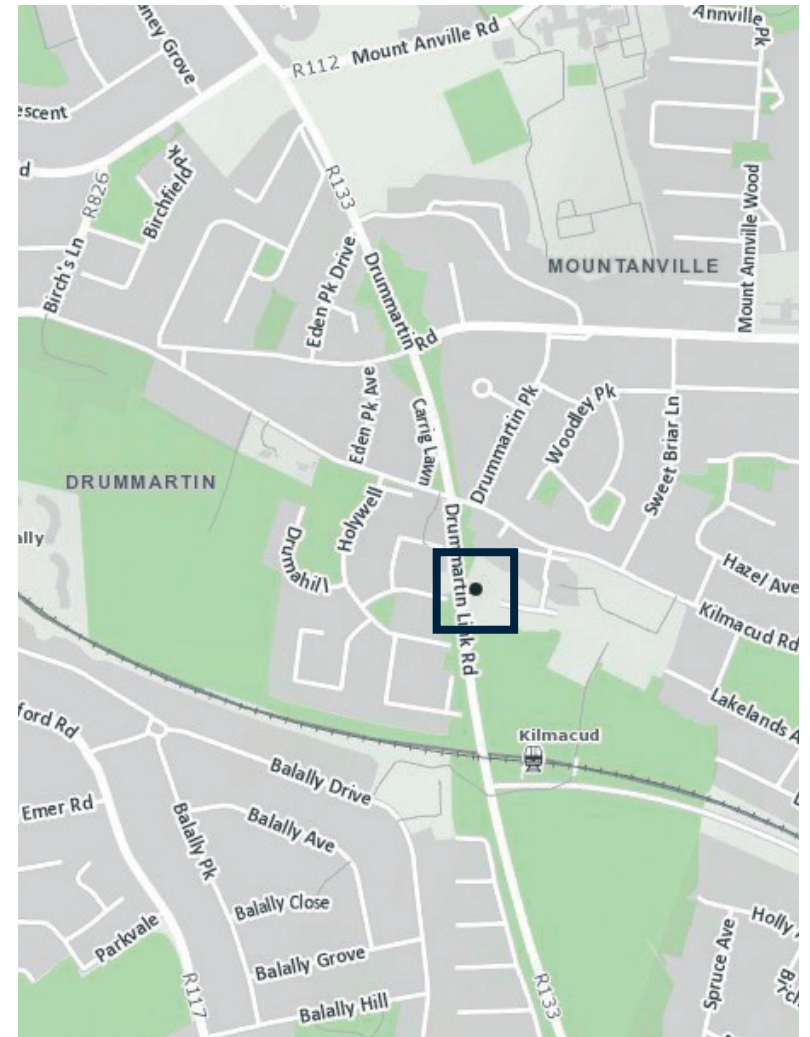
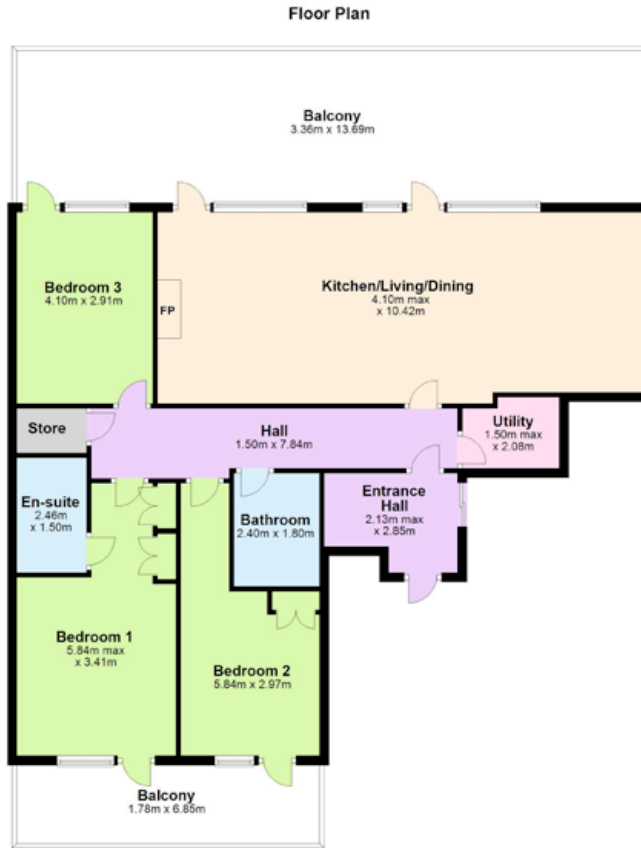

Copyright Ordnance Survey Ireland/Government of Ireland
Licence No. C7AL0305581

Lisney Sotheby's International Realty is an Independently Owned and Operated Company.

Any intending purchaser(s) shall accept that no statement, description or measurement contained in any newspaper, brochure, magazine, advertisement, handout, website or any other document or publication, published by the vendor or by Lisney Sotheby's International Realty, as the vendor's agent, in respect of the premises shall constitute a representation inducing the purchaser(s) to enter into any contract for sale, or any warranty forming part of any such contract for sale. Any such statement, description or measurement, whether in writing or in oral form, given by the vendor, or by Lisney Sotheby's International Realty as the vendor's agent, are for illustration purposes only and are not to be taken as matters of fact and do not form part of any contract. Any intending purchaser(s) shall satisfy themselves by inspection, survey or otherwise as to the correctness of same. No omission, misstatement, misdescription, incorrect measurement or error of any description, whether given orally or in any written form by the vendor or by Lisney Sotheby's International Realty as the vendor's agent, shall give rise to any claim for compensation against the vendor or against Lisney Sotheby's International Realty, nor any right whatsoever of rescission or otherwise of the proposed contract for sale. Any intending purchaser(s) are deemed to fully satisfy themselves in relation to all such matters. These materials are issued on the strict understanding that all negotiations will be conducted through Lisney Sotheby's International Realty. Please note we have not tested any apparatus, fixtures, fittings, or services. Interested parties must undertake their own investigation into the working order of these items. All measurements are approximate and photographs provided for guidance only. PSRA No. 001848.

