

All works to be in accordance with current Building Regulations and Codes. Contractors and Subcontractors are responsible for ensuring compliance with Building Regulations within their trade. Where this drawing is open to public inspection pursuant to a statutory requirement, or is a statutory register, copying is subject to the requirements of Section 74 of the Copyright and Related Right Act, 2000

Key Plan



House Type - HT3

GENERAL NOTES
THIS DRAWING TO BE READ IN CONJUNCTION WITH CONSTRUCTION DETAILS AND DRAWINGS & DOCUMENTATION PREPARED BY THE CIVIL / STRUCTURAL AND MECHANICAL / ELECTRICAL ENGINEERS
Refer to sheet BTY-1-06-SW-ZZZ-DR-RDL-A-1000 for general specification notes

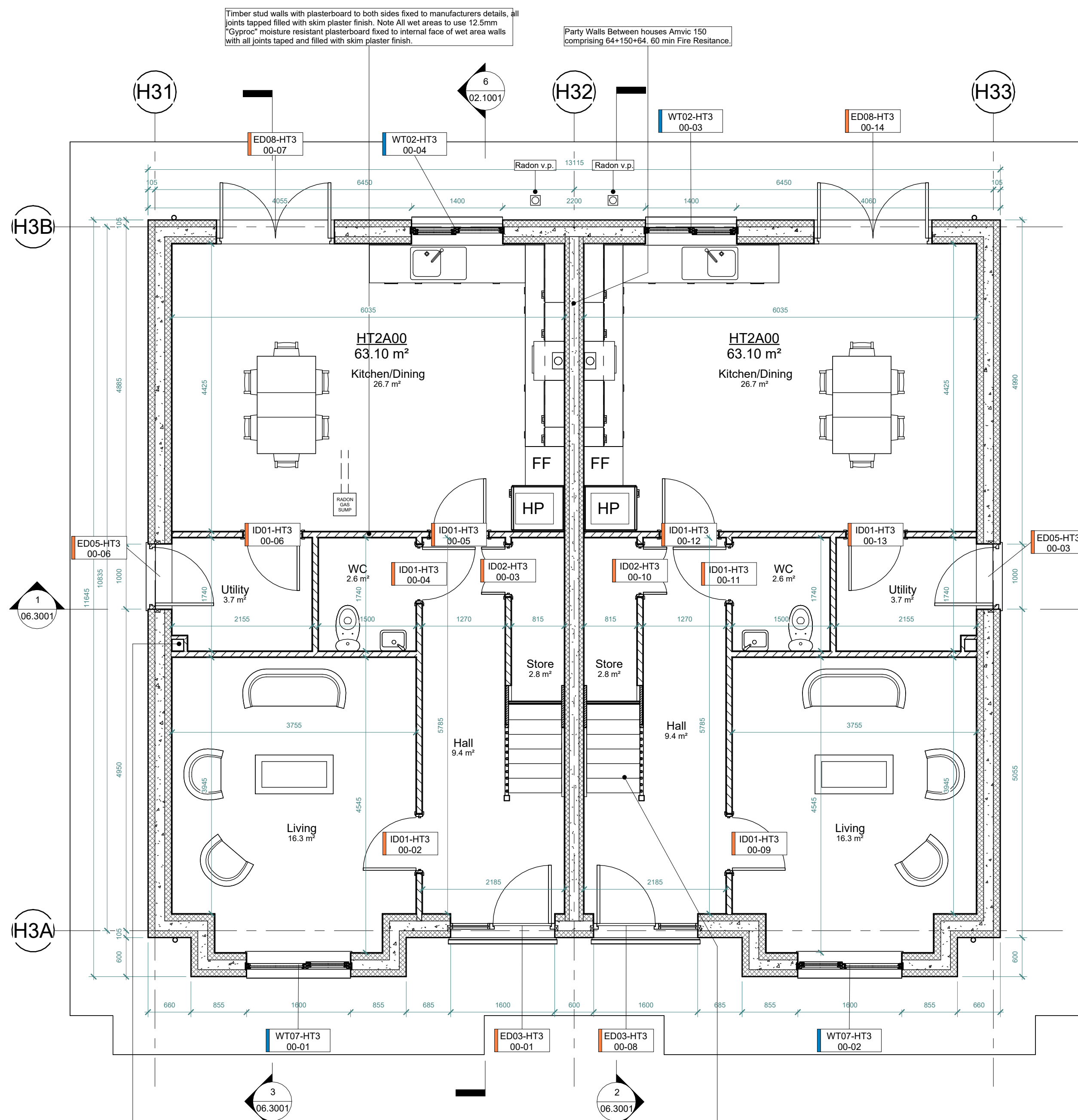

1 L00 - Ground Floor
1 : 50

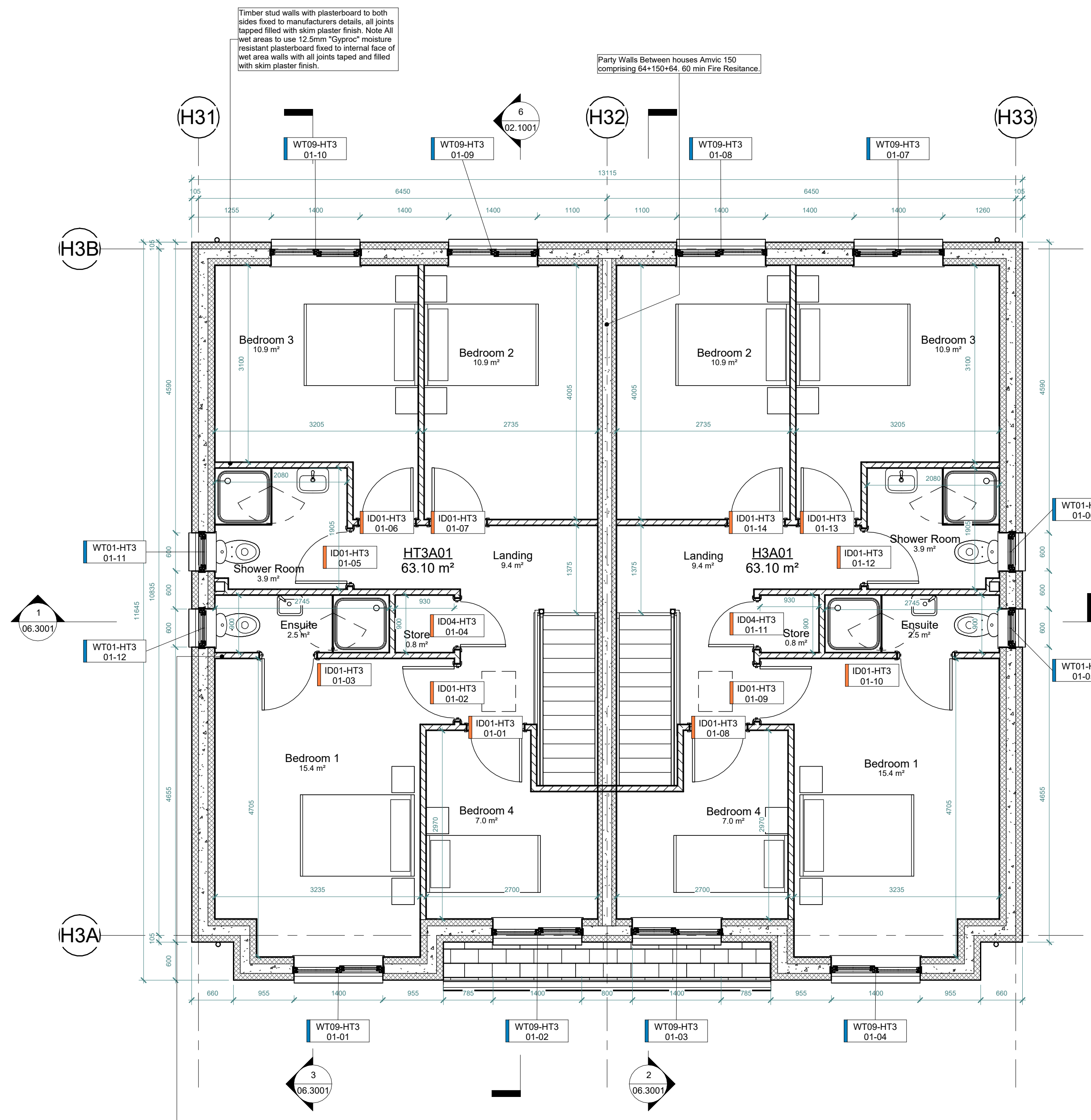

2 L01 - First Floor
1 : 50

SVP box outs, Timber stud walls with 12.5mm "Gyproc" moisture resistant plasterboard fixed to internal face of wet area walls with all joints taped and filled with skim plaster finish or plasterboard (non wet areas) to one side fixed to manufacturers details, all joints taped filled with skim plaster finish.

Party Walls Between houses Armvic 150 comprising 64+150+64, 60 min Fire Resistance

Timber stud walls with plasterboard to both sides fixed to manufacturers details, all joints taped filled with skim plaster finish. Note All wet areas to use 12.5mm "Gyproc" moisture resistant plasterboard fixed to internal face of wet area walls with all joints taped and filled with skim plaster finish.

Party Walls Between houses Armvic 150 comprising 64+150+64, 60 min Fire Resistance

Timber stud walls with plasterboard to both sides fixed to manufacturers details, all joints taped filled with skim plaster finish. Note All wet areas to use 12.5mm "Gyproc" moisture resistant plasterboard fixed to internal face of wet area walls with all joints taped and filled with skim plaster finish.

Stairs goings - 245mm risers - 190mm.
Stairs Min 1000mm clear width. Handrails 900-1000mm above pitch of stairs & 900 - 1100mm at landings. Handrails to both sides and in the centre and to extend min 300mm beyond first and last riser.

SVP box outs, Timber stud walls with 12.5mm "Gyproc" moisture resistant plasterboard fixed to internal face of wet area walls with all joints taped and filled with skim plaster finish or plasterboard (non wet areas) to one side fixed to manufacturers details, all joints taped filled with skim plaster finish.

Party Walls Between houses Armvic 150 comprising 64+150+64, 60 min Fire Resistance

Timber stud walls with plasterboard to both sides fixed to manufacturers details, all joints taped filled with skim plaster finish. Note All wet areas to use 12.5mm "Gyproc" moisture resistant plasterboard fixed to internal face of wet area walls with all joints taped and filled with skim plaster finish.

Party Walls Between houses Armvic 150 comprising 64+150+64, 60 min Fire Resistance

Timber stud walls with plasterboard to both sides fixed to manufacturers details, all joints taped filled with skim plaster finish. Note All wet areas to use 12.5mm "Gyproc" moisture resistant plasterboard fixed to internal face of wet area walls with all joints taped and filled with skim plaster finish.

Stairs goings - 245mm risers - 190mm.
Stairs Min 1000mm clear width. Handrails 900-1000mm above pitch of stairs & 900 - 1100mm at landings. Handrails to both sides and in the centre and to extend min 300mm beyond first and last riser.

| Rev | Description | Date |
|-------|-------------------------|----------|
| P1-S1 | Issued for Information | 28/11/21 |
| P4-S1 | Amic Build Up | 13/12/21 |
| P9-S1 | Issued for Construction | 14/04/22 |
| | | |
| | | |

| STATUS | PURPOSE OF ISSUE |
|--------|-------------------------|
| P9 | Issued for Construction |

Remcoll Developments

Third Floor,
Broadmeadow Hall,
Applewood, Swords,
Co. Dublin, K67 Y5F2

+353 (1) 813 9754

PROJECT
Milleenoola, Bantry, Co. Cork

TITLE
HT3 - Ground Floor And First Floor Plans

| | | |
|---|----------------------------|------------------------|
| DRAWN BY J. Fernandez | CHECKED BY D. O'Donnell | DATE 14/04/22 |
| SCALE (@ A1) 1 : 50 | | PROJECT NUMBER BT01 |
| DRAWING NUMBER BTY-1-06-H3-ZZZ-DR-RDL-A-1001 | | REV P9-S1 |