

A Georgian Country House set on
about 11.8 acres

Ballyarr House, Ramelton, Co Donegal, F92 H4X8

savills



A Georgian Country House set on about 11.8 acres

Ballyarr House, Ramelton, Co Donegal, F92 H4X8



A Georgian Country House set on about 11.8 acres

Ballyarr House, Ramelton, Co Donegal, F92 H4X8



About this property

Ballyarr House is an elegant late-Georgian country residence of distinction, set on about 11.8 acres of mature parkland on the banks of the River Lennon. Approached by a tree-lined avenue, the property offers exceptional privacy and sweeping views across its own grounds, all while remaining within easy reach of nearby towns.

Architecturally notable for its triple gable-fronted façade, the house has been sensitively restored to celebrate its 18th-century character. Original sash windows with timber shutters, decorative cornicing, and a suite of period marble and slate fireplaces are complemented by seagrass flooring to principal rooms and bespoke radiator cabinetry heritage detail paired with everyday comfort. Modern amenities are discreetly integrated, including oil-fired central heating, solar hot water and two solid-fuel stoves.

The reception hall leads to a gracious, double-aspect drawing room and an impressive study/library, both running the depth of the house to capture natural light and pastoral outlooks. A formal dining room and long conservatory add versatile living and entertaining space, while the kitchen/breakfast room with a Belfast sink, Welsh dressers and glazed doors to the garden. A cloakroom/WC completes the ground floor.

Upstairs, four well-proportioned bedrooms are served by two bathrooms, including a dual-aspect main bathroom with roll-top bath and brassware. A mezzanine landing provides fitted bookshelves, hot press, ironing area and an additional cloakroom/WC with loft access. Beneath the house, a full-footprint cellar which is accessed both internally and externally offers excellent storage and conversion potential (wine cellar, gym, cinema or hobbies), retaining original flooring and refurbished ceilings.

A Georgian Country House set on about 11.8 acres

Ballyarr House, Ramelton, Co Donegal, F92 H4X8



Property Details

Outbuildings

Practical outbuildings include a workshop with adjoining boiler room, a log store, and a modern garage on the lane large enough for two cars and garden machinery. The house is a listed building, with many original features retained.

Gardens and Grounds

The grounds are a defining feature and include sweeping lawns framed by mature trees, a beautiful walled garden enclosed by about 8 foot locally sourced stone and approached through timber double doors. Alongside this is a water meadow that encircles a ring of ancient trees known as the Fairy Fort (referenced in Native Woodlands of County Donegal). Under a Forestry scheme, approx. 5,000 native deciduous trees have been planted, enriching biodiversity and seasonal interest. The holding is bordered by woodland and the River Lennon, with fishing rights enhancing the amenity.



A Georgian Country House set on about 11.8 acres

Ballyarr House, Ramelton, Co Donegal, F92 H4X8

savills



A Georgian Country House set on
about 11.8 acres

Ballyarr House, Ramelton, Co Donegal, F92 H4X8



Plans

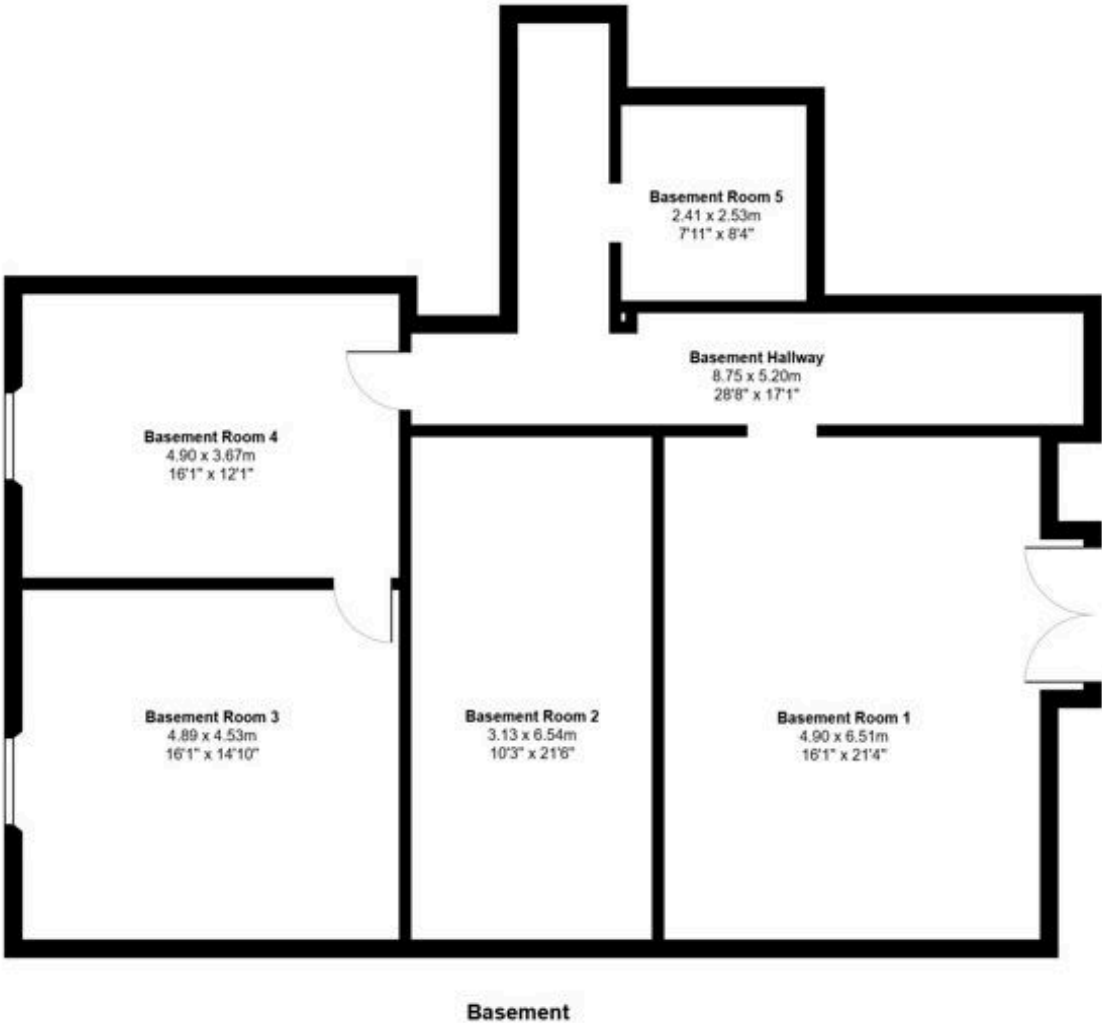

A Georgian Country House set on about 11.8 acres

Ballyarr House, Ramelton, Co Donegal, F92 H4X8

savills



Local Area

Ballyarr House sits just outside Ramelton, a handsome heritage town where the River Lennon meets Lough Swilly, offering rural calm with amenities close by. Ramelton's cafés, weekly country market and riverside walks are about 3 km, while Letterkenny, the county's main centre for retail, schools, sport and healthcare (including Letterkenny University Hospital) is about 10 km distant.



A Georgian Country House set on about 11.8 acres

Ballyarr House, Ramelton, Co Donegal, F92 H4X8



Property Details

Key Features

A Georgian Country House dating from 1780
4 bedrooms and 3 reception rooms
Courtyard with outbuildings
Walled garden
River frontage with fishing rights onto the River Lennon

Services & Additional Information

Oil Fired Central Heating

BER

BER Rating = Exempt

A Georgian Country House set on about 11.8 acres

Ballyarr House, Ramelton, Co Donegal, F92 H4X8



Enquire



Liam McCarthy

Dublin - Country

+353 83 878 4989

liam.mccarthy@savills.ie

More Information



View on website



View Digital Brochure



Property Search

Viewing strictly by appointment

Property Ref: DUY250199

Residential & Country

33 Molesworth Street, D02 CP04

+353 (0) 1 618 1300



Important Notice: Savills, its clients and any joint agents give notice that 1: They are not authorised to make or give any representations or warranties in relation to the property either here or elsewhere, either on their own behalf or on behalf of their client or otherwise. They assume no responsibility for any statement that may be made in these particulars. These particulars do not form part of any offer or contract and must not be relied upon as statements or representations of fact. 2: Any areas, measurements or distances are approximate. The text, photographs and plans are for guidance only and are not necessarily comprehensive. It should not be assumed that the property has all necessary planning, building regulation or other consents and Savills have not tested any services, equipment or facilities. Purchasers must satisfy themselves by inspection or otherwise. *powered by* **FluoPro**