

REA

GRIMES

CGI for illustrative purposes only.



1 X SITE FOR SALE AT SUNDRIVE ROAD WITH FPP
HOUSE TYPE B – 2,410 SQ FT.
AMV €195,000

FOR SALE BY PRIVATE TREATY

Site @ Sundrive Road
Rush
Co Dublin

PSRA No. 001417

BER EXEMPT

EBS

DESCRIPTION

The subject site is located in Rush, Co. Dublin, a small seaside town between Skerries and Lusk on the R128. The area surrounding the site has a mix of residential and commercial properties.

Rush was once viewed as the heart of market gardening in Leinster and many people were employed in agriculture. Nowadays, however, horticulture and agriculture have been superseded by Rush's increasing role as a commuter belt town.

Rush has experienced very steady housing demand over the past 15/20 years. In recent times we have seen an increase in the movement of second hand housing in Rush as there has been very limited and one off new housing being built. Rush is well connected and serviced by public transport by Irish Rail (Rush / Lusk Station - 2. km from the site) and Dublin Bus (bus route 33).

Rush Village is a short distance away from the subject site and provides a wide range of amenities for families including shops, restaurants and a theatre. There is a wide choice of schools in the area and there is no shortage of sporting facilities including Rush Golf Club. One of the main attractions close by is the sandy beach which stretches for miles and provides a ready-made leisure amenity.

FULL PLANNING PERMISSION

Full Planning Permission has been granted for 2 no. dwellings and associated site works, with vehicular access on Sundrive Road respectively. The individual sites will have a typical area of c750-875 sq.m. and the floor area is 2,410sq.ft. Planning reference F16A/0532.

SERVICES

Services will not be provided prior to sale. Connection to existing services on Sundrive Road.

DIRECTIONS

Driving northwards on the M1 take Junction 4. Use the left 2 lanes to take the R132 exit to Skerries/Rush/Donabate. Keep right at the fork and use the left lane to turn right toward R132. Continue on R132 through three roundabouts and then turn right onto Dublin Road/R127. At Dublin Road roundabout take the 3rd exit onto Rathmore Road/R127. At Remount Roundabout take 3rd exit onto Station Road/R128. Follow R128 and turn right onto Healy's Lane. Turn right onto Channel Road. See REA Grimes and Smart Property sign at sites.

FEATURES

- Full Planning Permission for one residential Unit
- Excellent Location
- Located minutes walk from the beach
- Floor Area c.300 sqm
- Easy access of Dublin Airport, M1, M50 and Dublin City Centre
- Planning Permission No. F16A/0532

IMAGES



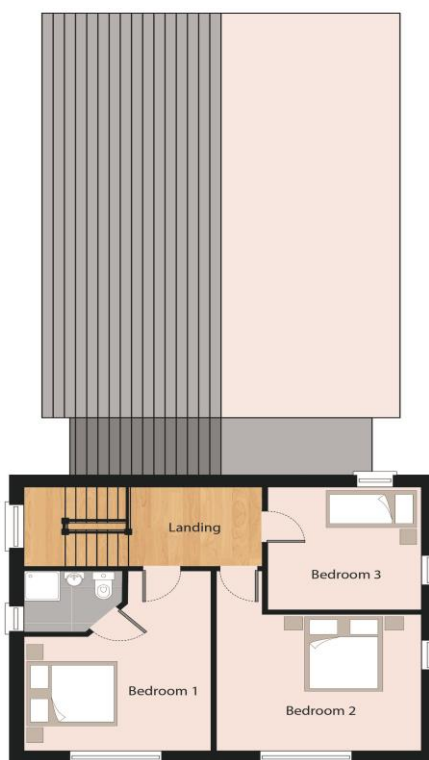

House Type

B

SELLING AGENT

**REA
GRIMES**

CALL NOW
+353 1 849 0129

e. dermot@reagrimes.ie
w. www.reagrimes.ie

Floor plans for illustrative purposes only.

PRICE

AMV €195,000.00

VIEWING

By appointment
Dermot Grimes

Please contact us to arranging a viewing.
We are open from 9 am to 5.30 pm Monday to Friday
and by appointment on Saturdays

THINKING OF SELLING YOUR PROPERTY?

We at REA Grimes, Skerries would be delighted to offer you a free valuation appraisal on your property. We will advise you on value, method of sale and presenting your property to it's highest potential.

99 Strand Street, Skerries, Co Dublin

T: (01) 8490129

M. 087 6478049

E: @reagrimes.ie

MORTGAGE ADVICE:

As tied agents with EBS d.a.c., we're delighted to be able to offer 3% cash back on Mortgages for FTB, Trade up or if you are switching a mortgage loan to us between 1 January 2020 and 31 of December 2020.

2% Back -in-Cash at drawdown means we will pay you 2% of the mortgage loan amount that is drawn down. We will pay this 2% into the current account you use for mortgage repayments within two months of drawdown.

1% Back-in-Cash in year 5 means we will pay you 1% of the mortgage loan amount originally drawn down. We will pay this 1% into the current account you use for mortgage repayments within two months of the 5th year anniversary of the mortgage loan drawdown date.



EBS d.a.c. is regulated by the Central Bank of Ireland.

E: alacoque.daly@mail.ebs.ie

E: robert.grimes@mail.ebs.ie

T: (01) 8490129



REA | REAL ESTATE ALLIANCE.IE

Disclaimer: REA Grimes for themselves and for the Vendors or Lessors of the property whose Agents they are give notice that: (i) The particulars set out as a general guidance of intending purchasers or lessees, and do not constitute part of an offer or contract. (ii) All descriptions, dimensions, references to condition and necessary permissions for use and occupation, and other details are given in good faith and believed to be correct, but any intending Purchaser or Tenants should not rely on them as statements of representations of fact, but must satisfy themselves by inspection or otherwise as to the correctness of each of them. (iii) No persons in the employment of REA GRIMES have the authority to make or give representation or warranty whatever in relation to this property.

