

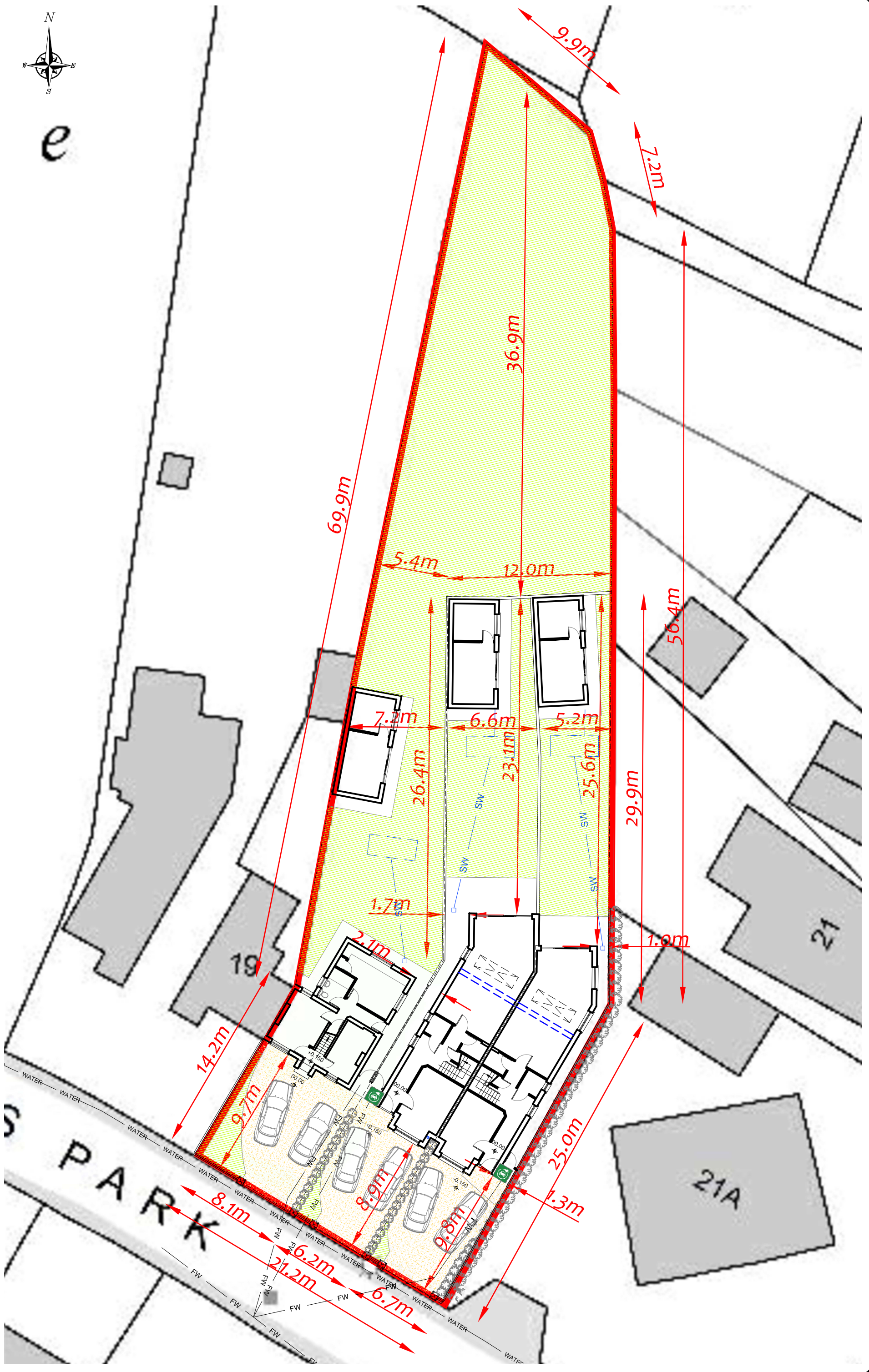

e



DO NOT SCALE FROM THIS DRAWING. USE FIGURED DIMENSIONS ONLY.
COPYRIGHT RORY KISSANE ARCHITECTS
RIAI
2023
ORIGINAL PAPER SIZE:
PLOT DATE:

REVISIONS

PROJECT:	PROPOSED RESIDENTIAL DEVELOPMENT AT 20 ST. PATRICK'S PARK, DUNBOYNE CO. MEATH.
STAGE:	PLANNING ADDITIONAL INFORMATION
DRAWING:	SITE LAYOUT PLAN 1
SCALE:	1:250
DRAWN:	R. KISSANE

SITE:	20 ST. PATRICK'S PARK, DUNBOYNE, CO. MEATH.
CLIENT:	RDS INVESTMENTS LTD.
PROJECT NO.:	2315
DATE:	JAN. '24
DRAWING NO.:	PDO2A

RORY KISSANE ARCHITECTS
1, OLD FAIR GREEN,
DUNBOYNE, CO. MEATH.
TEL: 087 419 0 500 E-MAIL: RORY@RKBANK.IE
WEB: RKBANK.IE