

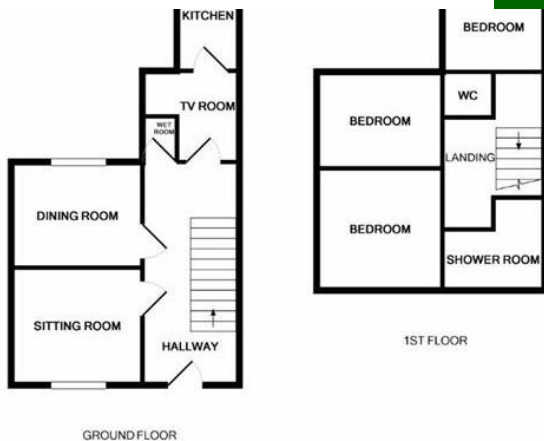

Bella Vista, Laurel Hill Avenue, South Circular Road, Limerick



Guide Price
€250,000



GVM Auctioneers are delighted to offer for sale by private treaty " Bella Vista", Laurel Hill Avenue, South Circular Road. Bella Vista offers a potential purchaser a rare opportunity to acquire a property in this prime residential located within walking distance of the City Centre and also in very close proximity to Mary Immaculate College, The Limetree Theatre and an array of educational and sporting amenities. Ideal for those in search of an investment opportunity, owner occupier or DIY enthusiast. While this property requires refurbishment, the location is truly superb. There are also adjoining properties for sale and accordingly a potential overall development site could be assembled. Proven rental location.

Full details contact Norma Murphy on 087-6529916

Rooms:

Hallway

2.18m (7'2") x 0.51m (1'8")

Sitting Room

1.57m (5'2") x 1.45m (4'9")

Dining Room

1.32m (4'4") x 1.22m (4'0")

Utility Room

TV Room

1.07m (3'6") x 0.99m (3'3")

Kitchen

1.12m (3'8") x 0.43m (1'5")

<

Bedroom 1

1.63m (5'4") x 1.37m (4'6")

Bedroom 2

1.35m (4'5") x 1.27m (4'2")

Shower Room

Bedroom 3

1.04m (3'5") x 0.94m (3'1")

Features:

- Wonderful location
- Next to Mary Immaculate College
- Great potential to develop a state of the art home
- Possible overall development site
- Spacious internally

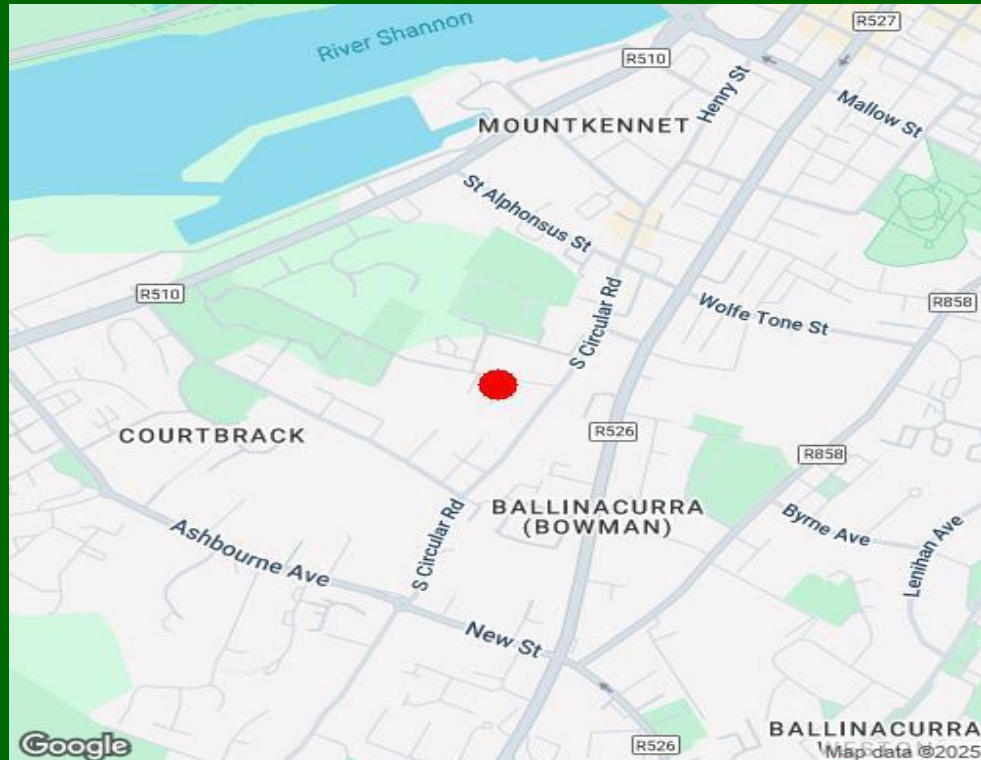

Property Directions:

This property is located at Laurel Hill Avenue to the side and rear of the Redemptorists Church. Proceed down South Circular road toward City centre. Turn left at Laurel Hill Avenue just before Church. This property is located on the left hand side. GVM sign thereon.

Agent Information:

Contact Norma Muphy Mobile :- 087-6529916

Email :- normamurphy@gvm.ie

Disclaimer

These particulars do not form any contract and are for guidance purposes only. Computer generated images, maps and plans are not drawn to scale and measurements are approximate and for guidance only. Intending purchasers must satisfy themselves as to the accuracy of detail given to them verbally or as part of this brochure. Such information is given in good faith and believed to be correct. However neither the vendor nor their agents shall be held liable for any inaccuracies therein.

Limerick Office

25-26 Glentworth St,
Co. Limerick,
V94WE12

Phone: (061)413522

Email: limerick@gvm.ie

Kilmallock Office

Head Office,
Railway Road,
Kilmallock,
Co. Limerick

Phone: (063)98555

Email:
kilmallock@gvm.ie

Tullamore Office

GVM Mart,
Arden Road,
Tullamore,
Co. Offaly

Phone: (057)9321196

Email:
tullamoreproperty@gvm.ie

