

For Sale

Asking Price: €200,000



Sea View, Adrigole,
Co. Cork, P75 V621.



sherryfitz.ie



Coastal, detached 3 bedroom traditional farmhouse, set on 1 acre approx., of mature landscaped grounds overlooking Adrigole Harbour and enjoying a prime Beara Peninsula location along the West Cork segment of the Wild Atlantic Way.

The house is a stone-built and slated building that requires restoration. The accommodation includes kitchen/dining room, sitting room and 3 bedrooms upstairs.

We expect that this property will qualify for the Vacant Property Refurbishment Grant.

The property enjoys an immensely private location. The 1 acre approx. of mature grounds contains mature specimen trees and shrubs. There are also 2 stone outhouses located on the property.

Sea View is located adjacent to the near-by waterfront while being just 15 minute drive from both Castletownbere and Glengarriff. The Beara Peninsula is renowned for its walking trails along the Wild Atlantic Way that take in many historical and archaeological sites.



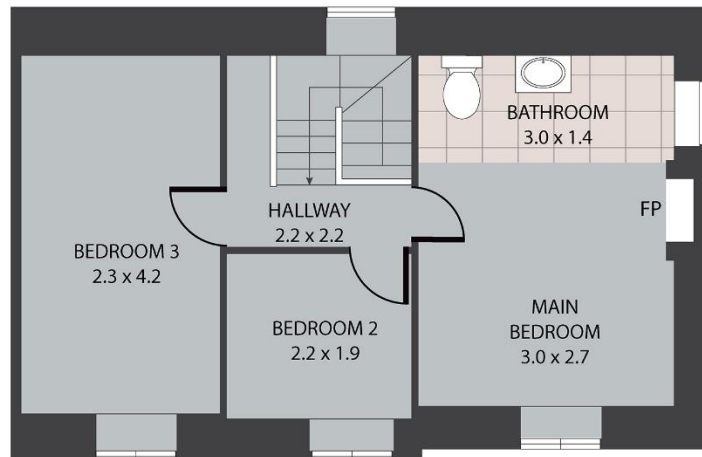

FIRST FLOOR

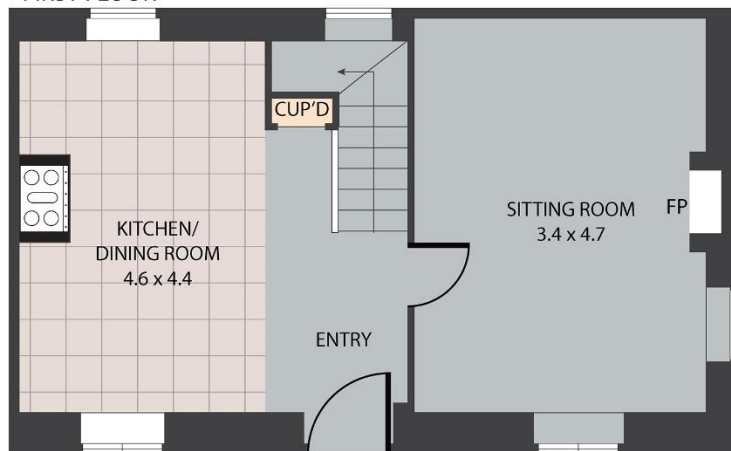

GROUND FLOOR

Sea View, Adrigole P75 V621
 TOTAL APPROX. FLOOR AREA 73 SQ.M
 Whilst every attempt has been made to ensure the accuracy of the floor plan contained here, measurements of doors, windows, rooms and any other items are approximate and no responsibility is taken for any error, omission, or misstatement. This plan is for illustrative purposes only and should be used as such by any prospective purchaser.



**Sherry
FitzGerald**
O'Neill

NEGOTIATOR

Olivia Hanafin
Sherry FitzGerald O'Neill
Wolfe Tone Square, Bantry,
Co Cork
T: 027 31030
E: info@sfoneill.ie

VIEWING

Strictly By Appointment Only

ENERGY RATING

BER: G
Cert No.: 106870538
EPI: 1244.94 kWh/m²/yr

sherryfitz.ie
sfoneill.ie
myhome.ie
daft.ie

CONDITIONS TO BE NOTED: A full copy of our general brochure conditions can be viewed on our website at <http://www.sherryfitz.ie/terms>, or can be requested from your local Sherry FitzGerald office. We strongly recommend that you familiarise yourself with these general conditions. While care has been taken to ensure that information contained in Sherry FitzGerald publications is correct at the time of publication, changes in circumstances after the time of publication may impact on the accuracy of this. PSRA Registration No. 004158