

Project: NEW STOREY & A HALF STYLE DWELLING
 HOUSE ON SITES 12, 13, 14 & 15 "THE VILLAGE GREEN"

Client: BOYLE HOMES & DEVELOPMENTS LTD.

Title: SITE LAYOUT PLAN

Scale: 1:500 **Date:** JUNE 2018 **Dwg.no.** 18008/11

Address: Curraheen, Tralee, Co. Kerry, Fax/Phone 066-7127578

Email Address: kadmant@eircom.net

NOTE:
 THIS DRAWING WAS PREPARED FOR THE PURPOSE OF MAKING
 A PLANNING APPLICATION ONLY. IT DOES NOT PERTAIN TO SHOW
 ALL STRUCTURAL INFORMATION NECESSARY TO CONSTRUCT
 OR PRICE THE BUILDING. IT DOES NOT PERTAIN TO SHOW ALL
 INFORMATION REQUIRED FOR COMPLIANCE WITH BUILDING
 REGULATIONS. ALL STRUCTURAL INFORMATION REQUIRED FOR
 THE CONSTRUCTION OF THIS BUILDING MUST BE AGREED WITH
 A STRUCTURAL ENGINEER PRIOR TO COMMENCEMENT ON SITE.



Green Amenity Area

LOCATION OF SITE NOTICE 2

Site Layout Plan 1:500

LOCATION OF SITE NOTICE 1

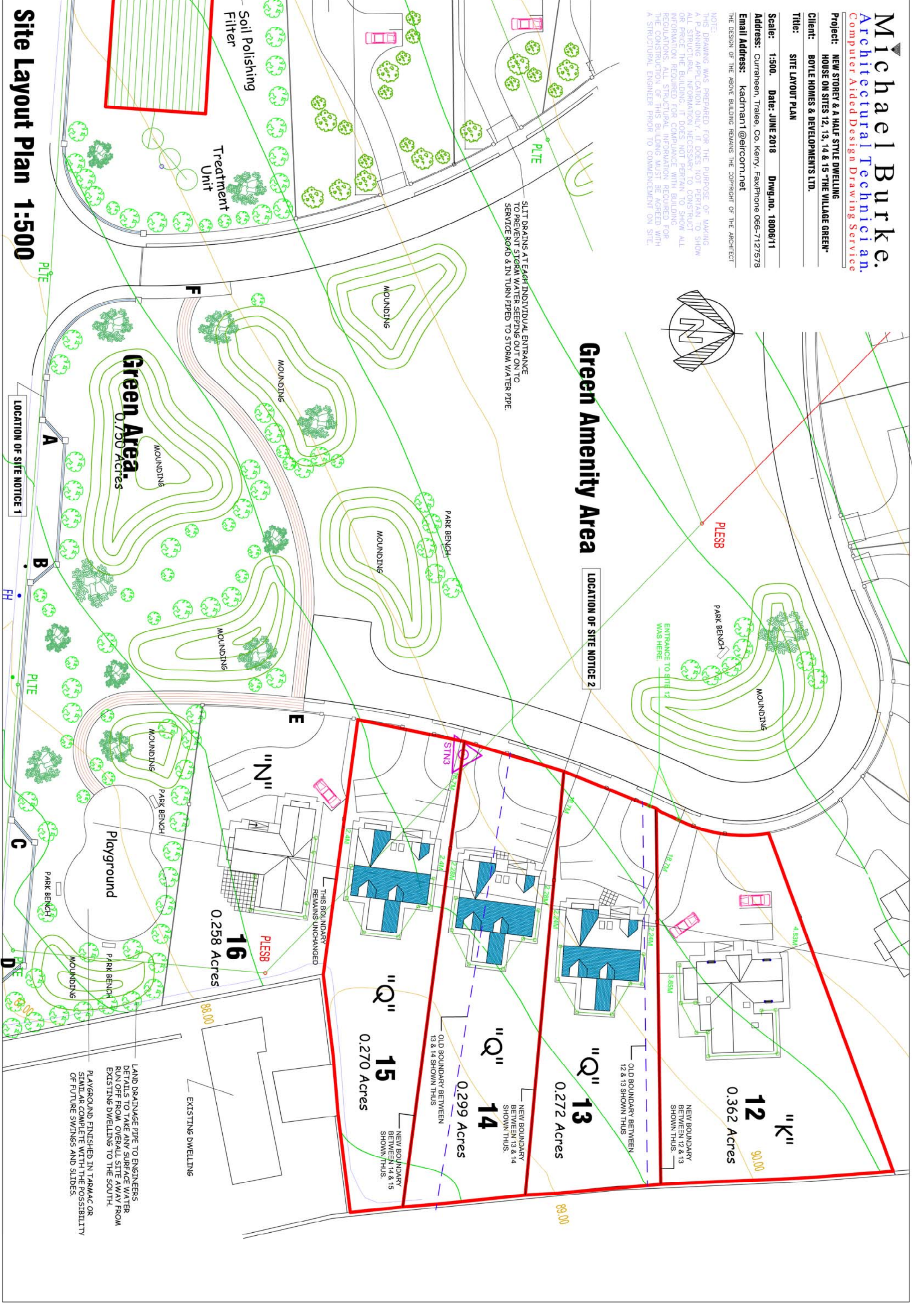

LAND DRAINAGE PIPE TO ENGINEERS
 DETAILS TO TAKE ANY SURFACE WATER
 RUN OFF FROM OVERALL SITE AWAY FROM
 EXISTING DWELLINGS TO THE SOUTH.
 PLAYGROUND FINISHED IN TARMAC OR
 SIMILAR COMPLETE WITH THE POSSIBILITY
 OF FUTURE SWINGS AND SLIDES.

THIS BOUNDARY
 REMAINS UNCHANGED

OLD BOUNDARY BETWEEN
 12 & 13 SHOWN THUS

NEW BOUNDARY
 BETWEEN 13 & 14
 SHOWN THUS.

OLD BOUNDARY BETWEEN
 13 & 14 SHOWN THUS

NEW BOUNDARY
 BETWEEN 14 & 15
 SHOWN THUS.