

**FOR SALE BY PUBLIC AUCTION
THURSDAY 23RD AUGUST 2018 AT 4PM
IN THE BRIDGE HOUSE, ATHLEAGUE F42 RR71**

Prime Residential Farm Comprising

c.126.40 Acres (c.51.15 Hectares)

Excellent Quality Lands Located at

Corramore or Gorteenclough

Athleague

Co. Roscommon F42 VX39

PRICE REGION: OPEN TO OFFERS

Property Reference: M2046



For further details and viewing contact JOINT SELLING AGENTS



www.moranandco.ie

Tel: 090-6624531

PSRA Licence: 001472



www.connaughtonauctioneers.ie

Tel: 090-6663700

PSRA Licence: 001350

Solicitor for the carriage of sale: Billy Brandon at Patrick J. Neilan Solicitors, Roscommon Town. Tel: 090-6626245

LOT 1

**Entire Property – Residence and Outbuildings on
c.126.40 Acres (c.51.51 Hectares)**

LOT 2

BER F

Three Bedroom Residence and Outbuildings on c.1.24 Acres (c.0.50 Hectares)



- **Primely located residence located close to Athleague Village**
- **Standing on c. 1.24 Acres with own water and electricity supplies**
- **In need of minor renovation/modernisation**
- **Comprises Reception Hallway 8' x 6', Sitting room 15' x 15', Kitchen 15' x 13'10", Dining Room 12' x 10', Bathroom 10' x 7', and three Bedrooms (11' x 10', 10' x 10' and 11' x 10')**
- **Viewing comes highly recommended**



LOT 3

c.85.30 Acres (c.34.52 Hectares) of Excellent Quality Lands with Derelict Residence Fronting onto River Suck



LOT 4

c. 24.70 Acres (c.10 Hectares) of Excellent Quality Lands Fronting onto River Suck with Extensive Road Frontage



LOT 5
c. 15.16 Acres (c. 6.14 Hectares) of Lands
Located at end of Country Lane and Fronting onto River Suck

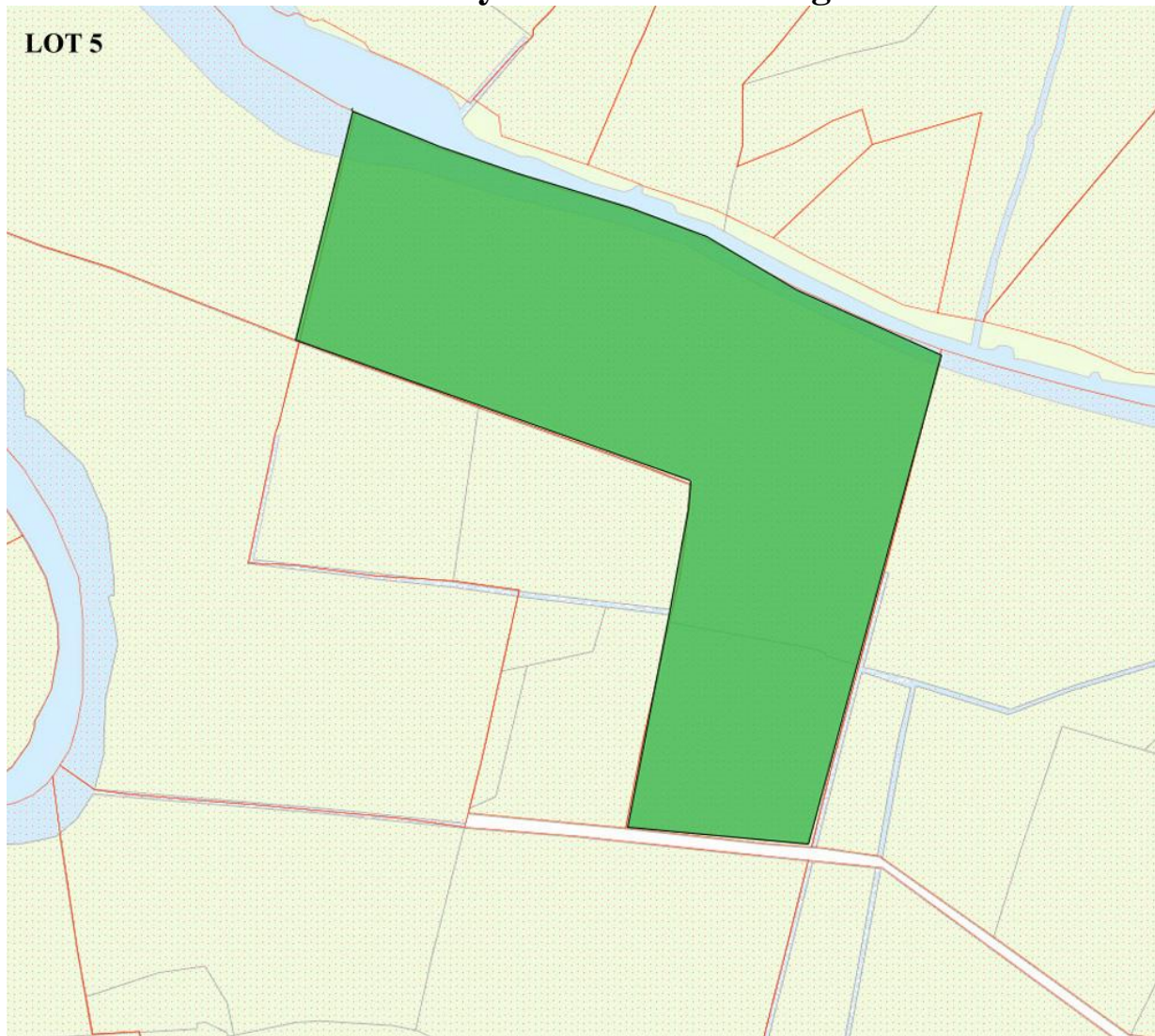

The JOINT SELLING AGENTS invite enquiries and offers for the entire property and individual lots.



www.moranandco.ie
Tel: 090-6624531



www.connaughtonauctioneers.ie
Tel: 090-6663700

Solicitor for the carriage of sale: Billy Brandon at Patrick J. Neilan Solicitors, Roscommon Town. Tel: 090-6626245