





## Two Bedroom Ground Floor Apartment

52 Beechdale Court, Ballycullen, Dublin 24



76.67 sq.m

 (045) 865 568

 [www.jpmdoyle.ie](http://www.jpmdoyle.ie)

## For Sale by Private Treaty

### LOCATION:

Situated on the foothills of the Dublin mountains, the property is within walking distance of schools, shops and numerous local amenities including Lidl Ballycullen, The Hell Fire Club, Ballycragh Park, St. Anne's GAA and The Park Community Centre. Public Transport is plentiful including Dublin bus 15, 15B, 49, 65B, 175 and the M50 is a short distance away, providing easy access to Dublin City Centre and surrounding areas.

**Dundrum:** c. 5.8 miles/9.4 km. **Tallaght:** c. 2.4 miles/4 km. **Dublin City Centre:** c. 7.7 miles/12.5 km.

### DESCRIPTION:

52 Beechdale Court is a contemporary 2 Bedroom ground floor apartment, located in the highly sought after Ballycullen area. Presented in excellent condition throughout, the accommodation comprises of an entrance porch with storage, spacious open plan living/ dining room, fully fitted kitchen, inner hallway with family bathroom, storage presses, two double bedrooms with master en-suite. There is generous parking to the front and the landscaped communal gardens to the rear enjoy a sunny orientation.

### ACCOMMODATION:

#### **Entrance Hall**

Tiled floor, ceiling coving, alarm.

#### **Living Room**

Light filled room with timber flooring, ceiling coving, recessed lighting and television point.

#### **Kitchen**

Tiled Floor, recessed lighting, fitted floor and wall units, partially tiled walls, Zanussi four plate hob, Beko oven, Extractor fan, Beko washing machine and Bosch dishwasher.



<b>Hallway</b>	Timber flooring, hot-press and shelved ceiling room.
<b>Bedroom 1</b>	Double room with timber flooring, storage and television point.
<b>Ensuite</b>	Tiled Floor, step in shower, whb, wc, shelving, wall mounted mirror and light.
<b>Bedroom 2</b>	Spacious Double room with timber flooring, Storage, spot lighting, television point and sliding double doors to covered patio area and garden.
<b>Family Bathroom</b>	Tiled Floor, partially tiled walls, bath with Triton T80si Shower, WC, WHB, vanity unit and storage.
<b>Outside</b>	Parking and landscaped planting to the front. Private patio area and communal garden to the rear.





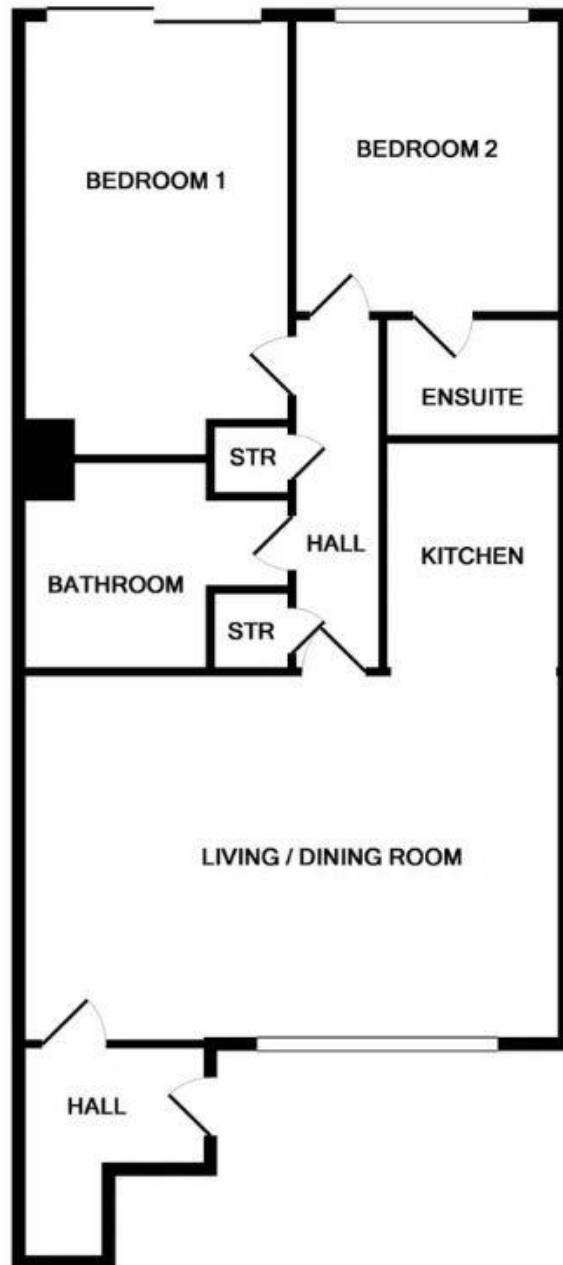

**VIEWING:** BY APPOINTMENT ONLY

**BER:** C1

**PRICE REGION:** €295,000



JP&M  
**DOYLE**

Established. 1952

**Main Street, Blessington, Co. Wicklow, W91 RK28.**

t: (045) 865568

f: (045) 891425

e: [blessington@jpmdoyle.ie](mailto:blessington@jpmdoyle.ie)

PSRA Licence: 002264

J.P. & M. Doyle Ltd., for themselves and for the vendors of this property whose agents they are, give notice that:

- (1) the particulars are set out as a general outline for the guidance of intending purchasers and do not constitute part of an offer or contract.
- (2) all description, dimensions, references to condition and necessary permission of use and occupation, and other details are given in good faith and are believed to be correct, but any intending purchasers or tenants should not rely on them as statements or representations of fact but must satisfy themselves by inspection or otherwise as to the correctness of each of them.
- (3) no person in the employment of J.P. & M. Doyle Ltd. has any authority to make or give any representations or warranty whatever in relation to the property.