

# A striking home overlooking Blacksod Bay offering panoramic sea views

An Fál Mór, Blacksod, Ballina, Co. Mayo, F26W6T3

savills





# A striking home overlooking Blacksod Bay offering panoramic sea views

An Fál Mór, Blacksod, Ballina, Co. Mayo, F26W6T3



# A striking home overlooking Blacksod Bay offering panoramic sea views

An Fál Mór, Blacksod, Ballina, Co. Mayo, F26W6T3



## About this property

An Fál Mór is an exceptional modern residence completed in 2021 which offers bright, spacious, and energy-efficient living in a most stunning setting overlooking Blacksod Bay.

Approached via a graveled drive behind traditional stone walls and electric gates, the property blends heritage charm with modern design. The centerpiece of the home is the expansive open-plan kitchen / sitting room featuring vaulted ceilings, picture windows, and a wood-burning stove. With full-height glazing facing southwards, this room is flooded with natural light and captures sweeping views over the Atlantic Ocean across to Achill Island.

The high-spec kitchen includes a large island, integrated appliances, and custom cabinetry. A utility room is located just off the kitchen.

The welcoming hall / dining room acts as the heart of the home, with a fireplace and generous proportions, creating a natural flow between the living areas and bedrooms.

There are four ensuite bedrooms in total, each with a walk-in wardrobe or dressing room, offering space, privacy, and comfort for family or guests. The master bedroom features a large dressing room and an elegant ensuite. The layout is completed by a family bathroom and guest

WC, all presented with contemporary finishes.

The property extends to about 2,890 sq ft / 268 sq m in total, as shown on the accompanying floorplans.

### Outbuildings

A detached double garage provides secure parking or additional storage.

### Gardens & Grounds

The landscaped site extends to approximately 0.57 acre / 0.23 hectare, with manicured lawns, a sheltered patio terrace, and uninterrupted views across the Atlantic which is perfect for al fresco dining and appreciating the ever-changing landscape. The home's south-facing orientation maximises natural light and enhances the year-round enjoyment of its coastal surroundings.



# A striking home overlooking Blacksod Bay offering panoramic sea views

An Fál Mór, Blacksod, Ballina, Co. Mayo, F26W6T3

savills



# A striking home overlooking Blacksod Bay offering panoramic sea views

An Fál Mór, Blacksod, Ballina, Co. Mayo, F26W6T3



## Plans

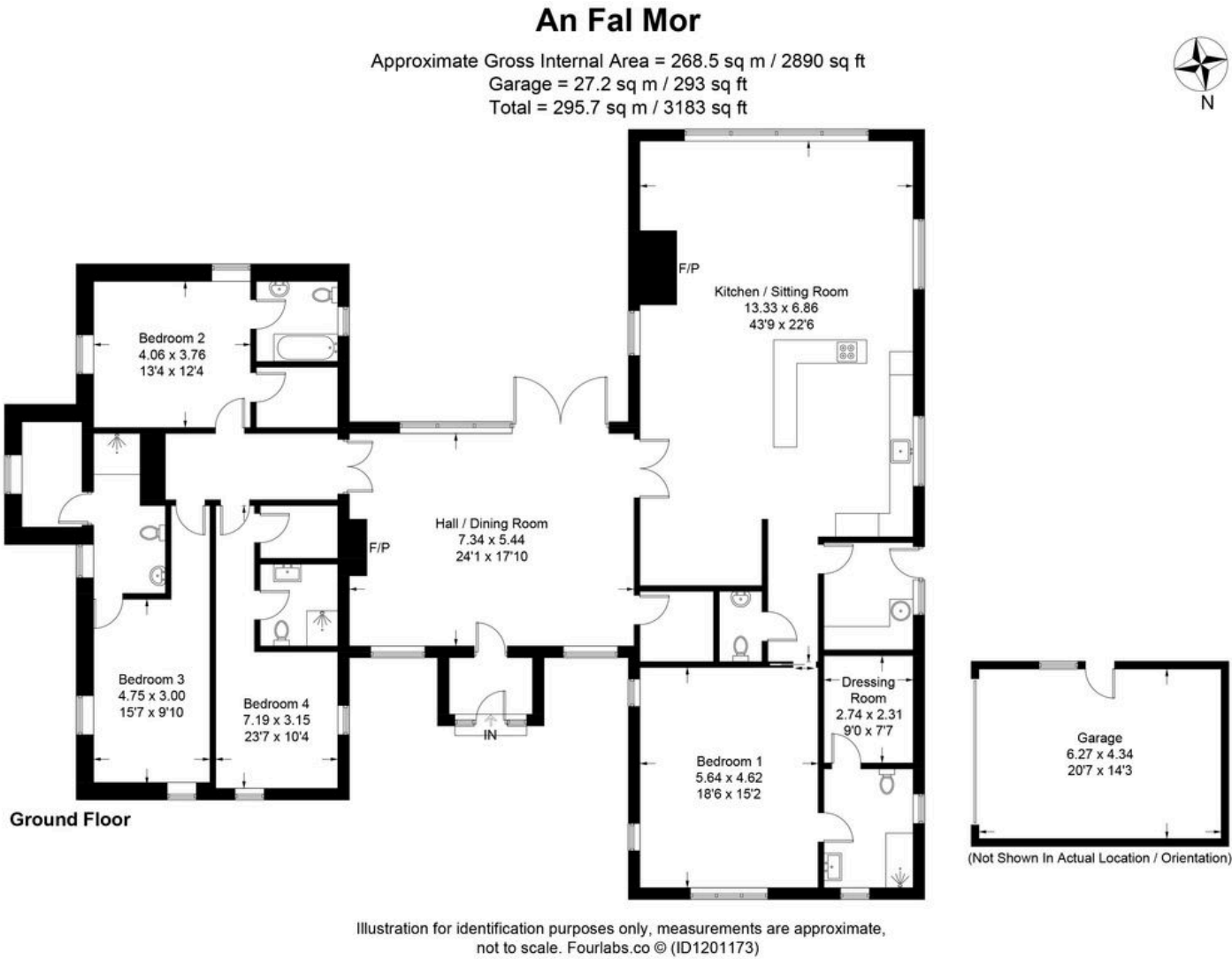



# A striking home overlooking Blacksod Bay offering panoramic sea views

An Fál Mór, Blacksod, Ballina, Co. Mayo, F26W6T3

savills

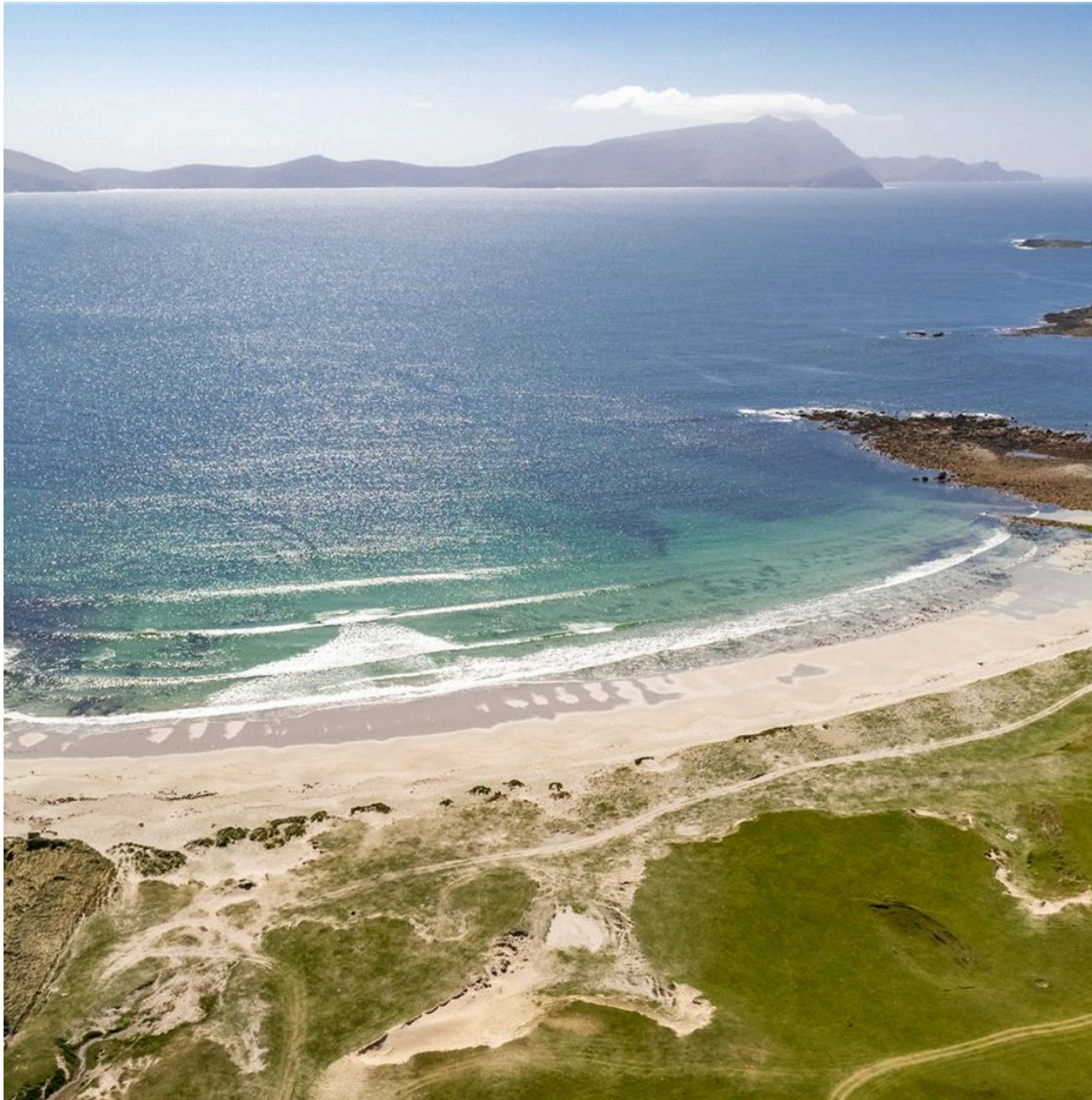

## Local Area

An Fál Mór is located on the Blacksod Peninsula of Mayo with magnificent, far-reaching views across to Achill Island and the Slievemore mountains. The Blacksod Peninsula is renowned for its long sandy beaches and rugged unspoilt coastlines. The village of Eachliem located 2.5km distant, also houses an award-winning Heritage Centre with a restaurant and a pub. The village of Blacksod enjoys an extensive docking facility and the famous Blacksod Lighthouse constructed in the 1860's and the source of the legendary "D-Day Weather Forecast".



## A striking home overlooking Blacksod Bay offering panoramic sea views

An Fál Mór, Blacksod, Ballina, Co. Mayo, F26W6T3



## Property Details

## Key Features

Contemporary home with 4 ensuite bedrooms

Stunning open-plan living space with vaulted ceilings and ocean views

South-facing orientation with views  
toward Achill Island and the Atlantic  
Landscaped grounds

### Walking distance to Faulmore Beach

## Services & Additional Information

## Oil fired central heating

## Solid fuel fireplaces

## BER

BER Rating = B3

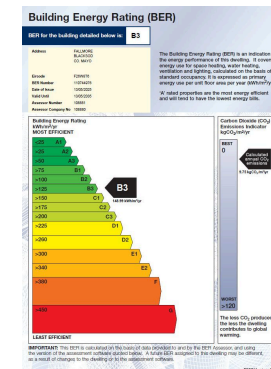



# A striking home overlooking Blacksod Bay offering panoramic sea views

An Fál Mór, Blacksod, Ballina, Co. Mayo, F26W6T3



## Enquire



**Liam McCarthy**  
Dublin - Country  
+353 83 878 4989  
liam.mccarthy@savills.ie

## More Information



[View on website](#)



[View Digital Brochure](#)



[Property Search](#)

**Viewing strictly by appointment**

Property Ref: DUY240219



Important Notice: Savills, its clients and any joint agents give notice that 1: They are not authorised to make or give any representations or warranties in relation to the property either here or elsewhere, either on their own behalf or on behalf of their client or otherwise. They assume no responsibility for any statement that may be made in these particulars. These particulars do not form part of any offer or contract and must not be relied upon as statements or representations of fact. 2: Any areas, measurements or distances are approximate. The text, photographs and plans are for guidance only and are not necessarily comprehensive. It should not be assumed that the property has all necessary planning, building regulation or other consents and Savills have not tested any services, equipment or facilities. Purchasers must satisfy themselves by inspection or otherwise. *powered by* **FluoPro**