

THIS DRAWING IS COPYRIGHT

All works to be in accordance with current Building Regulations and Codes. Contractors and Subcontractors are responsible for ensuring compliance with Building Regulations within their trade. Where this drawing is open to public inspection pursuant to a statutory requirement, or is a statutory register, copying is subject to the requirements of Section 74 of the Copyright and Related Right Act, 2000

Key Plan

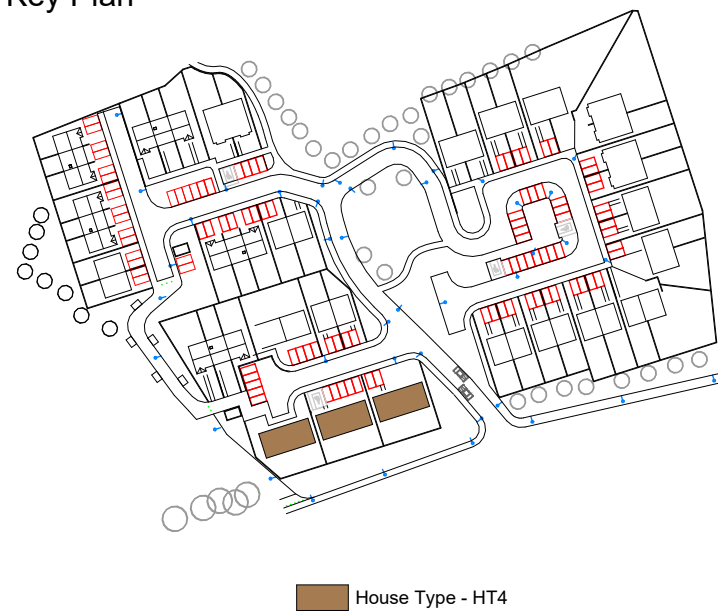

GENERAL NOTES

THIS DRAWING TO BE READ IN CONJUNCTION WITH CONSTRUCTION DETAILS AND DRAWINGS & DOCUMENTATION PREPARED BY THE CIVIL / STRUCTURAL AND MECHANICAL / ELECTRICAL ENGINEER'S
Refer to sheet BTY-1-06-SW-ZZZ-DR-RDL-A-1000 for general specification notes

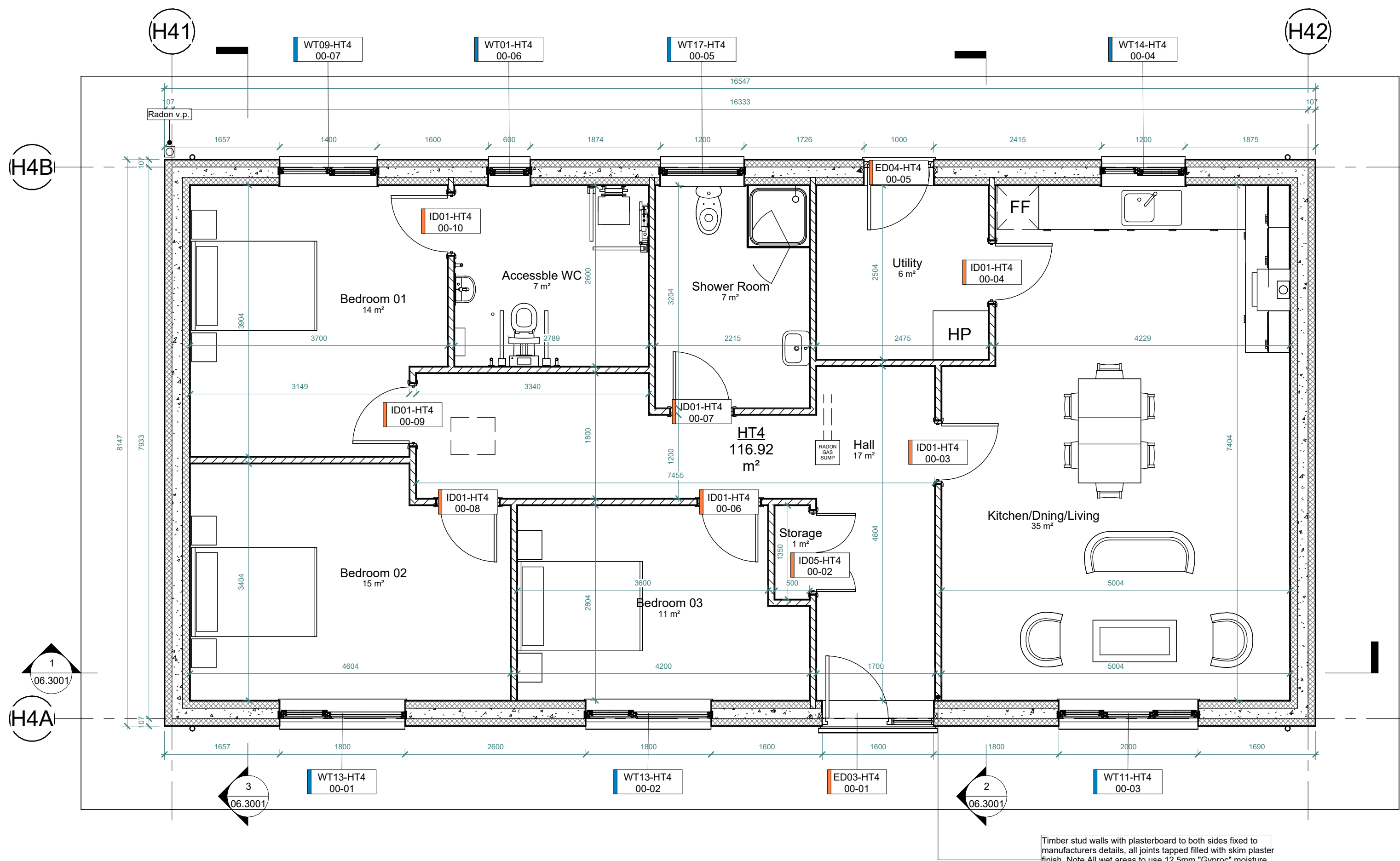

1 L00 - Ground Floor
1 : 50

Rev	Description	Date
P1-S1	Issued for Information	28.11.21
P4-S1	Amic Build Up	13/12/21
P9-S1	Issued for Construction	14/04/22

STATUS P9		PURPOSE OF ISSUE Issued for Construction	
Remcoll Developments			
Third Floor, Broadmeadow Hall, Applewood, Swords, Co. Dublin, K67 Y5F2			
+353 (1) 813 9754			
PROJECT Milleencoola, Bantry, Co. Cork			
TITLE HT4 - Ground Floor Plan			
DRAWN BY J. Fernandez		CHECKED BY D. O'Donnell	DATE 14/04/22
SCALE (@ A1) 1 : 50		PROJECT NUMBER BT01	
DRAWING NUMBER BTY-1-06-H4-ZZZ-DR-RDL-A-1001			REV P9-S1